

The Village at Orange

Orange, California



Real life, real shopping...

THE VILLAGE
A T O R A N G E

Key Retailers

JCPenney
Sears
Walmart
Old Navy
Ross Dress for Less
Sprouts Farmers Market

Contact Information

Howard S. Wong, SCLS
Director of Retail Leasing

The Village at Orange
1500 East Village Way, Suite 2298
Orange, California 92865

tel 949.263.7962
fax 949.442.2460
hwong@passco.net

Patrick Furlong, CSM, CPM
Sr. General Manager

The Village at Orange
1500 East Village Way, Suite 2298
Orange, California 92865

tel 714.998.1521
fax 714.998.6378
pfurlong@passco.net

The Village at a Glance

- The center completed a \$57 million renovation to create a vibrant lifestyle center with 84 stores and eateries.
- The average household income is \$90,037 within a five-mile trade area.
- The culturally diverse trade area features above-average population growth, healthy employment trends, high education levels, and a median residential home value of \$432,581.
- A densely populated trade area with over 1.7 million people residing within a ten-mile radius.
- Mini Anchors include: Cost Plus World Market, Old Navy, Ross Dress for Less and Sprouts Farmers Market.
- With restaurants such as Chipotle Mexican Grill, Famous Dave's BBQ, Red Robin, Panera Bread, Rubio's, Todai, Oggi's Pizza & Brewery and Olive Garden, the center has become the dining experience for the surrounding community of Orange.
- The Village at Orange attracts approximately 4 million visitors per year.
- Conveniently located near exits for three major Orange County highways.
- The Village at Orange is centrally located in a main retail hub with major retailers including: Best Buy, Target, Home Depot, Staples and Big 5 Sporting Goods.

www.thevillageatorange.com

Site Plan

The Village at Orange

Orange, California

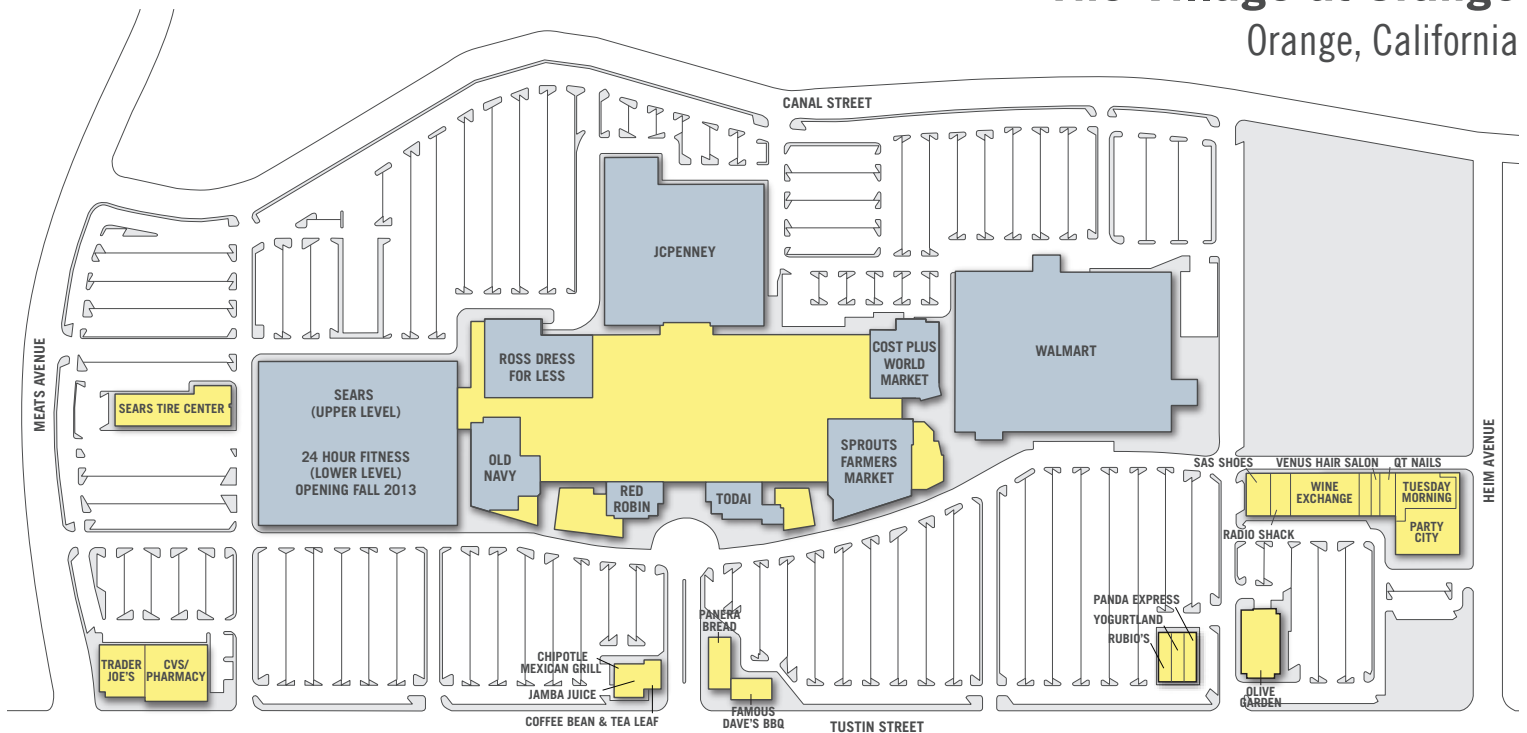

Real life, real shopping...

THE VILLAGE
A T O R A N G E

Statistics & Demographics

Property Data	
Opening Date	1971
Renovation Dates	1997, 2003-2004
Site	61.21 acres
Parking	4,217 spaces
Total Stores	84
Levels	1
Leasable Area	
Total Mall GLA	855,761 s.f.
Mall Shops	244,880 s.f.
Outparcels	81,259 s.f.
Anchor (Total)	529,622 s.f.
Sears	280,000 s.f.
JCPenney	102,020 s.f.
Walmart	147,602 s.f.
Trade Area	
5-Mile Radius	
Population	467,873
Total Households	144,757
Avg. Household Income	\$90,037
Median Age	34.5 yrs.
Source: Nielsen 2013.	04/15/13

Location Map

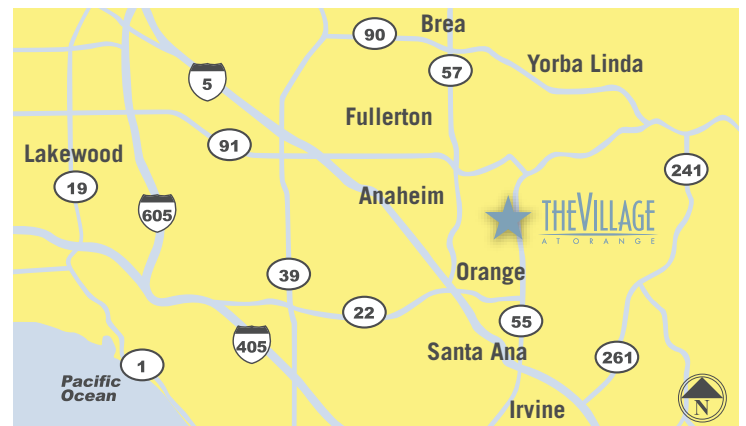

THE VILLAGE
A T O R A N G E

1500 East Village Way, Suite 2298
Orange, California 92865

tel 714.988.1521
fax 714.998.6378

www.thevillageatorange.com

