

Since 1959

2006

KODIAK

by Skamper

ULTRA-LITE EXPANDABLES AND TRAVEL TRAILERS



Take Life to the Extreme!



INDUSTRY LEADING ULTRA-LITE TECHNOLOGY



**Kodiak 235 in
Foliage**

A feeling of home starts in the kitchen. Residential accents like raised panel upper cabinet doors, tasteful designer décors, spacious double-bowl stainless steel sink with high-rise faucet, 3-burner range with optional oven, large storage areas and tons of countertop space make Kodiak your best value.



ULTRA-LITE EXPANDABLES

**9 floor plans starting at 2608 lbs,
loaded with standard features.**

For active families on the go, Kodiak Expandables add sleeping space without the additional length and weight of traditional travel trailers. The ultra-lite design and aerodynamic profile make Kodiak a dream to tow. Plus, the interior of Kodiak is packed with high-end features, including designer décor, large kitchens with abundant storage, expansive living spaces and comfortable sleeping areas. So, when it is time for your next travel trailer, choose Kodiak, your best value in ultra-lite expandable travel trailers.



INDUSTRY LEADING ULTRA-LITE TECHNOLOGY

EXCLUSIVELY KODIAK



Cavlar 2000 Tents

Kodiak Expandables are built exclusively with premium Cavlar 2000, the best vinyl tent in the industry. Cavlar

2000 is a 15 ounce vinyl fabric that resists mold and mildew and wicks away condensation. Plus, Cavlar 2000 is made with UV protector that prevents damage and fading from the sun.

SELF-SUPPORTING BUNK ENDS

Kodiak Expandable's comfortable 60" x 80" queen bed bunk ends include a 5" thick mattress, zippered room darkening shades and a privacy curtain. A bunk end light and fan are available as an option.



Key-Locking Bunk End Doors

Key-locking "Easy Latch" tent doors eliminate the use of unsecured, crank-style door hardware. Simply unlock the tent door, push the release button, open the cam arm and drop the door into the open position.



Self-Supporting Bunk Ends

Kodiak Expandable's bunk ends are self-supporting. This revolutionary system suspends the 60" x 80" queen bed from the wall of the trailer. Kodiak does not require exterior tent poles to support the bunk ends. Plus, each bed has a 1200 lb. capacity, the highest capacity in the industry!

PREMIUM INTERIOR DESIGN

The interior of the 2006 Kodiak Expandable is our best looking ever. The designer décors with luxurious fabrics, raised panel upper cabinet doors, and residential vinyl flooring make Kodiak Expandables your best choice when it comes to expandable travel trailers.



Heated Bunk Mattress

Optional heated bunk mattresses are available on Kodiak to help keep you warm on those chilly nights.



Kodiak 235 in Foliage

BEST FEATURES BEST OPTIONS

Pac-n-Play Storage

Choose the Pac-n-Play option on floor-plans with bunks to maximize your exterior storage. It's large enough to store bikes, golf clubs, coolers and more.



Bike Carrier

The optional easy-to-use bike carrier mounts on the travel trailers "A-frame." It securely holds 3 adult or children's bicycles.



Spray Away Wash Station

Both Kodiak Expandables and Travel Trailers are available with the optional spray away wash station, featuring hot and cold water and a retractable, quick disconnect hose with sprayer.

Industry Exclusive!

Kodiak features AudioLITE™ exterior speakers by Intier.® AudioLITE speakers provide crisp, undistorted sound. Plus, they are impact resistant and waterproof. (optional)



Outdoor LP Grill

Take your cooking outside with the exterior barbecue grill available on Kodiak Expandables and Travel Trailers. (optional)



Audiovox™ 2-Way Radios

Audiovox optional 2-way radio system includes four radios and a 12V charger base station. (optional)



DECOR OPTIONS



Bluestone



Foliage



Spice

EXPANDABLES	160	17FL	195	214	215	23TT	235	236	23BH
*Axle Weight	2451	2286	2899	3297	3001	3497	3269	3413	3401
*Dry Hitch Weight	221	321	231	351	299	513	345	315	461
*Unloaded Vehicle Weight	2672	2608	3130	3648	3300	4110	3614	3728	3862
GVWR	3850	3850	4840	4840	4840	6000	4840	4840	4840
Net Cargo Capacity	1178	1242	1710	1192	1540	1890	1226	1112	978
Exterior Length (closed)	17'2"	17'5"	20'8"	24'4"	22'8"	26'4"	24'4"	24'4"	26'4"
Exterior Height with A/C	9'4"	9'4"	9'4"	9'4"	9'4"	9'4"	9'4"	9'4"	9'4"
Exterior Width	8'	8'	8'	8'	8'	8'	8'	8'	8'
Fresh Water Capacity	46	46	46	46	46	46	46	46	46
Gray Water Capacity	34	34	34	34	34	34	34	34	34
Black Water Capacity	22	22	22	22	22	32	22	22	22
Furnace Size (BTUs)	19,000	19,000	19,000	19,000	19,000	19,000	19,000	19,000	19,000

Tire Size (all models): ST205/75D14(C) Interior Height (all Kodiak models): 6'4"

*Axle weight, dry hitch weight and unloaded vehicle weight (UVW) are base weights of units without options. Each unit includes a weight label which lists specific weight information for that unit. Vehicle Loading – Every effort has been made to provide the greatest number of options for the recreation vehicle owner. Along with these choices comes the responsibility to manage the loads that are imposed by the choices so that they remain within the manufacturer's specified chassis weight limits. Do not overload the recreation vehicle. Net carrying capacity (NCC) determined by subtracting unloaded vehicle weight (UVW) from gross vehicle weight (GVWR) and includes fluids, options and cargo. Liquid capacities and weights are approximations only. Warning: This information is intended as a guide only. Weights of individual vehicles may vary. Consult your owner's manual for complete loading, weighing and towing instructions.

Product information, specifications, and photography in this brochure were as accurate as possible at time of printing. Photographs may contain some features that are optional on your vehicle. Since we continually strive to improve our products, actual products may differ. Prices and specifications are subject to change without notice. All capacities are approximate and dimensions are nominal. Some features shown are optional and may be different or unavailable in Canada. Vehicles are designed for recreational use only and not intended for use as a primary residence.

TWO YEAR STRUCTURAL AND APPLIANCE WARRANTY • ONE YEAR BUMPER TO HITCH WARRANTY

ULTRA-LITE EXPANDABLES

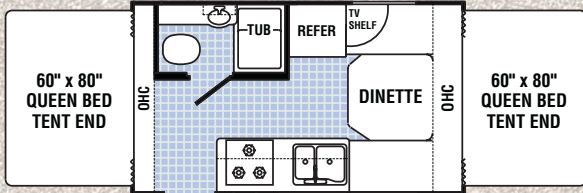

160

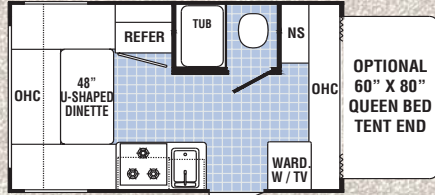

17FL

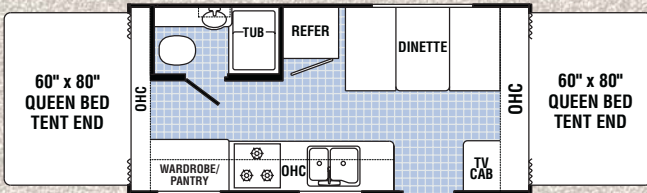

195

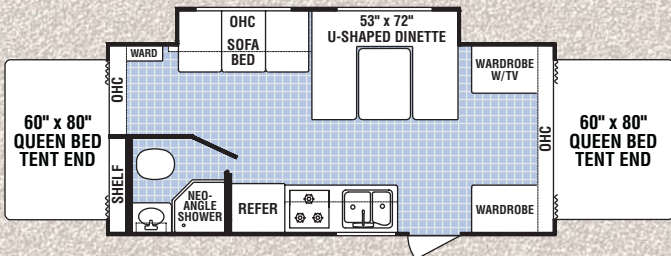

214

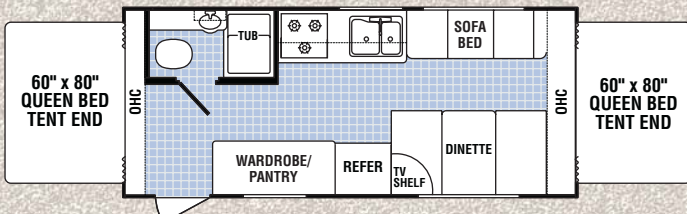

215



VINYL

INDUSTRY LEADING ULTRA-LITE TECHNOLOGY

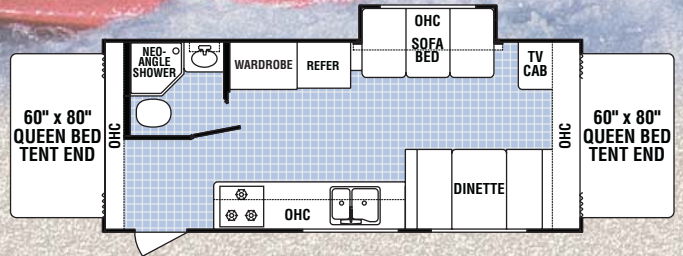

235

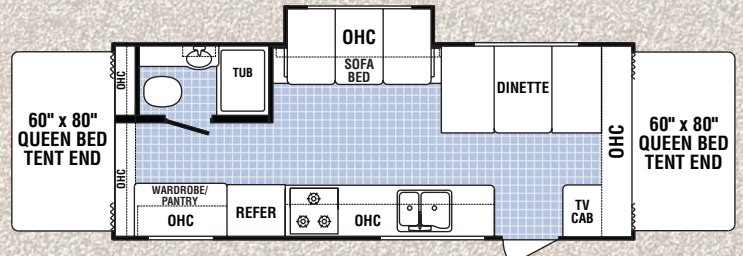

236

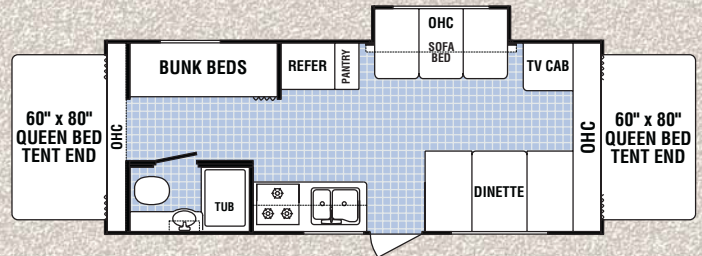

23BH

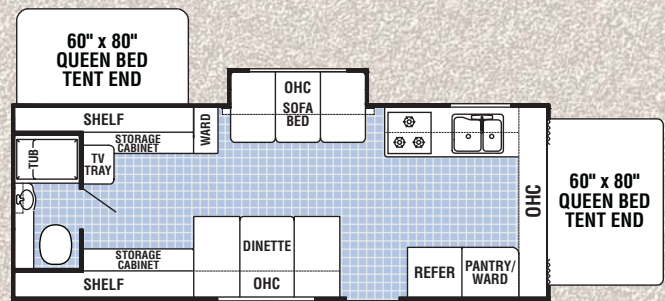

23TT



1 YEAR BUMPER TO HITCH LIMITED WARRANTY
2 YEAR STRUCTURAL & APPLIANCE LIMITED WARRANTY

We're so confident in the design and construction of our products that they are covered by Thor's Limited Warranty program.

*See owner's manual for complete warranty details.

KODIAK FULLY LAMINATED 6-WAY

Most Kodiak floorplans feature the HAPPI-JAC® secure track slide system. This low profile 12V electric slide system takes up less space, which frees up room for larger slide rooms and more storage.

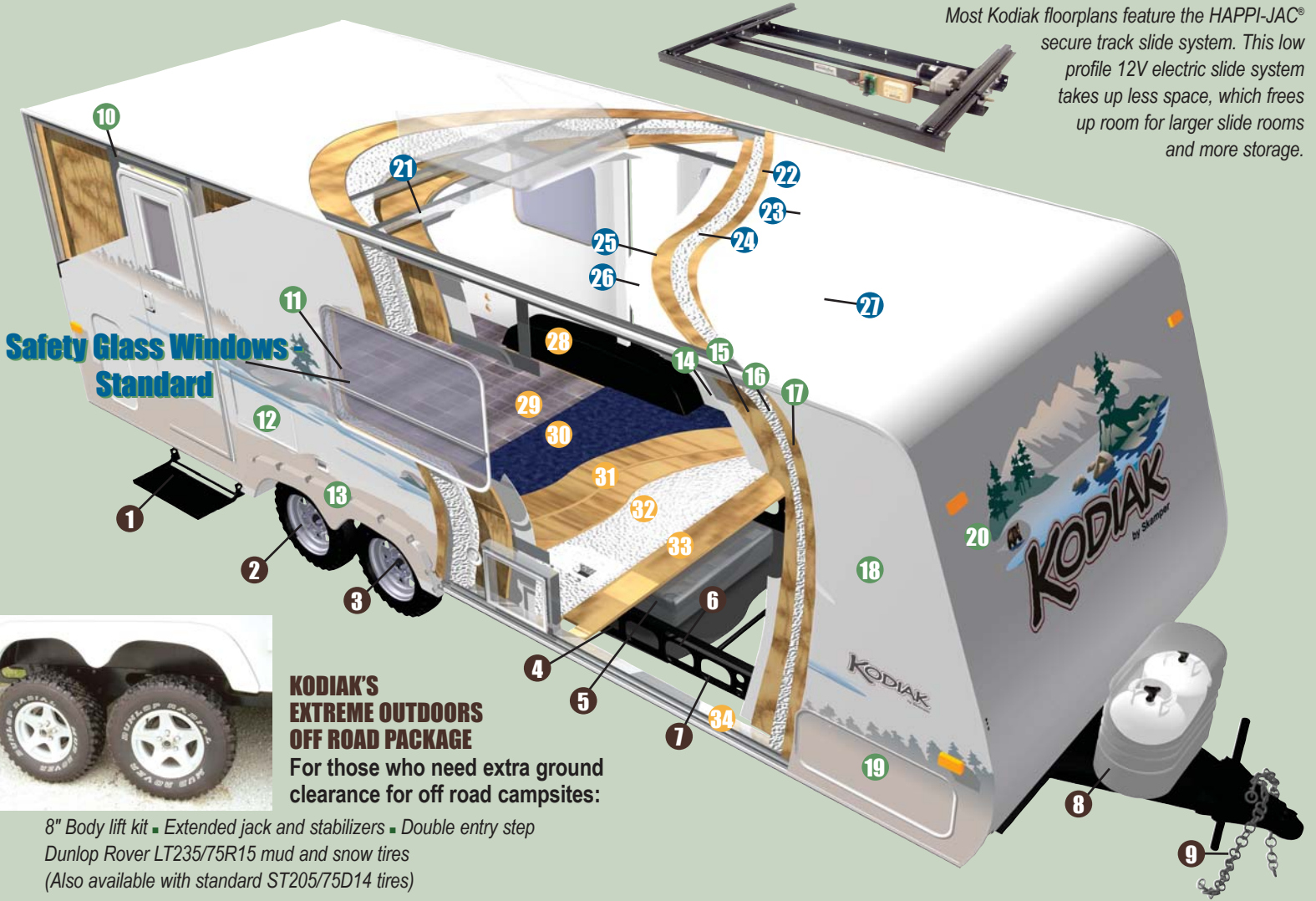

Safety Glass Windows - Standard

KODIAK'S EXTREME OUTDOORS OFF ROAD PACKAGE
For those who need extra ground clearance for off road campsites:

8" Body lift kit ■ Extended jack and stabilizers ■ Double entry step
Dunlop Rover LT235/75R15 mud and snow tires
(Also available with standard ST205/75D14 tires)

CHASSIS

Kodiak Expandables and Travel Trailers feature the Norco European style, ultra-lite weight chassis. Kodiak is the first company in the industry to use European style frames in ultra-lites!

1. Folding entry step – low step height for easy entry
2. Ultra-lube hubs. Grease Zerk makes wheel bearings easy to lube. Extends life of bearings
3. Al-Ko torsion "independent suspension" axles – the smoothest ride in the industry
4. All tanks mounted in frame. Lowers the center of gravity, and saves valuable interior storage space
5. 46 gallon fresh water tank with Quick Drain feature. Tank design prevents water from standing in tanks during storage. The largest fresh water tank in the industry!
6. Optional enclosed underbelly protects tanks and floor from the hazards of the road
7. Norco ultra light weight chassis with lifetime powder coat over E-coat paint finish
8. Dual battery pack and (2) 30 lb. LP tanks with ABS cover (Travel Trailers) or (2) 20 lb. LP tanks with optional ABS cover (Expandables)
9. Integrated heavy-duty safety chains

WALLS

5-ply aluminum framed laminated construction.

10. Tubular aluminum welded frame reinforced around door
11. Radius corner, safety glass windows
12. Insulated baggage doors with key locks and finger locks
13. ABS fender skirts
14. Decorative wall board
15. Lauan wood backer
16. High density structural foam insulation
17. Lauan plywood backer
18. Smooth fiberglass with premium graphics package
19. Pass-through storage compartment (where available)
20. Aerodynamic front profile

ROOF

5-ply aluminum framed laminated construction.

21. Tubular aluminum welded framed roof, reinforced at A/C
22. Lauan wood backer
23. One-piece EPDM rubber roof with 12 year manufacturer's material warranty
24. High density structural foam insulation
25. Lauan wood backer
26. Decorative ceiling board
27. 5" Thick arched roof (Kodiak Travel Trailers)

FLOOR

5-ply aluminum framed laminated floor structure.

28. One-piece composite wheel wells
29. Armstrong residential vinyl flooring – full length of coach
30. Residential carpet with pad (optional)
31. Two layers of floor decking over foam
32. High density structural foam
33. Plywood base with polypropylene waterproof vapor barrier
34. Tubular welded aluminum framed floor, reinforced at tanks

Take Life to the Extreme!

INDUSTRY LEADING ULTRA-LITE TECHNOLOGY

ALUMINUM FRAMED CONSTRUCTION

Setting the standard with **ULTRA-LITE CONSTRUCTION**

KODIAK VS. THE COMPETITION **IMPROVED AERODYNAMICS**

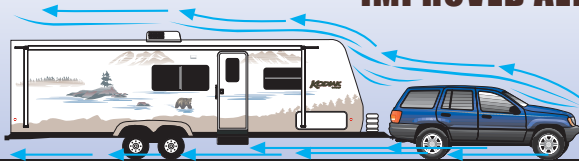

Lower profile – more aerodynamic!



Flat front profile – less aerodynamic

Well balanced low profile design

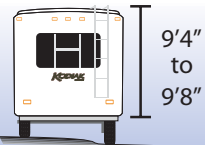

LOWER CENTER OF GRAVITY

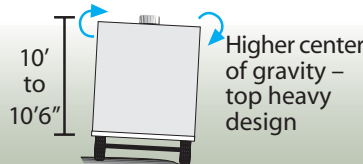

Torsion "independent suspension" axles

Leaf spring solid axles

AXLE TO HITCH WEIGHT RATIO



Optimal axle to hitch ratio for smooth towing



Excessive tongue weight causes more wear on tow vehicle

Well balanced design – axle and hitch

Excessive hitch weight

Kodiak, North America's first ultra-lite travel trailer is specifically designed to be towed by most light trucks, and sport utility vehicles. Kodiak's aerodynamic profile is designed to push air up the front wall and over the roof to *improve towability and fuel economy*. Plus, we position the axles and balance the weight of each floorplan to create the optimal hitch/weight/axle ratio for *towing with light trucks or SUVs*. And, Kodiak incorporates rubber torsion "independent suspension" axles on a European-style frame. Torsion axles allow each wheel to travel independently, unlike leaf spring axles that transfer variations in the road to the opposite wheel. Plus, the torsion axles *improve towing stability* by lowering the trailer to the ground and reducing the center of gravity.

Improved aerodynamics, optimal weight balance and a lower center of gravity results in the best towing characteristics possible in an ultra-lite travel trailer.



Large fresh water tank
46 gallon fresh water tank with Quick Drain feature. Tank design prevents water from standing in tanks during storage.

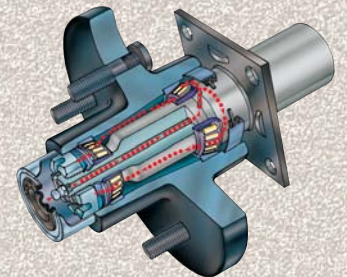

Ultra-Lube hubs

Kodiak includes Ultra-Lube hubs as a standard feature. This allows for easy maintenance of your wheel bearings. (N/A on Kodiak Expandables.)



Torsion Axles

Both Kodiak Expandables and Travel Trailers ride on rubber torsion "independent suspension" axles. Torsion axles soften the ride by absorbing road vibrations and making towing more comfortable. The center of gravity is lowered with torsion axles, which improves aerodynamics and maneuverability.

Norco Ultra-lite Frame

Kodiak Expandables and Travel Trailers feature an ultra-lite European-style chassis. This durable chassis is 400 pounds lighter than the traditional box-style chassis, which reduces weight and increases cargo capacity. The frame features a powder coat over E-coat paint finish, backed by a lifetime rust through warranty.

A Kodiak Exclusive!



TWO YEAR STRUCTURAL AND APPLIANCE WARRANTY • ONE YEAR BUMPER TO HITCH WARRANTY



ULTRA-LITE TRAVEL TRAILERS

**16 floor plans
as light as 3486 lbs,
loaded with standard features.**

Kodiak. The original Ultra-Lite travel trailer features 16 innovative floor plans, ranging from 18' to 30'. With units light enough to be towed by SUVs and light trucks, we are sure to have the model that best fits your family's needs.

Designer residential furnishings and fabrics, spacious kitchens, living areas and bedrooms are core features of the Kodiak product line. And just because Kodiak is an Ultra-Lite, it doesn't mean your trailer is light on storage. With spacious countertop and cabinet space, oversized pass-through exterior storage and innovative features like the optional "Pac-n-Play" storage compartment and rear "Stor-More" garage, it's easy to take everything along on your next adventure.

Kodiak – The leader in Ultra-Lite technology.



**Kodiak 30BH
in Foliage**

Kodiak kitchens feature a 3-burner range with large oven, large two bowl sink with high-rise faucet and a residential microwave. 30BH kitchen shown at right.



Kodiak features aluminum framed dinette, bed, bunks and pass through storage frames. Aluminum frames are more durable than wood framed structures and save weight.

A Kodiak exclusive – our 53" x 72" U-shaped booth dinette!
 Kodiak's innovative slide room construction allows for the largest dinette in Ultra-Lites! The "U-shaped" booth seats six and folds into a massive 53" x 72" queen bed!





EXCLUSIVELY KODIAK

The Original Ultra-Lite Travel Trailer.

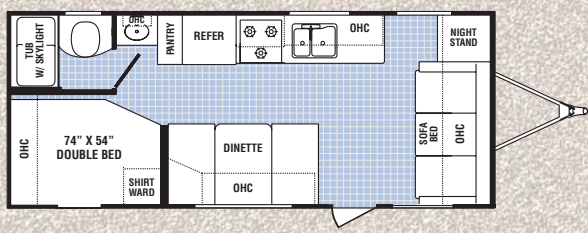

18FS

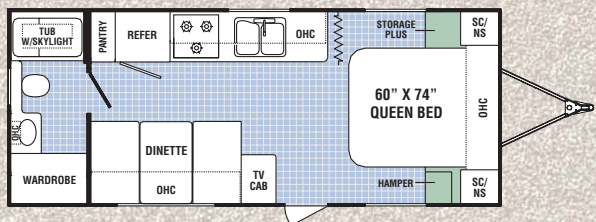

19FL

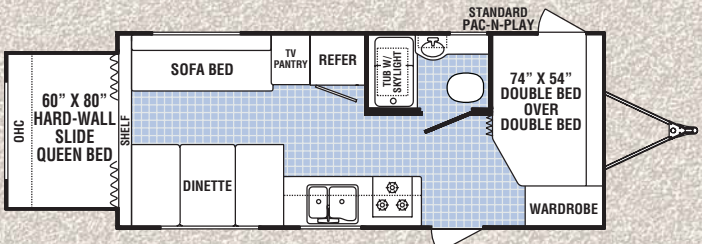

21QS

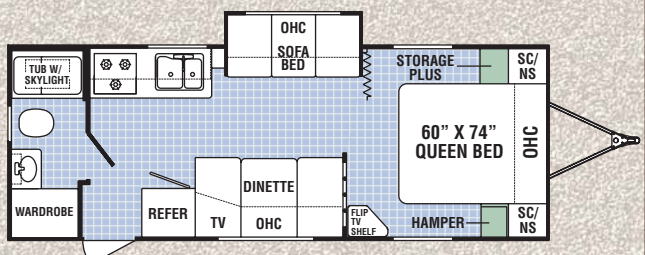

24RB-SL

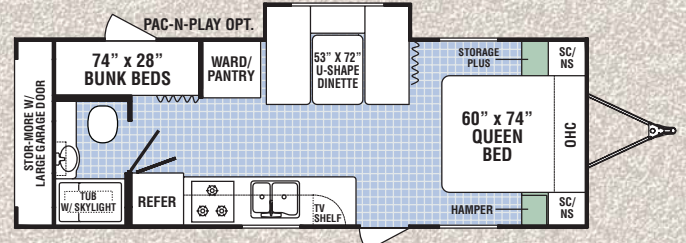

25RGB-SL

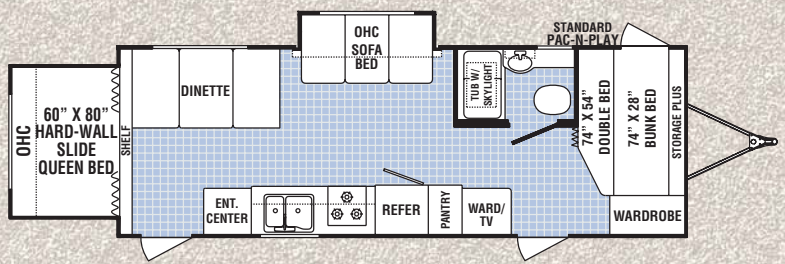

25QS

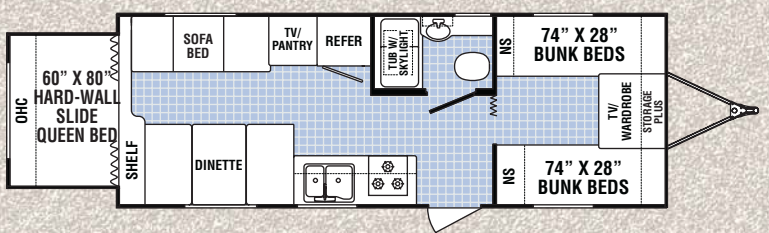

26QS

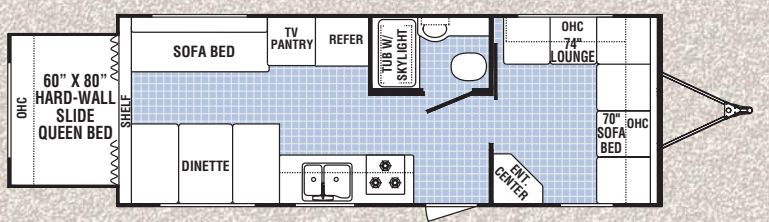

26QSL

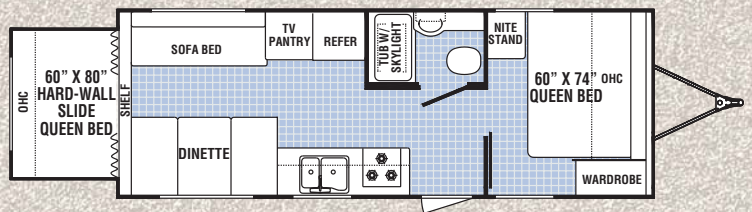

26QSQ

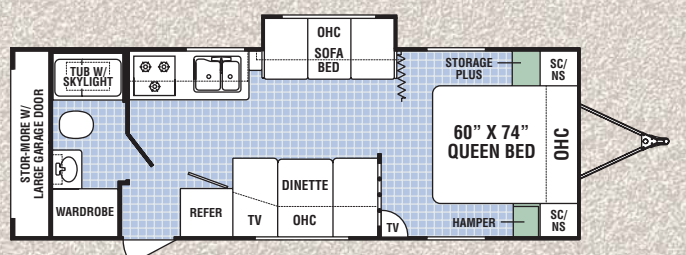

26RG-SL

INDUSTRY LEADING ULTRA-LITE TECHNOLOGY

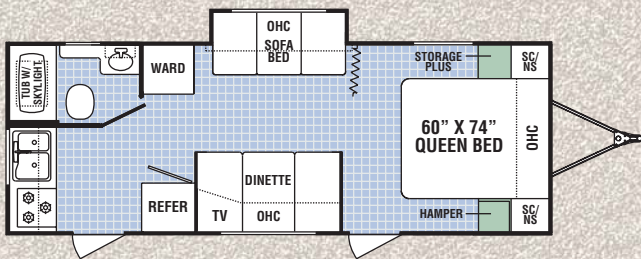

26RK-SL

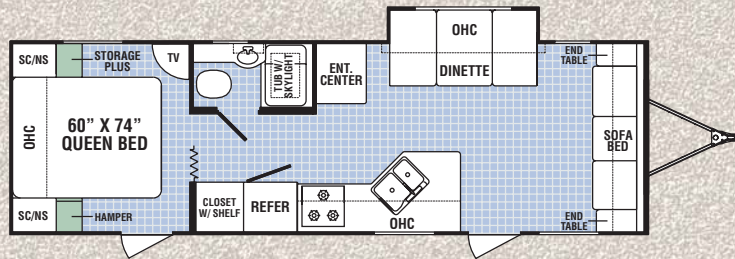

27RB-SL

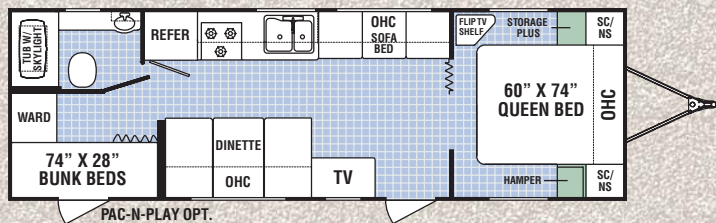

27BH

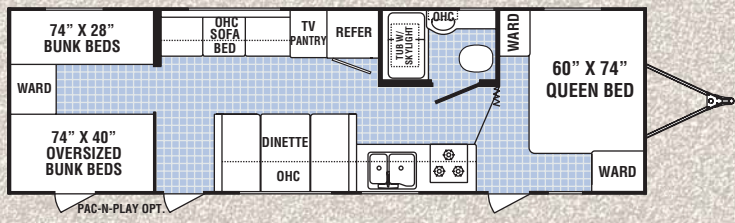

29QBH

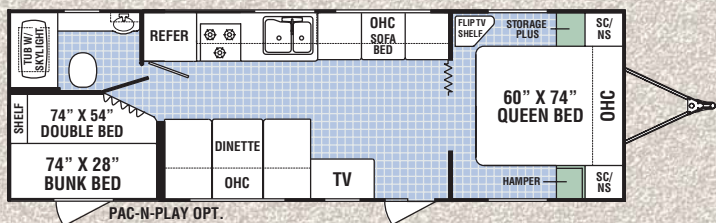

27BH-BD

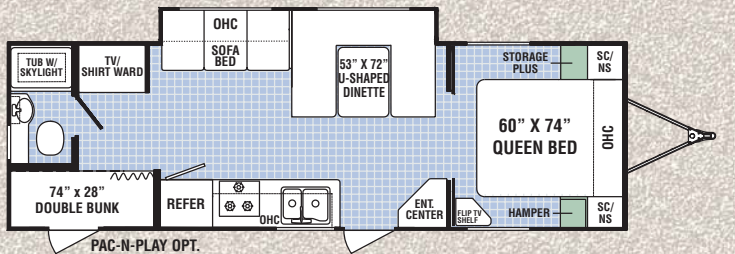

30BH-SL (available with Pac-n-Play storage option)

SEE PAGE 5 FOR DECOR CHOICES



VINYL



CARPET

KODIAK ULTRA-LITE TRAVEL TRAILERS

TRAVEL TRAILERS	18FS	19FL	21QS	24RB-SL	25RGB-SL	25QS	26QS	26QSL	26QSQ	26RG-SL	26RK-SL	27RB-SL	27BH	29QBH	30BH-SL
*Axle Weight	3170	3326	3680	3469	3738	3954	3857	N/A	4092	3779	3841	3745	N/A	3938	4051
*Dry Hitch Weight	315	285	275	433	383	392	397	N/A	413	409	479	605	N/A	689	479
*Unloaded Vehicle Weight	3486	3612	3956	3902	4122	4328	4254	N/A	4506	4188	4350	4350	N/A	4628	4530
GVWR	6000	6000	6000	6000	6000	6000	6000	N/A	6000	6000	6000	6000	N/A	6000	6000
Net Cargo Capacity	2514	2388	2004	2098	1878	1672	1746	N/A	1494	1812	1650	1650	N/A	1372	1470
Exterior Length	24'4"	24'4"	24'4"	26'4"	28'7"	27'1"	26'9"	N/A	26'9"	28'7"	26'9"	30'3"	N/A	31'9"	30'3"
Exterior Height w/A/C	9'8"	9'8"	9'8"	9'8"	9'8"	9'8"	9'8"	9'8"	9'8"	9'8"	9'8"	9'8"	N/A	9'8"	9'8"
Exterior Width	8'	8'	8'	8'	8'	8'	8'	8'	8'	8'	8'	8'	N/A	8'	8'
Fresh Water Capacity	46	46	46	46	46	46	46	N/A	46	46	46	46	N/A	46	46
Gray Water Capacity	34	34	34	34	34	34	34	N/A	34	26	34	34	N/A	34	34
Black Water Capacity	22	22	22	22	22	22	22	N/A	22	22	22	22	N/A	22	22
Furnace Size (BTUs)	19,000	19,000	19,000	19,000	19,000	30,000	30,000	N/A	30,000	19,000	30,000	30,000	N/A	31,000	30,000

Tire Size (all models): ST205/75D14(C)

Interior Height (all Aeroite and Cub models): 6'4"

*Axle weight, dry hitch weight and unloaded vehicle weight (UVW) are base weights of units without options. Each unit includes a weight label which lists specific weight information for that unit. Vehicle Loading – Every effort has been made to provide the greatest number of options for the recreation vehicle owner. Along with these choices comes the responsibility to manage the loads that are imposed by the choices so that they remain within the manufacturer's specified chassis weight limits. Do not overload the recreation vehicle. Net carrying capacity (NCC) determined by subtracting unloaded vehicle weight (UVW) from gross vehicle weight (GVWR) and includes fluids, options and cargo. Liquid capacities and weights are approximations only. Warning: This information is intended as a guide only. Weights of individual vehicles may vary. Consult your owner's manual for complete loading, weighing and towing instructions.

Product information, specifications, and photography in this brochure were as accurate as possible at time of printing. Photographs may contain some features that are optional on your vehicle. Since we continually strive to improve our products, actual products may differ. Prices and specifications are subject to change without notice. All capacities are approximate and dimensions are nominal. Some features shown are optional and may be different or unavailable in Canada. Vehicles are designed for recreational use only and not intended for use as a primary residence.

TWO YEAR STRUCTURAL AND APPLIANCE WARRANTY • ONE YEAR BUMPER TO HITCH WARRANTY

MORE STANDARD FEATURES

FROM THE INDUSTRY LEADER IN ULTRA-LITE TECHNOLOGY

Exterior Features

	Expandable	TT
8' Wide floorplans	■	■
2-20 lb LP bottles with ABS cover	■	N/A
Two 30 lb LP bottles with ABS cover	N/A	■
Key-locking "Easy Latch" tent doors	■	N/A
Self-Supporting bunk ends - no poles required	■	N/A
60" x 80" queen beds in tents	■	N/A
60" x 80" queen bed in hard-wall slide	N/A	■
26" radius corner entry door	■	■
Flush combo entry latch/deadbolt lock	■	■
ABS wheel wells	■	■
Tandem axles with 4-wheel electric brakes	■	■
6-Way welded aluminum laminated superstructure (roof, floor and walls)	■	■
Lite-weight European-style frame with lifetime rust through warranty	■	■
Rubber torsion "independent suspension" axles	■	■
ABS fender skirts	■	■
EPDM one-piece seamless rubber roof	■	■
Corrosion free laminated underbelly	■	■
Patio, step, & dump valve service lights	■	■
High-end designer graphics	■	■
Rain gutter with corner downspouts	■	■
Rear bumper and corner guards	■	■
Single entry step	■	■
Tinted radius clamp ring windows	■	■
Exterior step light with switch	■	■
Entry-assist handle at door	■	■
Break-away trailer switch	■	■
120V Exterior outlet	■	■
Window in bathroom (most models)	N/A	■
Roof ducted for air conditioning	N/A	■

Interior Features

	Expandable	TT
5" Thick, reversible dinette seats	■	■
Bathroom medicine cabinet	■	■
Designer window treatments	■	■
Fiberlink bathtub	■	■
Shower curtain	■	■
Glass décor light over dinette table	■	■
Mini blinds throughout	■	■
Power roof vent in bathroom	■	■

Residential tile-like linoleum	■	■
Color-coordinated bedspread	N/A	■
Clothes hamper/laundry basket with access to Storage Plus	N/A	■

Appliances and Electrical

	Expandable	TT
12V Electric slide-out motor	■	■
19M BTU forced air DSI furnace with wall thermostat	■	N/A
30M BTU forced air DSI furnace with wall thermostat (most models)	N/A	■
Ducted heat	■	■
30 Amp power cord with storage compartment	■	■
6 Gallon gas water heater with bypass	■	■
12V interior lights with wall switch	■	■
Fire extinguisher	■	■
LP detector	■	■
Carbon monoxide detector	■	■
Smoke detector	■	■
Norcold single door gas/electric refrigerator	■	N/A
6 Cubic ft. Norcold double door gas/electric refrigerator	OPT	■
Pre-wired for air conditioning	■	■
Pre-wired for cable TV and stereo	■	■
Range hood with 12V light and exhaust fan	■	■
Solid state converter with built-in battery charger	■	■
Systems monitor panel	■	■
Demand water pump	■	■



2164 Caragana Court ■ Goshen, IN 46526
 Sales: 574.534.1224 ■ Fax: 574.975.0556
 Parts & Service: 574.537.0700
www.kodiak-rv.com

Options

Kodiak Expandables Pack Group:

- 13.5 BTU air conditioning with wall thermostat
- AM/FM/CD player with two speakers
- A&E 8300 series awning
- TV antenna with cable prep
- Microwave
- Bunk end lights with fan
- Oven with three burner range

Kodiak Travel Trailers Pack Group:

- 13.5 BTU air conditioning with wall thermostat
- AM/FM/CD player with four speakers
- A&E 8300 series awning
- TV antenna with cable prep
- Microwave

Other Optional Features

	Expandable	TT
Exterior sound system	■	■
Audiovox 2-way radio system: four 5-mile range handsets & 12V wall mounted charger	■	■
Heated bunk mattress	■	N/A
Custom bike rack with truck receiver accessory	■	■
Spare tire with cover	■	■
6.3 Cubic ft. double door refrigerator	■	STD
3 Burner high-output range	■	STD
DSI water heater (gas/electric)	■	■
Heated holding tanks (3)	N/A	■
Safety glass	■	■
Hot/Cold Exterior shower	■	■
Stove cover	■	■
Tab surround	■	■
Water filter system	■	■
Exterior barbeque grill	■	■
Bedroom carpet	N/A	■
Aluminum rims	N/A	■
Enclosed underbelly	N/A	■
Fantastic vent	N/A	■
Four corner stabilizer jacks with sand pads	STD	■
Roof ladder	N/A	■
Bi-fold shower door	■	■



Why A Thor Product Is Your Best RV Value:

Thor Industries, Inc., listed on the New York Stock Exchange, proudly traces its history back over seventy years to the pioneering days of the RV industry with the founding of Airstream, the industry's oldest and most renowned brand. Our total commitment to quality and our philosophy of putting our customers first has led to our continuous growth. Today, Thor is the largest builder of RVs. Thor's strong financial condition and years of solid growth are your assurance that we will be here to serve you for years to come. We think this extra peace of mind is important when you are making a significant investment. Because our customers are always #1 with us, we work harder than other manufacturers to satisfy you.

©2005 Thor Industries, Inc. KRev1.08/17/05

Your Local Dealer



Free Good Sam Club Membership When you purchase a Kodiak Ultra-lite trailer

We are pleased to offer all buyers of a new 2006 Kodiak Ultra-lite travel trailer a free 6 month membership in the Good Sam Club. The Good Sam Club is the world's largest RV owner's organization, and we believe that being a member will help you enjoy your new travel trailer even more.

With your free membership, you will receive benefits designed to help you get the most from your RV, like:

- 10% discount at more than 1,700 RV parks & campgrounds
- Fuel and restaurant discounts
- Camping rallies and events
- Subscription to *Highways* magazine
- FREE RV trip routing service
- Access to the Good Sam website

After your purchase, keep an eye out for a mailing from Kodiak with all of the membership details! (Allow 4 to 6 weeks for details to arrive in the mail)

Take Life to the Extreme!