

YOKE®

Safety is our first priority™

YP™

Yellow Point

2020



Catalog No. 8-2020 YP





VIDEO





**PATENT
PEND.**

USA
JAPAN
CHINA
EUROPE
TAIWAN

⚠ WARNING
NEVER EXCEED PUBLISHED WORKING LOAD LIMIT

Revolutionary Solution For Safety Inspection

YOKE's unique design of proprietary wafer-antenna chip construction, enables Smart Phone NFC and RFID inspection management to be more intuitive and efficient.



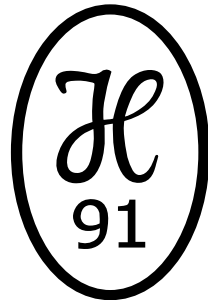

Quality Management System and Product Type Approval:



Statement of LIMITED WARRANTY

Purchaser and YOKE expressly agree that YOKE's warranty with respect to sale of its products is LIMITED solely to YOKE's choice of repair, replacement or refund of the purchase price of any product.

Purchaser and YOKE expressly agree that the remedies provided in this section are the purchaser's exclusive remedies in connection with the purchase or use of the product. Purchaser and YOKE expressly agree that in no event shall YOKE be liable for any incidental or consequential damages in connection with the purchase or use of the product.

All other warranties, including express warranties and the implied warranties of merchantability and fitness for a particular purpose are hereby disclaimed. Purchaser hereby waives all other warranties, rights and remedies arising by law or otherwise including, but not limited to, express warranties, the implied warranty of merchantability, any implied warranties arising from course of performance, course of dealing or usage of trade, and implied warranty of fitness for a particular purpose. Additionally, yoke hereby disclaims any of its obligations or liabilities arising from statute, warranty, contract, tort or negligence. Any modification made to yoke products will void the limited warranty where applicable, and will also void any third party accreditations that may apply such as abs, dnv, etc.

Complete Agreement: This Warranty between purchaser and YOKE is complete. All prior or contemporaneous discussions, representations and/or understanding are merged into this Warranty.

All prior or contemporaneous agreements between the parties are superseded by this Warranty. Choice of Law: Any dispute about the interpretation of this Warranty shall be governed by the laws of Taiwan, The Republic of China.

The Period of Warranty: Shall start from the date of delivery of the product to the customer and shall cover a period of 12 months.

Resolution of Disputes: Purchaser and YOKE expressly agree that any dispute arising out of the purchase, use or operation of the purchased product shall, upon written notice to the other party, be resolved through binding arbitration. The arbitration shall be governed by the then existing rules of the Arbitration Association of The Republic of China. The location of any arbitration shall be Taichung, Taiwan, The Republic of China. The substantive laws of The Republic of China shall govern the arbitration to the extent they are not in conflict with the then existing rules of the Arbitration Association of The Republic of China. In no event shall YOKE be liable for incidental or consequential damages as part of the arbitration award. The award, decision, or filing rendered by the arbitration shall be final, and judgment may be entered upon it in accordance with the applicable law in any court having appropriate jurisdiction.

YOKE INDUSTRIAL CORP.

YOKE YP Size & WLL Chart



Lifting Point



Anchor Point



Hoist Ring



Super Point



Swivel Point



Key Eye Point



Eye Point Acero
Inoxidable

	8-211	8-231	8-203	8-251	8-271	8-291	8-S291
Rosca	CMU(t)						
M 6						0.1 NEW	
M 8	0.3	0.5	0.5	0.3	0.4	0.3	
M10	0.63	0.7	0.55	0.5	0.6	0.4	
M12	1	1	1.3	0.7	0.7	0.75	0.5
M14	1.2	1.5		1			
M16	1.5	2	2.4	1.4	1.5	1.5	1
M18	2	2.5					
M20			2.7	1.7			
	2.5	3	3.75	2.5	2.5	2.3	2
M24				1.7			
	4	5	5.25	4	4	3.2	2.5
M27	4	5.6					
M30				4			
				6.7			
	5	7.8	8.75	8	6	4.5	
M36	7						
	8	12.5	13.75	10	10	7	
M42	10			12.5			
	15	15.6	15.6	13	13	9	
M45				12.5			
				17			
M48				12.5			
	20	20	16.9	17	14	12	
M56	22	22	19.4	18	20	16	
M64				20			
	22.5	22.5	27.9	28	20	18	
M72				28			
				35	40		
M80				28			
				35			
				40	40		
M90				35			
				40	40		
M100				40			

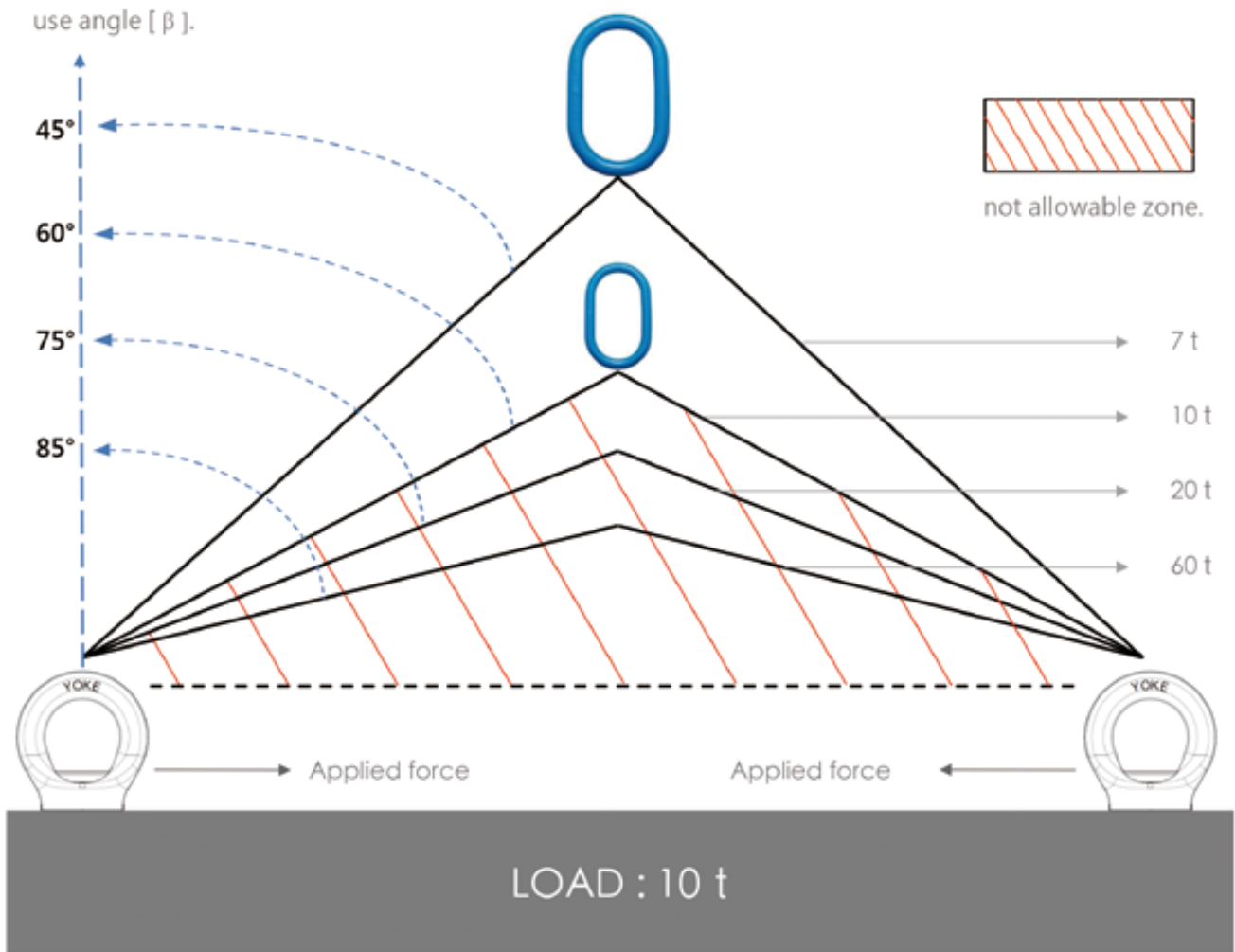

Tension in a single leg

The Tension load is also acting on the Yellow Points.

Quality Control, Testing, and Detecting during manufacturing

YOKE runs a constant and strict production facility with quality control in every manufacturing stage from raw materials to the completed product. YOKE is an ISO 9001 certified company and has Type Approval by the major international authorities from Deutsche Gesetzliche Unfallversicherung (DGUV) , ABS, API, and DNV. YOKE has achieved CNLA certification - Chinese National Laboratory Accreditation which ensures a quality research and development (R&D) department and unsurpassed product engineering.

Magnaflux Crack Detection:

All forged components are individually magnaflux detected after heat treatment.

Proof Load Testing:

YOKE Yellow Points are proof load qualified to 2.5 times the Working Load Limit within 1% permanent deformation.

Dynamic Fatigue Testing:

Batch samples of YOKE Yellow Points are Dynamic Fatigue Tested to 20,000 cycles at 1.5 times the Working Load Limit.

Ultimate Breaking Load Testing:

Batch samples are tested in a static tensile testing machine until failure. Minimum ultimate force equals to the Working Load Limit times safety factor.

Spectrographic Analysis:

To assure of the proper metallurgy content of all raw materials.



Test certificate
Complied to EN10204

Safety is our first priority™

- Quality, Reliability, Innovation -



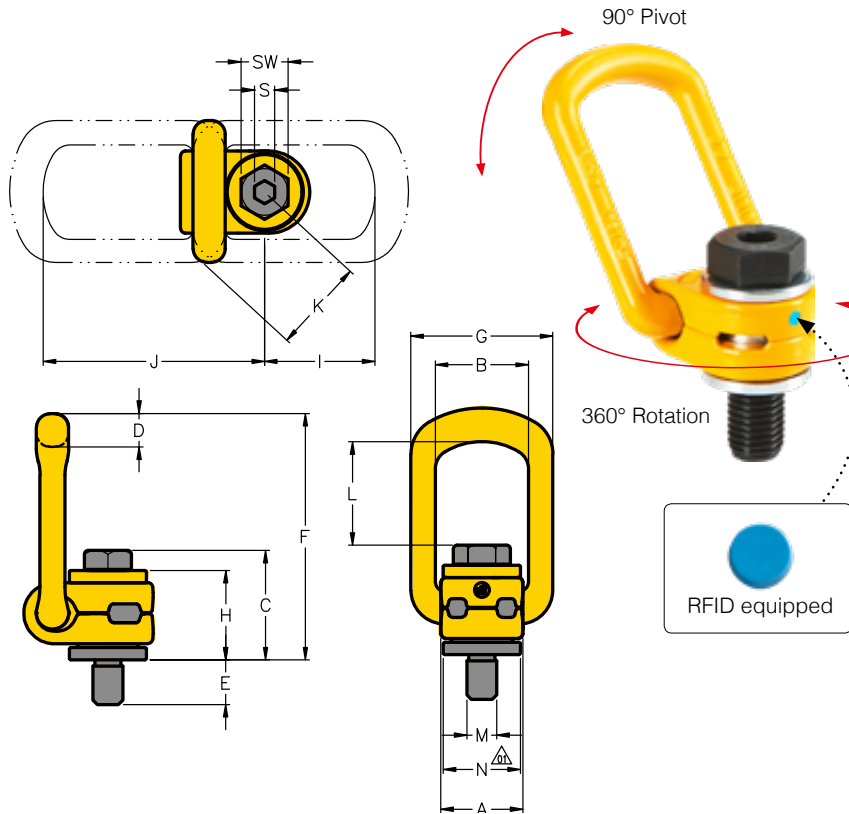

- Rotates through 360° and pivot 90°.
- Manufactured from alloy steel, quenched and tempered.
- Tested in accordance with EN1677-1.
- Certified by DGUV GS-OA 15-04.
- Load rated parts are 100% magnaflux crack detected.
- Individual forged parts and cap screw are traceable to Test Certification.
- Bolts are Metric thread.
- Proof tested to 2.5 times the WLL.
- Fatigue rated to 20,000 cycles at 1.5 times the WLL.
- All YOKE Lifting points meet or exceed all the requirements of ASME B30.26.
- Quick and simple assembly, just a tapped hole is required.

» Taiwan Patent
» China Patent

Lifting Point

Metric Thread (8-211)



Item No.	Working Load Limit tonnes	Thread version			Dimensions														Torque in Nm	N.W. kg
		M	E	Pitch	A	B	C	D	F	G	H	S	SW	I	J	K	L	N		
		mm	mm	DIN13	mm															
8-211-003	0.3	M 8	11	1.25	30	35	35	11	86	55	29	6	13	41	77	34	41	24	30	0.3
8-211-006	0.63	M 10	16	1.5	30	35	36	11	86	55	29	6	17	42	78	34	40	24	60	0.4
8-211-010	1	M 12	18	1.75	33	38	44	14	99	57	36	8	19	44	89	38	42	31	100	0.5
8-211-012	1.2	M 14	21	2	33	38	45	14	99	57	36	10	22	45	89	38	40	31	120	0.5
8-211-015	1.5	M 16	24	2	33	38	46	14	99	57	36	10	24	45	89	38	40	31	150	0.6
8-211-020	2	M 18	26	2.5	50	54	57	16	143	82	44	12	30	74	132	52	70	45	200	1.3
8-211-025	2.5	M 20	31	2.5	50	54	56	16	142	82	43	12	30	74	132	53	70	49	250	1.6
8-211-040	4	M 24	36	3	50	54	59	16	143	82	44	14	36	74	132	53	67	45	400	1.9
8-211-042	4	M 27	38	3	60	65	79	23	171	99	62	17	41	81	152	64	69	59	400	2.9
8-211-050	5	M 30	49	3.5	60	65	81	23	170	99	62	17	46	80	153	64	67	59	500	3.1
8-211-070	7	M 36	56	4	60	65	75	23	171	99	58	22	55	80	153	64	74	59	700	3.1
8-211-080	8	M 36	62	4	77	85	101	27	225	124	78	22	55	112	205	80	97	69	800	5.9
8-211-100	10	M 42	72	4.5	77	85	104	27	225	124	78	24	65	113	204	79	94	69	1000	6.3
8-211-150	15	M 42	64	4.5	95	104	112	36	258	158	86	24	65	127	229	98	110	98	1500	10.9
8-211-200	20	M 48	73	5	95	104	120	36	260	158	90	27	75	126	230	99	104	98	2000	12.1
8-211-220	22	M 56	85	5.5	95	104	121	36	261	158	91	27	85	125	231	99	104	98	2100	13.1
8-211-225	22.5	M 64	100	6	113	104	126	36	261	158	91	32	95	121	235	101	99	98	2200	15.5

* Design Factor 4:1
* Bolt in GEOMET[®] finished on request



Kind of attachment																
	1	2	1	2	2	2	2	3-4	3-4	3-4	3-4	3-4	3-4	3-4	3-4	
Number of legs	1	2	1	2	2	2	2	3-4	3-4	3-4	3-4	3-4	3-4	3-4	3-4	
Load direction	0°	0°	90°	90°	0-45°	45° - 60°	unsymm.	0 - 45°	45° - 60°	unsymm.	0 - 45°	45° - 60°	unsymm.	0 - 45°	45° - 60°	unsymm.
Item No.	Thread	WLL(t)														
8-211-003	M 8	0.3	0.6	0.3	0.6	0.42	0.3	0.3	0.63	0.45	0.3					
8-211-006	M 10	0.63	1.26	0.63	1.26	0.88	0.63	0.63	1.32	0.95	0.63					
8-211-010	M 12	1	2	1	2	1.4	1	1	2.1	1.5	1					
8-211-012	M 14	1.2	2.4	1.2	2.4	1.7	1.2	1.2	2.5	1.8	1.2					
8-211-015	M 16	1.5	3	1.5	3	2.1	1.5	1.5	3.1	2.2	1.5					
8-211-020	M 18	2	4	2	4	2.8	2	2	4.2	3	2					
8-211-025	M 20	2.5	5	2.5	5	3.5	2.5	2.5	5.2	3.7	2.5					
8-211-040	M 24	4	8	4	8	5.6	4	4	8.4	6	4					
8-211-042	M 27	4	8	4	8	5.6	4	4	8.4	6	4					
8-211-050	M 30	5	10	5	10	7	5	5	10.5	7.5	5					
8-211-070	M 36	7	14	7	14	9.8	7	7	14.7	10.5	7					
8-211-080	M 36	8	16	8	16	11.2	8	8	16.8	12	8					
8-211-100	M 42	10	20	10	20	14	10	10	21	15	10					
8-211-150	M 42	15	30	15	30	21	15	15	31.5	22.5	15					
8-211-200	M 48	20	40	20	40	28	20	20	42	30	20					
8-211-220	M 56	22	44	22	44	30.8	22	22	46.2	33	22					
8-211-225	M 64	22.5	45	22.5	45	31.5	22.5	22.5	47.25	33.75	22.5					

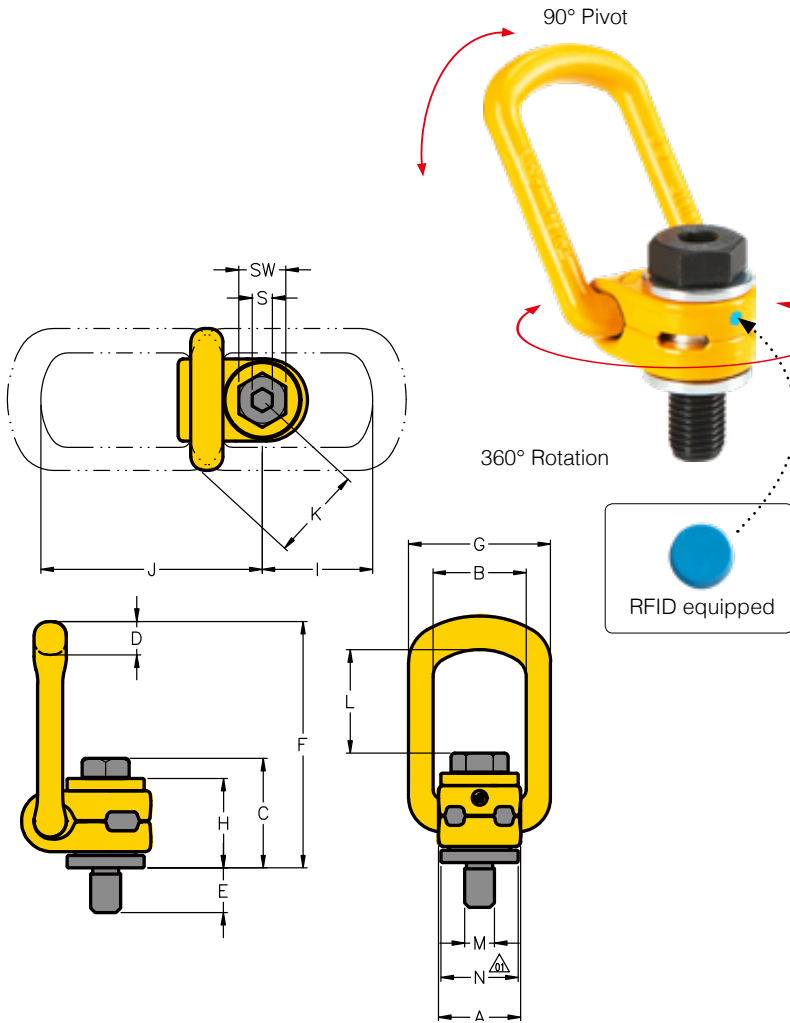

- Rotates through 360° and pivots 90°.
- Manufactured from alloy steel, quenched and tempered.
- Tested in accordance with EN1677-1.
- Load rated parts are 100% magnaflux crack detected.
- Individual forged parts and cap screw are traceable to Test Certification.
- Bolts are UNC thread.
- Proof tested to 2.5 times the WLL.
- Fatigue rated to 20,000 cycles at 1.5 times the WLL.
- All YOKE Lifting points meet or exceed all the requirements of ASME B30.26.
- Quick and simple assembly, just a tapped hole is required.

» Taiwan Patent
» China Patent

Lifting Point

UNC Thread (8-212)



Item No.	Working Load Limit	Thread version			Dimensions														Torque in		N.W.
		M	E	TPI	A	B	C	D	F	G	H	S	SW	I	J	K	L	N	Nm	lbs	
	tonnes	inch	inch		mm																
8-212-010	1	1/2	0.94	13UNC	1.3	1.48	1.73	0.53	3.9	2.24	1.42	5/16	3/4	1.74	3.49	1.49	1.62	1.22	100	1	
8-212-015	1.5	5/8	1.14	11UNC	1.3	1.48	1.81	0.53	3.9	2.24	1.42	3/8	15/16	1.76	3.49	1.47	1.56	1.22	150	1.3	
8-212-020	2.5	3/4	1.46	10UNC	1.97	2.12	2.16	0.65	5.58	3.22	1.69	1/2	1 1/8	2.9	5.23	2.07	2.77	1.93	200	2.9	
8-212-025	2.5	7/8	1.46	9UNC	1.97	2.12	2.24	0.65	5.58	3.22	1.69	5/8	1 5/16	2.9	5.23	2.07	2.69	1.93	250	2.8	
8-212-040	4	1	1.61	8UNC	1.91	2.13	2.34	0.65	5.62	3.22	1.73	5/8	1 1/2	2.87	5.26	2.09	2.63	1.77	400	4.3	
8-212-050	5	1 1/4	2.11	7UNC	2.36	2.56	3.21	0.89	6.7	3.9	2.42	7/8	1 7/8	3.14	6	2.53	2.6	2.32	500	6.8	
8-212-080	8	1 1/2	2.44	6UNC	3.03	3.35	4.01	1.04	8.85	4.88	3.07	1	2 1/4	4.42	8.04	3.15	3.8	2.72	800	12.9	
8-212-150	15	1 3/4	2.6	5UNC	3.74	4.09	4.41	1.42	10.16	6.22	3.39	1	2 5/8	5	9.01	3.85	4.33	3.86	1500	24.5	
8-212-200	20	2	2.8	4.5UNC	3.74	4.09	4.72	1.42	10.24	6.22	3.54	1 1/4	3	4.94	9.07	3.88	4.09	3.86	2000	27.2	

* Design Factor 4:1
* Bolt in GEOMET[®] finished on request



Kind of attachment																
	Number of legs	Load direction	Number of legs	Load direction	Number of legs	Load direction	Number of legs	Load direction	Number of legs	Load direction	Number of legs	Load direction	Number of legs	Load direction	Number of legs	Load direction
Item No.	Thread	WLL(t)														
8-212-010	1/2	1	2	1	2	1.4	1	1	2.1	1.5	1					
8-212-015	5/8	1.5	3	1.5	3	2.1	1.5	1.5	3.1	2.2	1.5					
8-212-020	3/4	2.5	5	2.5	5	3.5	2.5	2.5	5.2	3.7	2.5					
8-212-025	7/8	2.5	5	2.5	5	3.5	2.5	2.5	5.2	3.7	2.5					
8-212-040	1	4	8	4	8	5.6	4	4	8.4	6	4					
8-212-050	1 1/4	5	10	5	10	7	5	5	10.5	7.5	5					
8-212-080	1 1/2	8	16	8	16	11.2	8	8	16.8	12	8					
8-212-150	1 3/4	15	30	15	30	21	15	15	31.5	22.5	15					
8-212-200	2	20	40	20	40	28	20	20	42	30	20					

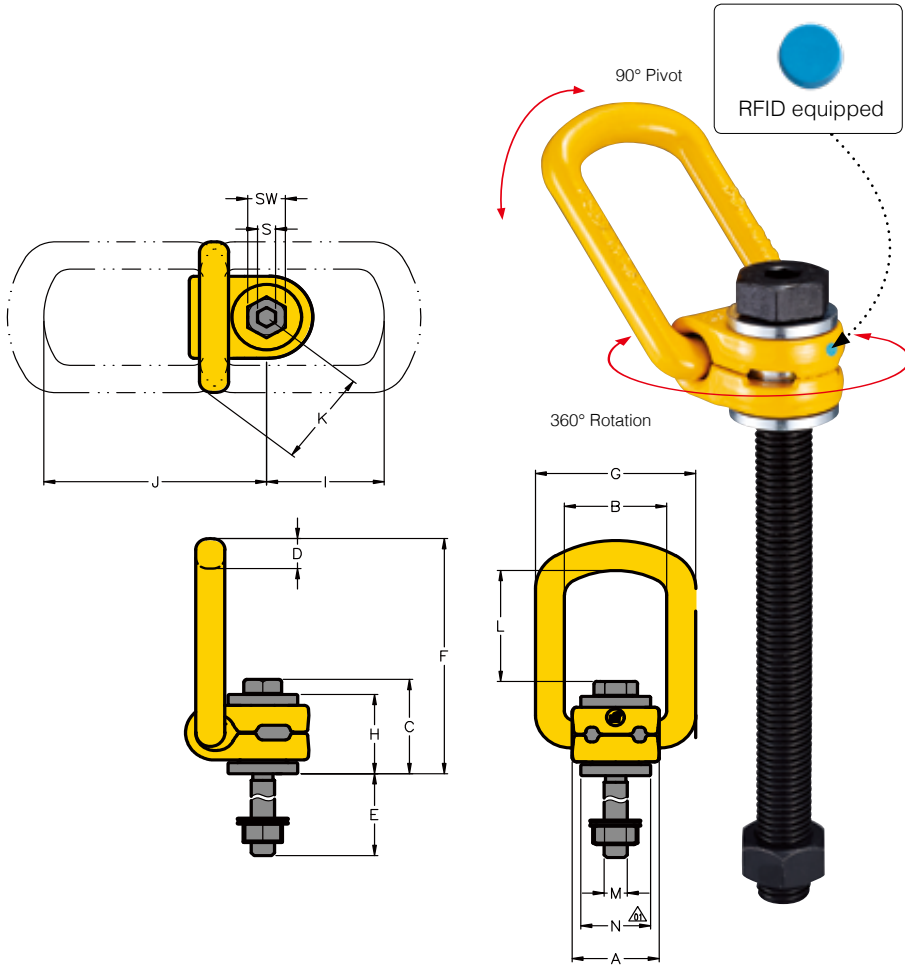

- Rotates through 360° and pivots 90°.
- Manufactured from alloy steel, quenched and tempered.
- Tested in accordance with EN1677-1.
- Load rated parts are 100% magnaflux crack detected.
- Individual forged parts and cap screw are traceable to Test Certification.
- Bolts are Metric thread.
- Proof tested to 2.5 times the WLL.
- Fatigue rated to 20,000 cycles at 1.5 times the WLL.
- All YOKE Lifting points meet or exceed all the requirements of ASME B30.26.
- Quick and simple assembly, just a tapped hole is required.

» Taiwan Patent
» China Patent

Lifting Point Long Bolt

Metric Thread (8-211L)



Item No.	Working Load Limit tonnes	Thread version			Dimensions														Torque in Nm	N.W. kg
		M	E	Pitch	A	B	C	D	F	G	H	S	SW	I	J	K	L	N		
		mm DIN13			mm															
8-211-003/105L	0.3	M 8	76	1.25	30	35	35	11	86	55	29	6	13	41	77	34	41	24	30	0.4
8-211-006/125L	0.63	M 10	96	1.5	30	35	36	11	86	55	29	6	17	42	78	34	40	24	60	0.4
8-211-010/150L	1	M 12	114	1.75	33	38	44	14	99	57	36	8	19	44	89	38	42	31	100	0.5
8-211-015/185L	1.5	M 16	149	2	33	38	46	14	99	57	36	10	24	45	89	38	40	31	150	0.7
8-211-025/230L	2.5	M 20	187	2.5	50	54	56	16	142	82	43	12	30	74	132	53	70	49	250	1.7
8-211-040/265L	4	M 24	221	3	50	54	59	16	143	82	44	14	36	74	132	53	67	45	400	2
8-211-050/340L	5	M 30	279	3.5	60	65	81	23	170	99	62	17	46	80	153	64	67	59	500	2.9
8-211-080/300L	8	M 36	222	4	77	85	101	27	225	124	78	22	55	112	205	80	97	69	800	6.9
8-211-100/350L	10	M 42	272	4.5	77	85	104	27	225	124	78	24	65	113	204	79	94	69	1000	7.9
8-211-150/350L	15	M 42	264	4.5	95	104	112	36	258	158	86	24	65	127	229	98	110	98	1500	13.5
8-211-200/385L	20	M 48	295	5	95	104	120	36	260	158	90	27	75	126	230	99	104	98	2000	15.5

* Design Factor 4:1
* Bolt in GEOMET[®] finished on request



Kind of attachment											
Number of legs	Load direction	1	2	1	2	2	2	2	3-4	3-4	3-4
Item No.	Thread	0°	0°	90°	90°	0-45°	45° - 60°	unsymm.	0 - 45°	45° - 60°	unsymm.
		WLL(t)									
8-211-003/105L	M 8	0.3	0.6	0.3	0.6	0.42	0.3	0.3	0.63	0.45	0.3
8-211-006/125L	M10	0.63	1.26	0.63	1.26	0.88	0.63	0.63	1.32	0.95	0.63
8-211-010/150L	M12	1	2	1	2	1.4	1	1	2.1	1.5	1
8-211-015/185L	M16	1.5	3	1.5	3	2.1	1.5	1.5	3.1	2.2	1.5
8-211-025/230L	M20	2.5	5	2.5	5	3.5	2.5	2.5	5.2	3.7	2.5
8-211-040/265L	M24	4	8	4	8	5.6	4	4	8.4	6	4
8-211-050/340L	M30	5	10	5	10	7	5	5	10.5	7.5	5
8-211-080/300L	M36	8	16	8	16	11.2	8	8	16.8	12	8
8-211-100/350L	M42	10	20	10	20	14	10	10	21	15	10
8-211-150/350L	M42	15	30	15	30	21	15	15	31.5	22.5	15
8-211-200/385L	M48	20	40	20	40	28	20	20	42	30	20

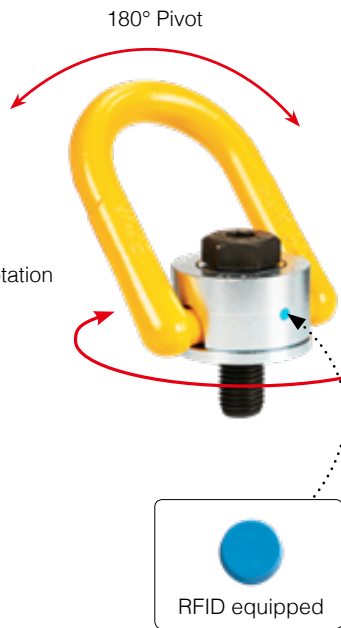
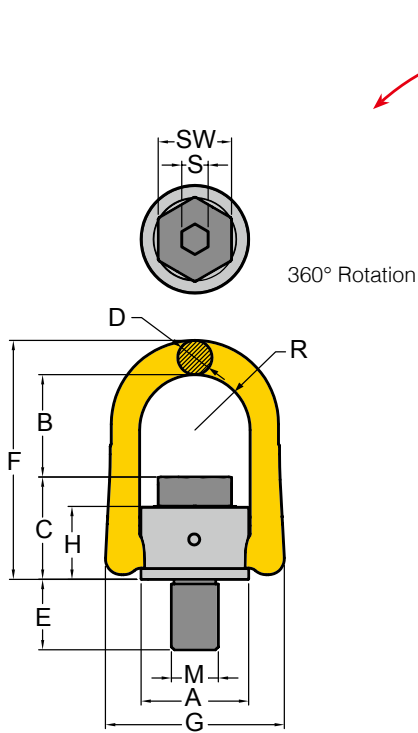

- Rotates through 360° and pivots 180°, and simultaneously allows lifting from any direction.
- Manufactured from forged alloy steel, quenched and tempered.
- Tested in accordance with EN1677-1.
- Load rated parts are 100% magnaflux crack detected.
- Individual forged parts and cap screw are traceable to Test Certification.
- Bolts are Metric thread.
- Proof tested to 2.5 times the WLL.
- Fatigue rated to 20,000 cycles at 1.5 times the WLL.
- All YOKE Lifting points meet or exceed all the requirements of ASME B30.26.
- Quick and simple assembly, just a tapped hole is required.

» Taiwan Patent
» China Patent

Anchor Point

Metric Thread (8-231)



Item No.	Working Load Limit	Thread version		Dimensions											Torque in	N.W.	
		M	E	Pitch	A	B	C	D	F	G	H	R	S	SW			Nm
	tonnes	mm	mm	DIN13													
8-231-005	0.5	M 8	12	1.25	33	42	28	11	80	58	23	17	6	13	30	0.3	
8-231-007	0.7	M 10	15	1.5	33	41	29	11	80	58	23	17	6	17	60	0.3	
8-231-010	1.0	M 12	20	1.75	33	40	31	11	80	58	23	17	8	19	100	0.3	
8-231-015	1.5	M 14	21	2	50	56	45	17	117	90	36	27	10	22	120	0.9	
8-231-020	2.0	M 16	24	2	50	54	46	17	117	90	36	27	10	24	150	0.9	
8-231-025	2.5	M 18	26	2.5	65	78	57	20	153	108	44	34	12	30	200	1.9	
8-231-030	3.0	M 20	30	2.5	50	52	49	17	117	90	36	27	12	30	250	1.0	
8-231-050	5.0	M 24	36	3	72	81	59	25	163	125	44	37	14	36	400	2.6	
8-231-056	5.6	M 27	38	3	87	86	79	30	204	148	62	46	17	41	400	4.9	
8-231-078	7.8	M 30	48	3.5	87	94	81	30	204	148	62	46	17	46	500	5.0	
8-231-125	12.5	M 36	54	4	110	112	98	36	247	188	75	57	22	55	1000	9.6	
8-231-156	15.6	M 42	63	4.5	110	101	108	36	247	188	83	57	24	65	1500	10.9	
8-231-200	20.0	M 48	72	5	110	97	113	36	248	188	83	57	27	75	2000	11.6	
8-231-220	22.0	M 56	84	5.5	123	116	121	36	274	202	91	64	27	85	2100	15.0	
8-231-225	22.5	M 64	100	6	123	111	126	36	274	202	91	64	32	95	2200	16.3	

* Design Factor 4:1



Kind of attachment											
Number of legs	Load direction	1	2	1	2	2	2	2	3-4	3-4	3-4
Item No.	Thread	0°	0°	90°	90°	0-45°	45° - 60°	unsymm.	0 - 45°	45° - 60°	unsymm.
		WLL(t)									
8-231-005	M 8	0.8	1.6	0.5	1	0.7	0.5	0.5	1.1	0.8	0.5
8-231-007	M10	1.2	2.4	0.7	1.4	1	0.7	0.7	1.5	1.1	0.7
8-231-010	M12	1.5	3	1	2	1.4	1	1	2.1	1.5	1
8-231-015	M14	2.4	4.8	1.5	3	2.1	1.5	1.5	3.2	2.3	1.5
8-231-020	M16	3.2	6.4	2	4	2.8	2	2	4.2	3	2
8-231-025	M18	5	10	2.5	5	3.5	2.5	2.5	5.3	3.8	2.5
8-231-030	M20	4.5	9	3	6	4.2	3	3	6.3	4.5	3
8-231-050	M24	9	18	5	10	7	5	5	10.5	7.5	5
8-231-056	M27	9.5	19	5.6	11.2	7.8	5.6	5.6	11.8	8.4	5.6
8-231-078	M30	12	24	7.8	15.6	10.9	7.8	7.8	16.4	11.7	7.8
8-231-125	M36	14	28	12.5	25	17.5	12.5	12.5	26.3	18.8	12.5
8-231-156	M42	16	32	15.6	31.2	21.8	15.6	15.6	32.8	23.4	15.6
8-231-200	M48	20	40	20	40	28	20	20	42	30	20
8-231-220	M56	22	44	22	44	30.8	22	22	46.2	33	22
8-231-225	M64	22.5	45	22.5	45	31.5	22.5	22.5	47.25	33.75	22.5

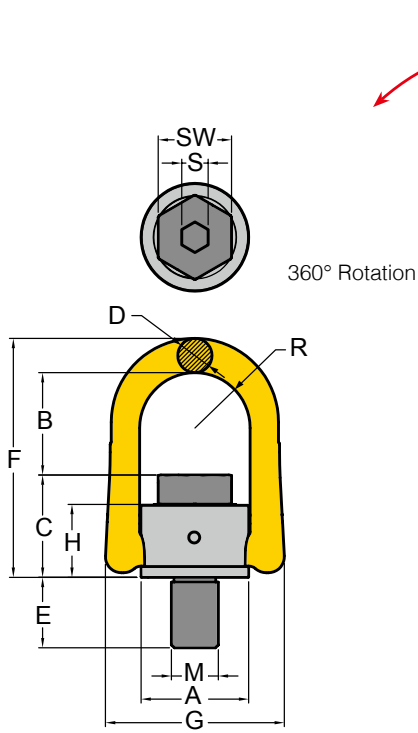

- Rotates through 360° and pivots 180°, and simultaneously allows lifting from any direction.
- Manufactured from forged alloy steel, quenched and tempered.
- Tested in accordance with EN1677-1.
- Load rated parts are 100% magnaflux crack detected.
- Individual forged parts and cap screw are traceable to Test Certification.
- Bolts are UNC thread.
- Proof tested to 2.5 times the WLL.
- Fatigue rated to 20,000 cycles at 1.5 times the WLL.
- All YOKE Lifting points meet or exceed all the requirements of ASME B30.26.
- Quick and simple assembly, just a tapped hole is required.

» Taiwan Patent
» China Patent

Anchor Point

UNC Thread (8-232)



Item No.	Working Load Limit	Thread version			Dimensions										Torque in	N.W.
		M	E	TPI	A	B	C	D	F	G	H	R	S	SW		
	tonnes	inch	inch		inch										Nm	lbs
8-232-010	0.8	1/2	0.81	13 UNC	1.3	1.57	1.20	0.41	3.17	2.28	0.90	0.67	5/16	3/4	100	1.8
8-232-020	1.6	5/8	1.13	11 UNC	1.97	2.13	1.81	0.65	4.61	3.54	1.42	1.06	3/8	15/16	150	2.0
8-232-030	2.4	3/4	1.54	10 UNC	1.97	2.07	1.89	0.65	4.61	3.54	1.42	1.06	1/2	1 1/8	250	2.2
8-232-038	3.0	7/8	1.42	9 UNC	2.56	2.99	2.28	0.79	6.02	4.25	1.73	1.34	5/8	15/16	300	4.3
8-232-050	4.0	1	1.61	8 UNC	2.81	3.17	2.34	0.98	6.38	4.92	1.73	1.46	5/8	1 1/2	400	5.7
8-232-078	6.25	1 1/4	2.09	7 UNC	3.43	3.66	2.23	1.18	8.07	5.83	2.44	1.79	7/8	17/8	500	11.0
8-232-125	10.0	1 1/2	2.40	6 UNC	4.29	4.38	3.87	1.42	9.92	7.40	3.07	2.22	1	21/4	800	21.2
8-232-200	16.0	2	3.00	4.5 UNC	4.61	3.80	4.46	1.42	9.93	7.71	3.35	2.38	11/4	3	2000	25.6

* Design Factor 5:1



Kind of attachment																				
	Number of legs	Load direction	Item No.	Thread	WLL(t)	WLL(t)	WLL(t)	WLL(t)	WLL(t)	WLL(t)	WLL(t)	WLL(t)	WLL(t)	WLL(t)	WLL(t)	WLL(t)	WLL(t)	WLL(t)	WLL(t)	WLL(t)
8-232-010	1/2	1.2	2.4	0.8	1.6	1.12	0.8	0.8	1.68	1.2	0.8									
8-232-020	5/8	2.6	5.2	1.6	3.2	2.24	1.6	1.6	3.36	2.4	1.6									
8-232-030	3/4	3.6	7.2	2.4	4.8	3.36	2.4	2.4	5.04	3.6	2.4									
8-232-038	7/8	4.5	9	3	6	4.2	3	3	6.3	4.5	3									
8-232-050	1	7.2	14.4	4	8	5.6	4	4	8.4	6	4									
8-232-078	1 1/4	9.6	19.2	6.25	12.5	8.75	6.25	6.25	13.13	9.38	6.25									
8-232-125	1 1/2	11	22	10	20	14	10	10	21	15	10									
8-232-200	2	16	32	16	32	22.4	16	16	33.6	24	16									

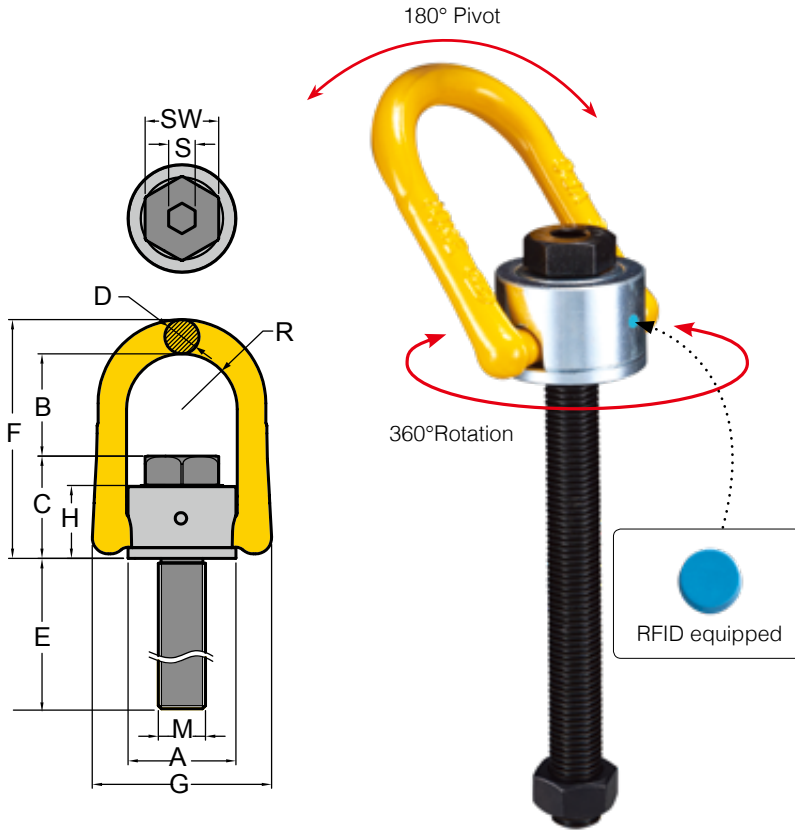

- Rotates through 360° and pivots 180°, and simultaneously allows lifting from any direction.
- Manufactured from forged alloy steel, quenched and tempered.
- Tested in accordance with EN1677-1.
- Load rated parts are 100% magnaflux crack detected.
- Individual forged parts and cap screw are traceable to Test Certification.
- Bolts are Metric thread.
- Proof tested to 2.5 times the WLL.
- Fatigue rated to 20,000 cycles at 1.5 times the WLL.
- All YOKE Lifting points meet or exceed all the requirements of ASME B30.26.
- Quick and simple assembly, just a tapped hole is required.

» Taiwan Patent
» China Patent

Anchor Point Long Bolt

Metric Thread (8-231L)



Item No.	Working Load Limit	Thread version			Dimensions										Torque in		N.W.
		M	E	Pitch	A	B	C	D	F	G	H	R	S	SW	Nm	kg	
	tonnes	mm	mm	DIN13													
8-231-005/105L	0.5	M 8	83	1.25	33	42	28	11	80	58	23	17	6	13	30	0.3	
8-231-007/125L	0.7	M 10	103	1.5	33	41	29	11	80	58	23	17	6	17	60	0.4	
8-231-010/150L	1.0	M 12	128	1.75	33	40	31	11	80	58	23	17	8	19	100	0.4	
8-231-020/185L	2.0	M 16	149	2	50	54	46	17	117	90	36	27	10	24	150	1.1	
8-231-030/230L	3.0	M 20	194	2.5	50	52	49	17	117	90	36	27	12	30	250	1.4	
8-231-050/265L	5.0	M 24	221	3	72	81	59	25	163	125	44	37	14	36	400	3.2	
8-231-078/340L	7.8	M 30	278	3.5	87	94	81	30	204	148	62	46	17	46	500	6.3	
8-231-125/300L	12.5	M 36	225	4	110	112	98	36	247	188	75	57	22	55	1000	10.9	
8-231-156/350L	15.6	M 42	268	4.5	110	101	108	36	247	188	83	57	24	65	1500	13.9	
8-231-200/385L	20.0	M 48	303	5	110	97	113	36	248	188	83	57	27	75	2000	14.7	

* Design Factor 4:1



Kind of attachment											
Number of legs	Load direction	1	2	1	2	2	2	2	3-4	3-4	3-4
Item No.	Thread	0°	0°	90°	90°	0-45°	45° - 60°	unsymm.	0 - 45°	45° - 60°	unsymm.
		WLL(t)									
8-231-005/105L	M 8	0.8	1.6	0.5	1	0.7	0.5	0.5	1.1	0.8	0.5
8-231-007/125L	M10	1.2	2.4	0.7	1.4	1	0.7	0.7	1.5	1.1	0.7
8-231-010/150L	M12	1.5	3	1	2	1.4	1	1	2.1	1.5	1
8-231-020/185L	M16	3.2	6.4	2	4	2.8	2	2	4.2	3	2
8-231-030/230L	M20	4.5	9	3	6	4.2	3	3	6.3	4.5	3
8-231-050/265L	M24	9	18	5	10	7	5	5	10.5	7.5	5
8-231-078/340L	M30	12	24	7.8	15.6	10.9	7.8	7.8	16.4	11.7	7.8
8-231-125/300L	M36	14	28	12.5	25	17.5	12.5	12.5	26.3	18.8	12.5
8-231-156/350L	M42	16	32	15.6	31.2	21.8	15.6	15.6	32.8	23.4	15.6
8-231-200/385L	M48	20	40	20	40	28	20	20	42	30	20

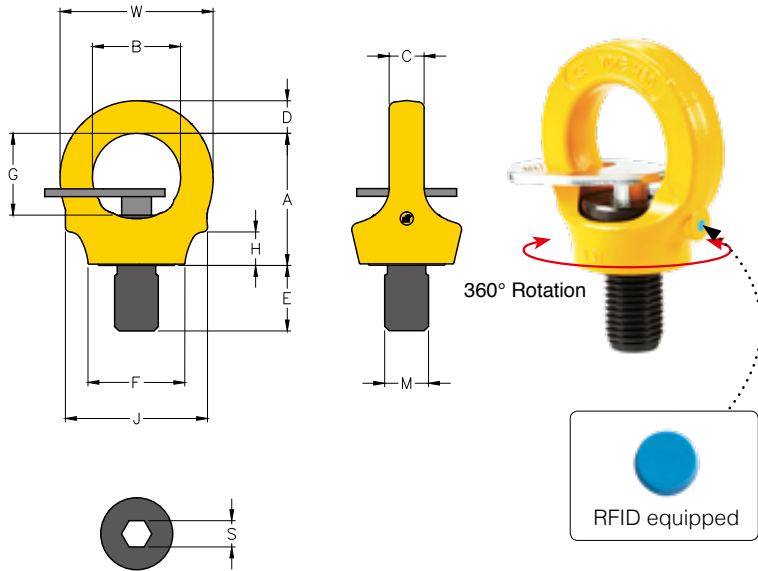

- Rotates through 360° adjustable in the direction of the load.
- Manufactured from alloy steel, quenched and tempered.
- Tested in accordance with EN1677-1.
- Certified by DGUV GS-OA 15-04
- Load rated parts are 100% magnaflux crack detected.
- Individual forged parts and cap screw are traceable to Test Certification.
- Bolts are Metric thread.
- Proof tested to 2.5 times the WLL.
- Fatigue rated to 20,000 cycles at 1.5 times the WLL.
- All YOKE Lifting points meet or exceed all the requirements of ASME B30.26.
- Quick and simple assembly, just a tapped hole is required.

- » Taiwan Patent
- » China Patent
- » French Patent
- » Australian Patent
- » Mexican Patent
- » Japanese Patent

Key Eye Point

Metric Thread (8-291K)



Item No.	Working Load Limit tonnes	Thread version			Dimensions										Torque in Nm	N.W. kg
		M	E	Pitch	A	B	C	D	F	G	H	J	S	W		
		mm	mm	DIN13	mm											
8-291K-001	0.1 NEW	M 6	9	1	30	20	7	7	23	19	4	33	6	34	5	0.1
8-291K-003	0.3	M 8	12	1.25	38	25	9	9	25	24	6	41	6	44	10	0.1
8-291K-004	0.4	M 10	15	1.5	38	25	9	9	25	24	6	41	6	44	10	0.1
8-291K-007	0.75	M 12	18	1.75	45	30	10	11	33	30	9	47	8	52	10	0.2
8-291K-015	1.5	M 16	24	2	52	35	14	13	35	34	11	56	10	61	30	0.4
8-291K-023	2.3	M 20	30	2.5	60	40	16	15	44	37	15	65	12	70	70	0.6
8-291K-032	3.2	M 24	36	3	72	49	19	18	53	47	19	78	14	84	150	1.1
8-291K-045	4.5	M 30	45	3.5	91	61	24	22	62	59	23	95	17	105	350	2.1
8-291K-070	7.0	M 36	54	4	110	73	29	27	76	72	31	114	22	126	410	3.7
8-291K-090	9.0	M 42	63	4.5	128	83	34	32	89	81	38	132	24	147	550	5.8
8-291K-120	12.0	M 48	72	5	145	95	38	37	105	94	44	150	27	168	550	8.6
8-291K-140	16.0	M 56	84	5.5	148	102	40	43	124	92	49	166	27	178	800	11.0
8-291K-150	18.0	M 64	96	6	148	102	40	43	124	92	49	166	27	178	800	11.8

* Design Factor 4:1



Kind of attachment	1 leg		2 legs (A)		2 legs (B)		2 legs (C)		3-4 legs (D)		3-4 legs (E)	
	G	G	G	G	G	G	G	G	G	G	G	G
Number of legs	1	2	1	2	2	2	2	2	3-4	3-4	3-4	3-4
Load direction	0°	0°	90°	90°	0-45°	45° - 60°	unsymm.	unsymm.	0 - 45°	45° - 60°	unsymm.	unsymm.
Item No.	Thread	WLL(t)										
8-291K-001	M 6 NEW	0.5	1	0.1	0.2	0.14	0.1	0.1	0.21	0.15	0.1	0.1
8-291K-003	M 8	1	2	0.3	0.6	0.42	0.3	0.3	0.63	0.45	0.3	0.3
8-291K-004	M10	1	2	0.4	0.8	0.56	0.4	0.4	0.84	0.6	0.4	0.4
8-291K-007	M12	2	4	0.75	1.5	1	0.75	0.75	1.58	1.12	0.75	0.75
8-291K-015	M16	4	8	1.5	3	2.1	1.5	1.5	3.15	2.25	1.5	1.5
8-291K-023	M20	6	12	2.3	4.6	3.2	2.3	2.3	4.8	3.4	2.3	2.3
8-291K-032	M24	8	16	3.2	6.4	4.5	3.2	3.2	6.7	4.8	3.2	3.2
8-291K-045	M30	12	24	4.5	9	6.3	4.5	4.5	9.4	6.7	4.5	4.5
8-291K-070	M36	16	32	7	14	9.8	7	7	14.7	10.5	7	7
8-291K-090	M42	24	48	9	18	12.6	9	9	18.9	13.5	9	9
8-291K-120	M48	32	64	12	24	16.8	12	12	25.2	18	12	12
8-291K-140	M56	34	68	16	32	22.4	16	16	33.6	24	16	16
8-291K-150	M64	36	72	18	36	25.2	18	18	37.8	27	18	18

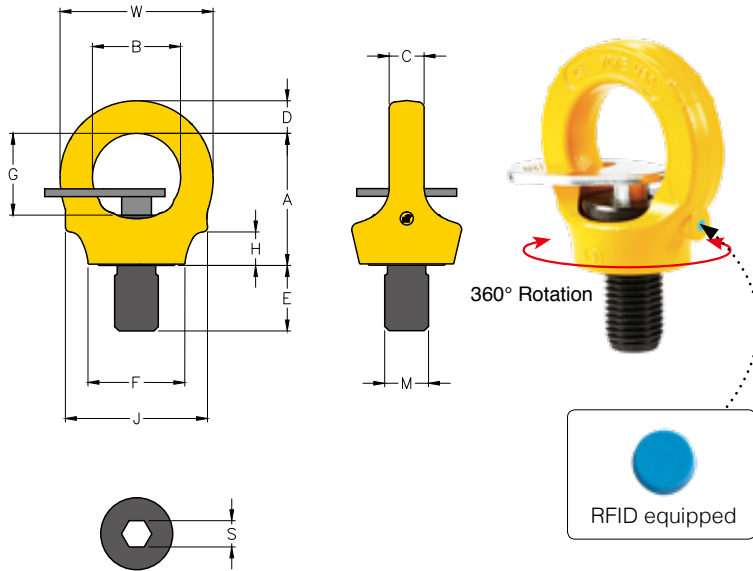

- Rotates through 360° adjustable in the direction of the load.
 - Manufactured from alloy steel, quenched and tempered.
 - Tested in accordance with EN1677-1.
 - Load rated parts are 100% magnaflux crack detected.
 - Individual forged parts and cap screw are traceable to Test Certification.
 - Bolts are UNC thread.
 - Proof tested to 2.5 times the WLL.
 - Fatigue rated to 20,000 cycles at 1.5 times the WLL.
 - All YOKE Lifting points meet or exceed all the requirements of ASME B30.26.
 - Quick and simple assembly, just a tapped hole is required.
- » Taiwan Patent
 - » China Patent
 - » French Patent
 - » Australian Patent
 - » Mexican Patent
 - » Japanese Patent

Key Eye Point

UNC Thread (8-292K)



Item No.	Working Load Limit tonnes	Thread version			Dimensions										Torque in Nm	N.W. w/ Key lbs
		M	E	TPI	A	B	C	D	F	G	H	J	S	W		
		inch	inch		inch	inch	inch	inch	inch	inch	inch	inch	inch	inch	inch	inch
8-292K-003	0.3	5/16	0.47	18UNC	1.49	1.00	0.33	0.37	0.99	0.92	0.24	1.60	0.25	1.73	10	0.3
8-292K-004	0.4	3/8	0.55	16UNC	1.49	1.00	0.33	0.37	0.99	0.92	0.24	1.60	0.25	1.73	10	0.3
8-292K-007	0.75	1/2	0.75	13UNC	1.79	1.19	0.39	0.43	1.30	1.16	0.37	1.85	0.31	2.05	10	0.5
8-292K-015	1.5	5/8	0.94	11UNC	2.06	1.39	0.55	0.51	1.38	1.32	0.45	2.20	0.37	2.40	30	0.9
8-292K-023	2.3	3/4	1.14	10UNC	2.38	1.59	0.63	0.58	1.74	1.47	0.60	2.56	0.5	2.76	70	1.4
8-292K-025	2.3	7/8	1.30	9UNC	2.38	1.59	0.63	0.58	1.74	1.47	0.60	2.56	0.5	2.76	150	1.5
8-292K-032	3.2	1	1.52	8UNC	2.85	1.91	0.75	0.70	2.08	1.79	0.75	3.07	0.56	3.31	150	2.5
8-292K-045	4.5	1 1/4	1.89	7UNC	3.57	2.38	0.94	0.88	2.43	2.23	0.91	3.75	0.63	4.13	350	4.7
8-292K-070	7	1 1/2	2.24	6UNC	4.32	2.85	1.14	1.05	2.99	2.71	1.20	4.49	0.87	4.96	410	8.7
8-292K-090	9	1 3/4	2.64	5UNC	5.02	3.26	1.34	1.26	3.51	3.09	1.50	5.20	1.00	5.79	550	12.7
8-292K-120	12	2	3.03	4.5UNC	5.70	3.74	1.50	1.44	4.12	3.69	1.75	5.91	1.00	6.61	550	19.6

*Design Factor 4:1



Kind of attachment											
Number of legs	Load direction	1	2	1	2	2	2	2	3-4	3-4	3-4
Item No.	Thread	WLL(t)									
8-292K-003	5/16	1	2	0.3	0.6	0.42	0.3	0.3	0.63	0.45	0.3
8-292K-004	3/8	1	2	0.4	0.8	0.56	0.4	0.4	0.8	0.6	0.4
8-292K-007	1/2	2	4	0.75	1.5	1	0.75	0.75	1.5	1.1	0.75
8-292K-015	5/8	4	8	1.5	3	2.1	1.5	1.5	3.1	2.2	1.5
8-292K-023	3/4	6	12	2.3	4.6	3.2	2.3	2.3	4.8	3.4	2.3
8-292K-025	7/8	6	12	2.3	4.6	3.2	2.3	2.3	4.8	3.4	2.3
8-292K-032	1	8	16	3.2	6.4	4.5	3.2	3.2	6.7	4.8	3.2
8-292K-045	1 1/4	12	24	4.5	9	6.3	4.5	4.5	9.4	6.7	4.5
8-292K-070	1 1/2	16	32	7	14	9.8	7	7	14.7	10.5	7
8-292K-090	1 3/4	24	48	9	18	12.6	9	9	18.9	13.5	9
8-292K-120	2	32	64	12	24	16.8	12	12	25	18	12

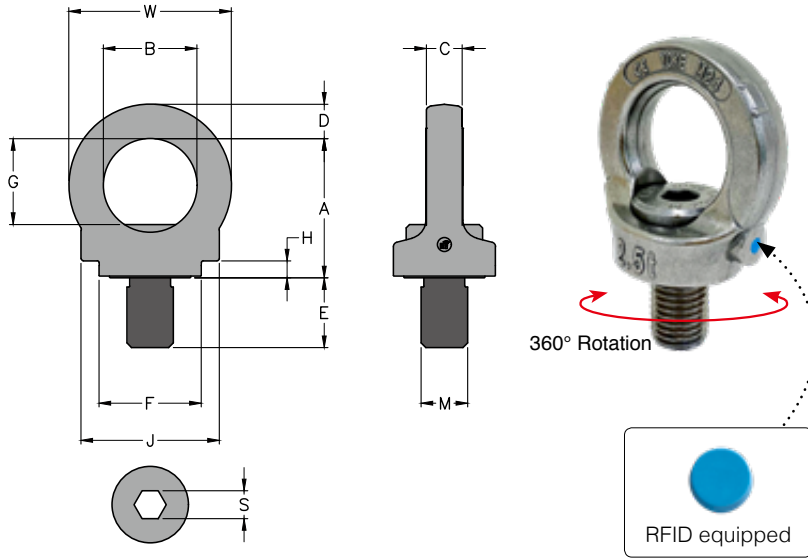

- Rotates through 360° adjustable in the direction of the load.
- Manufactured from stainless steel.
- Tested in accordance with EN1677-1.
- Individual forged parts and cap screw are traceable to Test Certification.
- Bolts are Metric thread.
- Proof tested to 2.5 times the WLL.
- Fatigue rated to 20,000 cycles at 1.5 times the WLL.
- All YOKE Lifting points meet or exceed all the requirements of ASME B30.26.
- Quick and simple assembly, just a tapped hole is required.
- Used in different applications such as chemical oil coal industries, food processing, clean room and precision instrument.

- » Taiwan Patent
- » China Patent
- » French Patent
- » Australian Patent
- » Mexican Patent
- » Japanese Patent

Stainless Steel Eye Point

Metric Thread (8-S291)



Item No.	Working Load Limit	Thread version			Dimensions										Torque in Nm	N.W. kg
		M	E	Pitch	A	B	C	D	F	G	H	J	S	W		
	tonnes	mm	mm	DIN13	mm											
8-S291-005	0.5	M 12	18	1.75	45	30	10	11	33	29	5	44	8	52	10	0.2
8-S291-010	1.0	M 16	24	2	52	35	14	13	35	33	5	51	10	61	30	0.3
8-S291-020	2.0	M 20	30	2.5	60	40	16	15	44	37	7	60	12	70	70	0.6
8-S291-025	2.5	M 24	36	3	72	49	19	18	52	46	10	72	14	84	150	1.0

* Design Factor 4:1



Kind of attachment																
	Number of legs	Load direction	Item No.	Thread	WLL(t)											
8-S291-005	M12	1.2	2.4	0.5	1	0.7	0.5	0.5	1	0.7	0.5	1	0.7	0.5		
8-S291-010	M16	2.4	4.8	1	2	1.4	1	1	2.1	1.5	1	2.1	1.5	1		
8-S291-020	M20	3.6	7.2	2	4	2.8	2	2	4.2	3	2	4.2	3	2		
8-S291-025	M24	5.2	10.4	2.5	5	3.5	2.5	2.5	5.3	3.7	2.5	5.3	3.7	2.5		

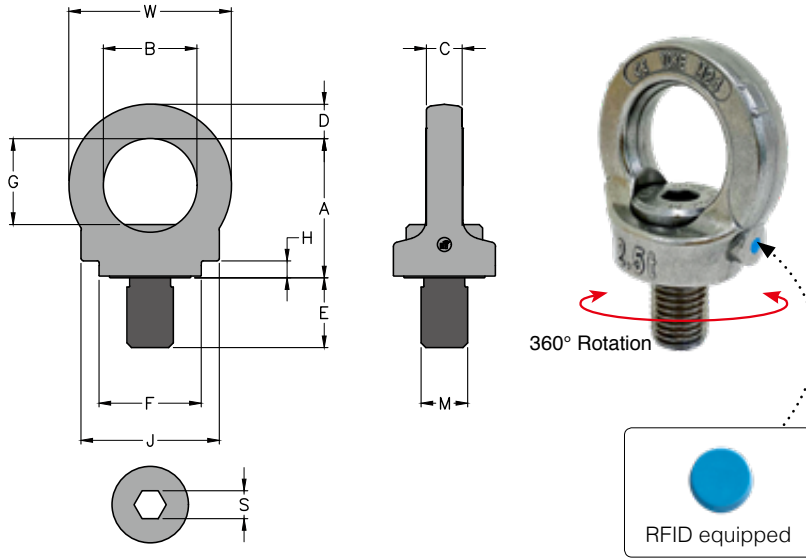

- Rotates through 360° adjustable in the direction of the load.
- Manufactured from stainless steel.
- Tested in accordance with EN1677-1.
- Individual forged parts and cap screw are traceable to Test Certification.
- Bolts are UNC thread.
- Proof tested to 2.5 times the WLL.
- Fatigue rated to 20,000 cycles at 1.5 times the WLL.
- All YOKE Lifting points meet or exceed all the requirements of ASME B30.26.
- Quick and simple assembly, just a tapped hole is required.
- Used in different applications such as chemical oil coal industries, food processing, clean room and precision instrument.

- » Taiwan Patent
- » China Patent
- » French Patent
- » Australian Patent
- » Mexican Patent
- » Japanese Patent

Stainless Steel Eye Point

UNC Thread (8-S292)



Item No.	Working Load Limit	Thread version			Dimensions										Torque		N.W.
		M	E	TPI	A	B	C	D	F	G	H	J	S	W	in	lbs	
	tonnes	inch	inch		inch										Nm	lbs	
8-S292-005	0.5	1/2	0.75	13UNC	1.77	1.18	0.39	0.43	1.3	1.14	0.31	2.05	8	52	10	0.4	
8-S292-010	1	5/8	0.94	11UNC	2.05	1.38	0.55	0.51	1.38	1.3	0.37	2.4	10	61	30	0.7	
8-S292-020	2	3/4	1.13	10UNC	2.36	1.57	0.63	0.59	1.73	1.46	0.5	2.76	12	70	70	1.3	
8-S292-025	2.5	1	1.5	8UNC	2.83	1.89	0.75	0.71	2.05	1.81	0.56	3.31	14	84	150	2.2	

* Design Factor 4:1



Kind of attachment											
Number of legs		1	2	1	2	2	2	2	3-4	3-4	3-4
Load direction		0°	0°	90°	90°	0-45°	45° - 60°	unsymm.	0 - 45°	45° - 60°	unsymm.
Item No.	Thread	WLL(t)									
8-S292-005	1/2	1.2	2.4	0.5	1	0.7	0.5	0.5	1	0.7	0.5
8-S292-010	5/8	2.4	4.8	1	2	1.4	1	1	2.1	1.5	1
8-S292-020	3/4	3.6	7.2	2	4	2.8	2	2	4.2	3	2
8-S292-025	1	5.2	10.4	2.5	5	3.5	2.5	2.5	5.3	3.7	2.5

YOKE



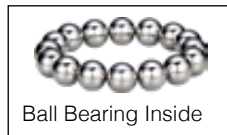
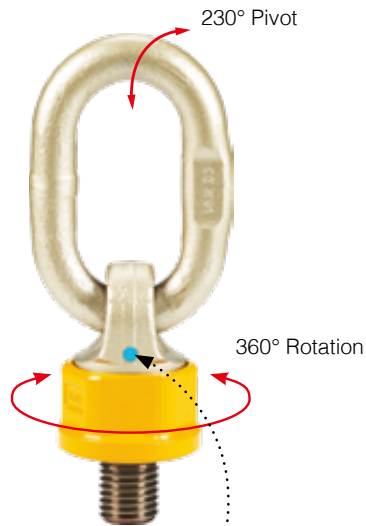
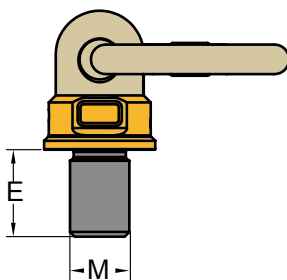
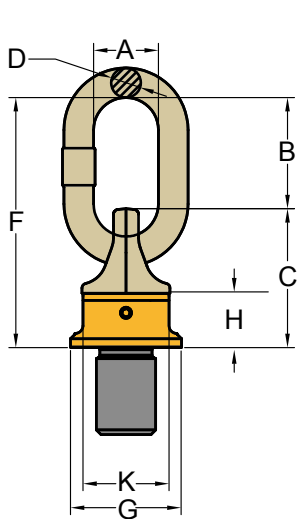

- Pivots to 230°, rotates through 360° due to its unique ball bearing design.
- Manufactured from forged alloy steel, quenched and tempered.
- Tested in accordance with EN1677-4.
- All YOKE Lifting points meet or Certified by DGUV GS-OA-15-04.
- Load rated parts are 100% magnaflux crack detected.
- Individual forged parts and batch code links to Test Certificate sheet.
- Bolts are Metric thread.
- Proof tested to 2.5 times the WLL.
- Fatigue rated to 20,000 cycles at 1.5 times the WLL.
- All YOKE Lifting points meet or exceed all the requirements of ASME B30.26.
- Easy to attach or dismantle due to the forged hexagon shaped body of the Super Point
- Capable of rotating under load. Do not turn continuously in 90 degree direction at full load.
- With the new WLL tables you can find the right Super Point attachment for your application and by the yellow marking on both sides you can measure disposal stage of the Super Point.

Super Point

Metric Thread (8-251)



Super Point

UNC Thread (8-252)



* Design Factor 4:1

Super Point

Metric Thread (8-251)

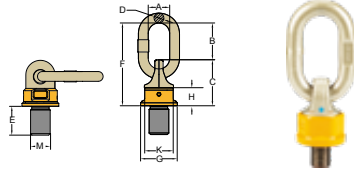

Item No.	Working Load Limit tonnes	Thread version			Dimensions								Torque in Nm	N.W. kg
		M	E	Pitch	G	C	K	H	F	D	B	A		
		mm	mm	DIN13	mm									
8-251-004-01	0.3	M 8	12	1.25	36.5	48	34	20.5	101	13	53	35	10 - 40	0.3
8-251-007-01	0.5	M10	18	1.5	36.5	48	34	20.5	101	13	53	35	10 - 40	0.4
8-251-007-02	0.7	M12	18	1.75	36.5	48	34	20.5	101	13	53	35	15 - 40	0.4
8-251-007-03	0.7	M12	25	1.75	36.5	48	34	20.5	101	13	53	35	15 - 40	0.4
8-251-007-04	1	M14	20	2	36.5	48	34	20.5	101	13	53	35	30 - 40	0.4
8-251-014-01	1.4	M16	20	2	36.5	48	34	20.5	101	13	53	35	45 - 130	0.44
8-251-014-02	1.4	M16	24	2	36.5	48	34	20.5	101	13	53	35	45 - 130	0.5
8-251-014-03	1.4	M16	30	2	36.5	48	34	20.5	101	13	53	35	45 - 130	0.5
8-251-014-04	1.7	M20	30	2.5	36.5	48	34	20.5	101	13	53	35	75 - 130	0.5
8-251-014-05	1.7	M24	30	3	36.5	48	34	20.5	101	13	53	35	90 - 130	0.5
8-251-025-01	2.5	M20	30	2.5	52	68	46	28	127	16	59	35	100 - 170	1
8-251-025-02	2.5	M20	40	2.5	52	68	46	28	127	16	59	35	100 - 170	1
8-251-025-03	2.5	M20	50	2.5	52	68	46	28	127	16	59	35	100 - 170	1.1
8-251-025-04	2.5	M20	70	2.5	52	68	46	28	127	16	59	35	100 - 170	1.1
8-251-040-01	4	M24	30	3	57	75	50	34.5	148	19	73	40	190 - 280	1.5
8-251-040-02	4	M24	36	3	57	75	50	34.5	148	19	73	40	190 - 280	1.5
8-251-040-03	4	M24	45	3	57	75	50	34.5	148	19	73	40	190 - 280	1.5
8-251-040-04	4	M24	50	3	57	75	50	34.5	148	19	73	40	190 - 280	1.5
8-251-040-05	4	M30	35	3.5	57	75	50	34.5	148	19	73	40	190 - 280	1.5
8-251-067-01	6.7	M30	35	3.5	70	95	65	41	163	19	68	40	230 - 400	2.4
8-251-067-02	6.7	M30	45	3.5	70	95	65	41	163	19	68	40	230 - 400	2.4
8-251-067-03	6.7	M30	50	3.5	70	95	65	41	163	19	68	40	230 - 400	2.5
8-251-067-04	6.7	M30	60	3.5	70	95	65	41	163	19	68	40	230 - 400	2.5
8-251-080-01	8	M30	35	3.5	81	106	75	48	201	22	95	50	270 - 600	3.6
8-251-080-02	8	M30	45	3.5	81	106	75	48	201	22	95	50	270 - 600	3.7
8-251-100-01	10	M36	50	4	81	106	75	48	201	22	95	50	270 - 600	3.8
8-251-100-02	10	M36	54	4	81	106	75	48	201	22	95	50	270 - 600	3.9
8-251-125-01	12.5	M42	50	4.5	81	106	75	48	201	22	95	50	270 - 700	3.9
8-251-125-02	12.5	M42	60	4.5	81	106	75	48	201	22	95	50	270 - 700	4
8-251-125-03	12.5	M42	63	4.5	81	106	75	48	201	22	95	50	270 - 700	4
8-251-125-04	12.5	M45	60	4.5	81	106	75	48	201	22	95	50	270 - 700	4.1
8-251-125-05	12.5	M48	72	5	81	106	75	48	201	22	95	50	270 - 700	4.4
8-251-170-01	13	M42	60	4.5	104	127	95	58	256	32	129	70	350 - 800	7.4
8-251-170-02	17	M45	60	4.5	104	127	95	58	256	32	129	70	350 - 800	7.5
8-251-170-03	17	M48	60	5	104	127	95	58	256	32	129	70	350 - 800	7.6
8-251-170-04	17	M48	72	5	104	127	95	58	256	32	129	70	350 - 800	7.7
8-251-170-045	17	M52	78	5	104	127	95	58	256	32	129	70	350 - 800	7.9
8-251-170-05	18	M56	78	5.5	104	127	95	58	256	32	129	70	350 - 900	8.1
8-251-170-06	18	M56	84	5.5	104	127	95	58	256	32	129	70	350 - 900	8.1
8-251-200-01	20	M64	96	6	104	127	95	58	256	32	129	70	350 - 900	8.9
8-251-200-02	20	M64	110	6	104	127	95	58	256	32	129	70	350 - 900	9.3
8-251-280-01	28	M64	96	6	129	174	115	78	305	36	131	80	500 - 1000	16.4
8-251-280-02	28	M72	120	6	129	174	115	78	305	36	131	80	500 - 1200	17.7
8-251-280-03	28	M80	150	6	129	174	115	78	305	36	131	80	500 - 1200	19.6
8-251-350-005	35	M72	108	6	148	187	135	85	366	45	179	100	500 - 1400	24.8
8-251-350-01	35	M80	120	6	148	187	135	85	366	45	179	100	500 - 1400	25.3
8-251-350-02	35	M90	150	6	148	187	135	85	366	45	179	100	500 - 1500	27.8
8-251-400-005	40	M72	108	6	170	210	145	83	340	45	130	90	500 - 1500	30.1
8-251-400-01	40	M80	120	6	170	210	145	83	340	45	130	90	500 - 1500	31.9
8-251-400-02	40	M90	115	6	170	210	145	83	340	45	130	90	500 - 1500	33.6
8-251-400-025	40	M90	135	6	170	210	145	83	340	45	130	90	500 - 1500	33.9
8-251-400-03	40	M90	150	6	170	210	145	83	340	45	130	90	500 - 1500	34.2
8-251-400-04	40	M100	150	6	170	210	145	83	340	45	130	90	500 - 1700	35.2



Kind of attachment																																																																																																																																																																																																																																																																																																																																																																																			
	Number of legs	Load direction	1	2	1	2	2	2	2	2	3-4	3-4	3-4	3-4	3-4	3-4	3-4	3-4	3-4	3-4																																																																																																																																																																																																																																																																																																																																																															
Item No.	Thread	WLL(t)																																																																																																																																																																																																																																																																																																																																																																																	
8-251-004	M8	0.6	1.2	0.3	0.6	0.4	0.3	0.3	0.6	0.45	0.3	8-251-007	M10	1	2	0.5	1	0.7	0.5	0.5	1	0.75	0.5	8-251-014	M12	1.4	2.8	0.7	1.4	1	0.7	0.7	1.4	1	0.7	8-251-025	M14	2	4	1	2	1.4	1	1	2.12	1.5	1	8-251-040	M16	2.8	5.6	1.4	2.8	2	1.4	1.4	3	2.12	1.4	8-251-067	M20	3.4	6.8	1.7	3.4	2.4	1.7	1.7	3.55	2.5	1.7	8-251-080	M24	3.4	6.8	1.7	3.4	2.4	1.7	1.7	3.55	2.5	1.7	8-251-100	M20	5	10	2.5	5	3.55	2.5	2.5	5.3	3.75	2.5	8-251-125	M24	8	16	4	8	5.6	4	4	8.5	6	4	8-251-170	M30	8	16	4	8	5.6	4	4	8.5	6	4	8-251-200	M30	12	24	6.7	13.4	9.5	6.7	6.7	14	10	6.7	8-251-280	M30	12	24	8	16	11.2	8	8	16	12	8	8-251-350	M36	15	30	10	20	14	10	10	21.2	15	10	8-251-400	M42	15	30	12.5	25	17	12.5	12.5	25	18	12.5	8-251-400	M45	15	30	12.5	25	17	12.5	12.5	25	18	12.5	8-251-400	M48	15	30	12.5	25	17	12.5	12.5	25	18	12.5	8-251-400	M42	20	40	13	26	18	13	13	27	19	13	8-251-400	M45	25	50	17	34	23.5	17	17	35	25	17	8-251-400	M48	25	50	17	34	23.5	17	17	35	25	17	8-251-400	M52	25	50	17	34	23.5	17	17	35	25	17	8-251-400	M56	25	50	18	36	25	18	18	37.5	26.5	18	8-251-400	M64	25	50	20	40	28	20	20	42.5	30	20	8-251-400	M64	32.5	65	28	56	39	28	28	58	42	28	8-251-400	M72	32.5	65	28	56	39	28	28	58	42	28	8-251-400	M80	32.5	65	28	56	39	28	28	58	42	28	8-251-400	M72	40	80	35	70	49	35	35	74	52.5	35	8-251-400	M80	40	80	35	70	49	35	35	74	52.5	35	8-251-400	M90	40	80	35	70	49	35	35	74	52.5	35	8-251-400	M80	50	100	40	80	56	40	40	84	60	40	8-251-400	M90	50	100	40	80	56	40	40	84	60	40	8-251-400	M100	50	100	40	80	56	40	40	84	60	40

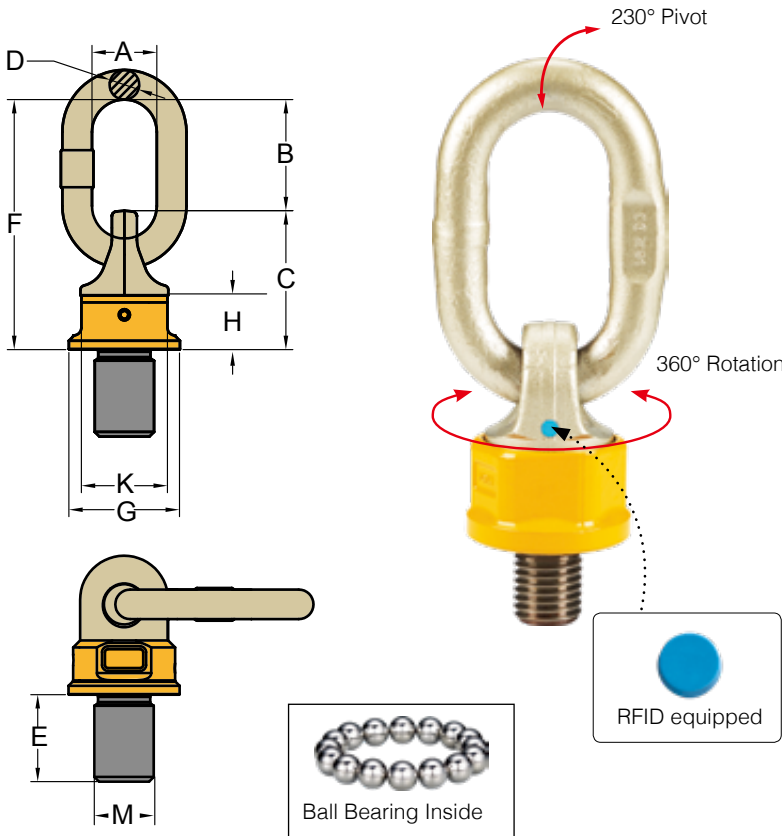

- Pivots to 230°, rotates through 360° due to its unique ball bearing design.
- Manufactured from forged alloy steel, quenched and tempered.
- Tested in accordance with EN1677-4.
- Load rated parts are 100% magnaflux crack detected.
- Individual forged parts and batch code links to Test Certificate sheet.
- Bolts are UNC thread.
- Proof tested to 2.5 times the WLL.
- Fatigue rated to 20,000 cycles at 1.5 times the WLL.
- All YOKE Lifting points meet or exceed all the requirements of ASME B30.26.
- Easy to attach or dismantle due to the forged hexagon shaped body of the Super Point.
- Capable of rotating under load. Do not turn continuously in 90 degree direction at full load.
- With the new WLL tables you can find the right Super Point attachment for your application and by the red marking on both sides you can measure disposal stage of the Super Point.

Super Point

UNC Thread (8-252)



Item No.	Working Load Limit	Thread version			Dimensions								Torque in	N.W.
		M	E	TPI	G	C	K	H	F	D	B	A		
	tonnes	inch	inch										Nm	lbs
8-252-007-01	0.5	3/8	0.56	16UNC	1.44	1.89	1.34	0.81	3.98	0.51	2.09	1.38	10 - 40	1
8-252-007-02	0.7	1/2	0.75	13UNC	1.44	1.89	1.34	0.81	3.98	0.51	2.09	1.38	15 - 40	1
8-252-014-02	1.4	5/8	0.94	11UNC	1.44	1.89	1.34	0.81	3.98	0.51	2.09	1.38	45 - 130	1
8-252-025-01	2.5	3/4	1.13	10UNC	2.05	2.68	1.81	1.1	5	0.63	2.32	1.38	100 - 170	2.1
8-252-040-02	4	1	1.5	8UNC	2.24	2.95	1.97	1.36	5.83	0.75	2.87	1.57	190 - 280	3.3
8-252-067-02	6.7	1 1/4	1.88	7UNC	2.76	3.74	2.56	1.61	6.42	0.75	2.68	1.57	230 - 400	5.3
8-252-080-02	8	1 1/4	1.88	7UNC	3.19	4.17	2.95	1.89	7.91	0.87	3.74	1.97	270 - 600	8.1
8-252-100-02	10	1 1/2	2.25	6UNC	3.19	4.17	2.95	1.89	7.91	0.87	3.74	1.97	270 - 600	8.3
8-252-125-03	12.5	1 3/4	2.63	5UNC	3.19	4.17	2.95	1.89	7.91	0.87	3.74	1.97	270 - 700	8.8
8-252-125-05	12.5	2	3	4.5UNC	3.19	4.17	2.95	1.89	7.91	0.87	3.74	1.97	270 - 700	9.7
8-252-170-04	17	2	3	4.5UNC	4.09	5	3.74	2.28	10.08	1.26	5.08	2.76	350 - 800	16.7
8-252-170-06	18	2 1/4	3.38	4.5UNC	4.09	5	3.74	2.28	10.08	1.26	5.08	2.76	350 - 900	17.8
8-252-200-01	20	2 1/2	3.75	4UNC	4.09	5	3.74	2.28	10.08	1.26	5.08	2.76	350 - 900	19.6
8-252-280-01	28	2 1/2	3.75	4UNC	5.08	6.85	4.53	3.07	12.01	1.42	5.16	3.15	500 - 1000	36.1
8-252-350-01	35	3 1/2	5.25	4UNC	5.83	7.36	5.31	3.35	14.41	1.77	7.05	3.94	500 - 1400	55.7

* Design Factor 4:1



Kind of attachment											
Number of legs	Load direction	1	2	1	2	2	2	2	3-4	3-4	3-4
Item No.	Thread	0°	0°	90°	90°	0-45°	45° - 60°	unsymm.	0 - 45°	45° - 60°	unsymm.
		WLL(t)									
8-252-007	3/8	1	2	0.5	1	0.7	0.5	0.5	1	0.75	0.5
	1/2	1.4	2.8	0.7	1.4	1	0.7	0.7	1.4	1	0.7
8-252-014	5/8	2.8	5.6	1.4	2.8	2	1.4	1.4	3	2.12	1.4
8-252-025	3/4	5	10	2.5	5	3.55	2.5	2.5	5.3	3.75	2.5
8-252-040	1	8	16	4	8	5.6	4	4	8.5	6	4
8-252-067	1 1/4	12	24	6.7	13.4	9.5	6.7	6.7	14	10	6.7
8-252-080	1 1/4	12	24	8	16	11.2	8	8	16	12	8
8-252-100	1 1/2	15	30	10	20	14	10	10	21.2	15	10
8-252-125	1 3/4	15	30	12.5	25	17	12.5	12.5	25	18	12.5
	2	15	30	12.5	25	17	12.5	12.5	25	18	12.5
8-252-170	2	25	50	17	34	23.5	17	17	35	25	17
	2 1/4	25	50	18	36	25	18	18	37.5	26.5	18
8-252-200	2 1/2	25	50	20	40	28	20	20	42.5	30	20
8-252-280	2 1/2	32.5	65	28	56	39	28	28	58	42	28
8-252-350	3 1/2	40	80	35	70	49	35	35	74	52.5	35

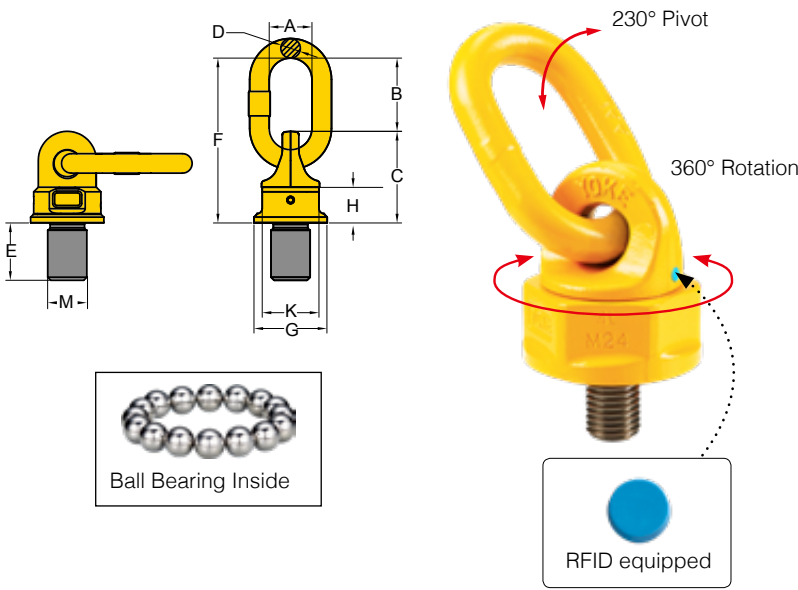

- Pivots to 230°, rotates through 360° due to its unique ball bearing design.
- Manufactured from forged alloy steel, quenched and tempered.
- Tested in accordance with EN1677-4.
- Certified by DGUV GS-OA-15-04.
- Load rated parts are 100% magnaflux crack detected.
- Individual forged parts and batch code links to Test Certificate sheet.
- Bolts are Metric thread.
- Proof tested to 2.5 times the WLL.
- Fatigue rated to 20,000 cycles at 1.5 times the WLL.
- All YOKE Lifting points meet or exceed all the requirements of ASME B30.26.
- Easy to attach or dismantle due to the forged hexagon shaped body of the Swivel Point.
- Capable of rotating under load. Do not turn continuously in 90 degree direction at full load.

Swivel Point

Metric Thread (8-271)



Item No.	Working Load Limit tonnes	Thread version			Dimensions (mm)								Torque in Nm	N.W. kg
		M mm	E mm	Pitch DIN13	G	C	K	H	F	D	B	A		
8-271-003	0.4	M 8	12	1.25	35	40	30	16	72	8	32	29	10	0.2
8-271-004	0.6	M 10	15	1.5	35	40	30	16	72	8	32	29	10	0.2
8-271-006	0.7	M 12	18	1.75	40	45	36	18	95	10	50	35	10	0.3
8-271-013	1.5	M 16	24	2	46	54	41	22	104	13	50	38	30	0.5
8-271-020	2.5	M 20	30	2.5	62	68	55	29	122	13	54	38	70	1.0
8-271-035	4	M 24	36	3	78	88	70	36	154	19	66	40	150	2.2
8-271-060	6	M 30	45	3.5	90	120	80	48	206	22	86	50	350	4.5
8-271-080	10	M 36	54	4	90	120	80	48	206	22	86	50	410	4.6
8-271-120	13	M 42	63	4.5	98	122	84	50	235	25	110	65	550	5.5
8-271-130	14	M 48	72	5	98	122	84	50	235	25	110	65	550	6.1
8-271-140	20	M 52	78	5	120	150	94	60	270	32	120	70	750	10.5
8-271-160	20	M 56	84	5.5	120	150	94	60	270	32	120	70	800	10.7
8-271-161	20	M 64	96	6	120	150	94	60	270	32	120	70	800	11.6
8-271-310	40	M 72	108	6	170	210	145	83	340	45	130	90	1200	30.6
8-271-350	40	M 80	120	6	170	210	145	83	340	45	130	90	1500	31.6
8-271-400	40	M 90	135	6	170	210	145	83	340	45	130	90	2000	33.9

* Design Factor 4:1





Kind of attachment											
Number of legs	Load direction	1	2	1	2	2	2	2	3-4	3-4	3-4
Item No.	Thread	0°	0°	90°	90°	0-45°	45° - 60°	unsymm.	0 - 45°	45° - 60°	unsymm.
		WLL(t)									
8-271-003	M 8	0.6	1.2	0.4	0.8	0.56	0.4	0.4	0.84	0.6	0.4
8-271-004	M10	0.9	1.8	0.6	1.2	0.84	0.6	0.6	1.26	0.9	0.6
8-271-006	M12	1.2	2.4	0.7	1.4	0.98	0.7	0.7	1.47	1.05	0.7
8-271-013	M16	2.6	5.2	1.5	3	2.1	1.5	1.5	3.15	2.25	1.5
8-271-020	M20	4	8	2.5	5	3.5	2.5	2.5	5.25	3.75	2.5
8-271-035	M24	7	14	4	8	5.6	4	4	8.4	6	4
8-271-060	M30	10	20	6	12	8.4	6	6	12.6	9	6
8-271-080	M36	15	30	10	20	14	10	10	21	15	10
8-271-120	M42	17	34	13	26	18.2	13	13	27.3	19.5	13
8-271-130	M48	18	36	14	28	19.6	14	14	29.4	21	14
8-271-140	M52	25	50	20	40	28	20	20	42	30	20
8-271-160	M56	28	56	20	40	28	20	20	42	30	20
8-271-161	M64	28	56	20	40	28	20	20	42	30	20
8-271-310	M72	50	100	40	80	56	40	40	84	60	40
8-271-350	M80	50	100	40	80	56	40	40	84	60	40
8-271-400	M90	50	100	40	80	56	40	40	84	60	40

* Please refer to 8-251 table for specification \geq M72

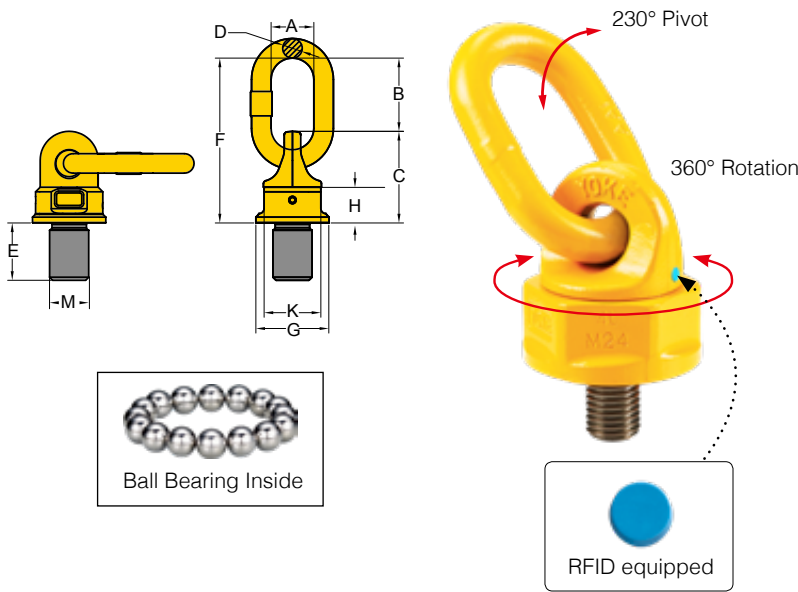

- Pivots to 230°, rotates through 360° due to its unique ball bearing design.
- Manufactured from forged alloy steel, quenched and tempered.
- Tested in accordance with EN1677-4.
- Load rated parts are 100% magnaflux crack detected.
- Individual forged parts and batch code links to Test Certificate sheet.
- Bolts are UNC thread.
- Proof tested to 2.5 times the WLL.
- Fatigue rated to 20,000 cycles at 1.5 times the WLL.
- All YOKE Lifting points meet or exceed all the requirements of ASME B30.26.
- Easy to attach or dismantle due to the forged hexagon shaped body of the Swivel Point.
- Capable of rotating under load. Do not turn continuously in 90 degree direction at full load.

Swivel Point

UNC Thread (8-272)



Item No.	Working Load Limit	Thread version				Dimensions							Torque		N.W.
		M	E	TPI	G	C	K	H	F	D	B	A	in		
	tonnes	inch	inch					inch					Nm	lbs	
8-272-006	0.7	1/2	0.75	13UNC	1.57	1.77	1.42	0.71	3.74	0.39	1.97	1.38	15	0.7	
8-272-013	1.5	5/8	0.94	11UNC	1.81	2.13	1.61	0.87	4.09	0.51	1.97	1.50	45	1.2	
8-272-018	2	3/4	1.13	10UNC	1.81	2.68	1.61	0.87	4.09	0.51	1.97	1.50	45	1.2	
8-272-020	2.5	7/8	1.31	9UNC	2.44	2.68	2.17	1.14	4.80	0.51	2.13	1.50	100	2.2	
8-272-035	4	1	1.50	8UNC	3.07	3.46	2.76	1.42	6.06	0.75	2.60	1.57	190	4.8	
8-272-060	6	1 1/4	1.88	7UNC	3.54	4.72	3.15	1.89	8.11	0.87	3.39	1.97	270	9.9	
8-272-080	10	1 1/2	2.25	6UNC	3.54	4.72	3.15	1.89	8.11	0.87	3.39	1.97	270	10.0	
8-272-120	13	1 3/4	2.63	5UNC	3.86	4.80	3.31	1.97	9.25	0.98	4.33	2.56	350	12.1	
8-272-130	14	2	3.00	4.5UNC	3.86	4.80	3.31	1.97	9.25	0.98	4.33	2.56	350	13.5	
8-272-140	20	2 1/4	3.38	4.5UNC	4.72	5.91	3.70	2.36	10.63	1.26	4.72	2.76	350	23.1	
8-272-160	20	2 1/2	3.75	4UNC	4.72	5.91	3.70	2.36	10.63	1.26	4.72	2.76	350	23.5	

* Design Factor 4:1

* Please refer to 8-252 table for specification ≥ 3-4UNC.



Kind of attachment											
Number of legs	Load direction	1	2	1	2	2	2	2	3-4	3-4	3-4
Item No.	Thread	0°	0°	90°	90°	0-45°	45° - 60°	unsymm.	0 - 45°	45° - 60°	unsymm.
		WLL(t)									
8-272-006	1/2	1.2	2.4	0.7	1.4	0.98	0.7	0.7	1.47	1.05	0.7
8-272-013	5/8	2.6	5.2	1.5	3	2.1	1.5	1.5	3.15	2.25	1.5
8-272-018	3/4	3.6	7.2	2	4	2.8	2	2	4.2	3	2
8-272-020	7/8	4	8	2.5	5	3.5	2.5	2.5	5.25	3.75	2.5
8-272-035	1	7	14	4	8	5.6	4	4	8.4	6	4
8-272-060	1 1/4	10	20	6	12	8.4	6	6	12.6	9	6
8-272-080	1 1/2	15	30	10	20	14	10	10	21	15	10
8-272-120	1 3/4	17	34	13	26	18.2	13	13	27.3	19.5	13
8-272-130	2	18	36	14	28	19.6	14	14	29.4	21	14
8-272-140	2 1/4	25	50	20	40	28	20	20	42	30	20
8-272-160	2 1/2	28	56	20	40	28	20	20	42	30	20

* Please refer to 8-252 table for specification \geq 3-4UNC.

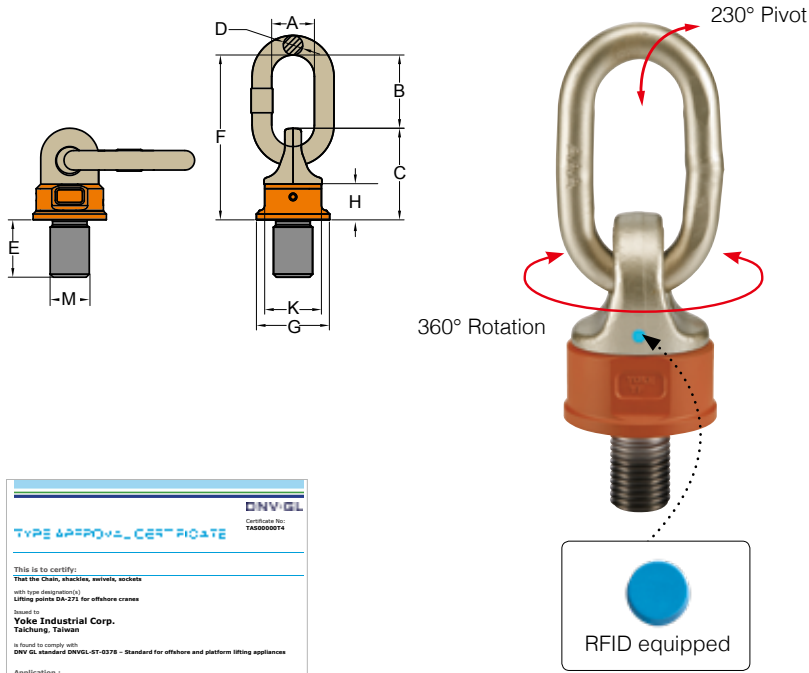

- Pivots to 230°, rotates through 360° due to its unique ball bearing design.
- Manufactured from forged alloy steel, quenched and tempered.
- Tested in accordance with EN 1677-4 and DNV GL-ST-0378.
- Certified by DNV GL-ST-0378.
- Load rated parts are 100% magnaflux crack detected.
- Individual forged parts and batch code links to Test Certificate sheet.
- Bolts are Metric thread.
- Proof tested to 2.5 times the WLL.
- Fatigue rated to 20,000 cycles at 1.5 times the WLL.
- All YOKE Lifting points meet or exceed all the requirements of ASME B30.26.
- Easy to attach or dismantle due to the forged hexagon shaped body of the DA Swivel Point.
- Capable of rotating under load. Do not turn continuously in 90 degree direction at full load.

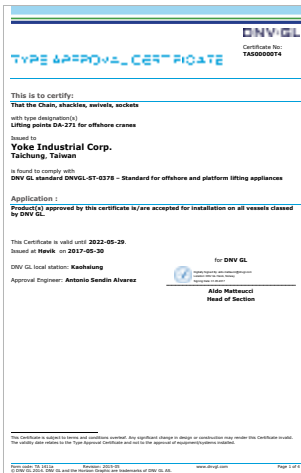

-40°C

DA Swivel Point

Metric Thread (DA-271)

DNV GL-ST-0378
(Offshore crane- Lifting Appliance)



Item No.	Working Load Limit tonnes	Thread version			Dimensions (mm)								Torque in Nm	N.W. kg
		M	E	Pitch DIN13	G	C	K	H	F	D	B	A		
DA-271-003	0.4	M 8	12	1.25	35	40	30	16	72	8	32	29	10	0.2
DA-271-004	0.6	M 10	15	1.5	35	40	30	16	72	8	32	29	10	0.2
DA-271-006	0.7	M 12	18	1.75	40	45	36	18	95	10	50	35	10	0.3
DA-271-013	1.5	M 16	24	2	46	54	41	22	104	13	50	38	30	0.5
DA-271-020	2.5	M 20	30	2.5	62	68	55	29	122	13	54	38	70	1.0
DA-271-035	4	M 24	36	3	78	88	70	36	154	19	66	40	150	2.2
DA-271-060	6	M 30	45	3.5	90	120	80	48	206	22	86	50	350	4.5
DA-271-080	10	M 36	54	4	90	120	80	48	206	22	86	50	410	4.6
DA-271-120	13	M 42	63	4.5	98	122	84	50	235	25	110	65	550	5.5
DA-271-130	14	M 48	72	5	98	122	84	50	235	25	110	65	550	6.1
DA-271-140	20	M 52	78	5	120	150	94	60	270	32	120	70	750	10.5
DA-271-160	20	M 56	84	5.5	120	150	94	60	270	32	120	70	800	10.7
DA-271-161	20	M 64	96	6	120	150	94	60	270	32	120	70	800	11.6

* Design Factor 4:1





-40°C

Kind of attachment											
Number of legs	1	2	1	2	2	2	2	3-4	3-4	3-4	
Load direction	0°	0°	90°	90°	0-45°	45° - 60°	unsymm.	0 - 45°	45° - 60°	unsymm.	
Item No.	Thread	WLL(t)									
DA-271-003	M 8	0.6	1.2	0.4	0.8	0.56	0.4	0.4	0.84	0.6	0.4
DA-271-004	M10	0.9	1.8	0.6	1.2	0.84	0.6	0.6	1.26	0.9	0.6
DA-271-006	M12	1.2	2.4	0.7	1.4	0.98	0.7	0.7	1.47	1.05	0.7
DA-271-013	M16	2.6	5.2	1.5	3	2.1	1.5	1.5	3.15	2.25	1.5
DA-271-020	M20	4	8	2.5	5	3.5	2.5	2.5	5.25	3.75	2.5
DA-271-035	M24	7	14	4	8	5.6	4	4	8.4	6	4
DA-271-060	M30	10	20	6	12	8.4	6	6	12.6	9	6
DA-271-080	M36	15	30	10	20	14	10	10	21	15	10
DA-271-120	M42	17	34	13	26	18.2	13	13	27.3	19.5	13
DA-271-130	M48	18	36	14	28	19.6	14	14	29.4	21	14
DA-271-140	M52	25	50	20	40	28	20	20	42	30	20
DA-271-160	M56	28	56	20	40	28	20	20	42	30	20
DA-271-161	M64	28	56	20	40	28	20	20	42	30	20

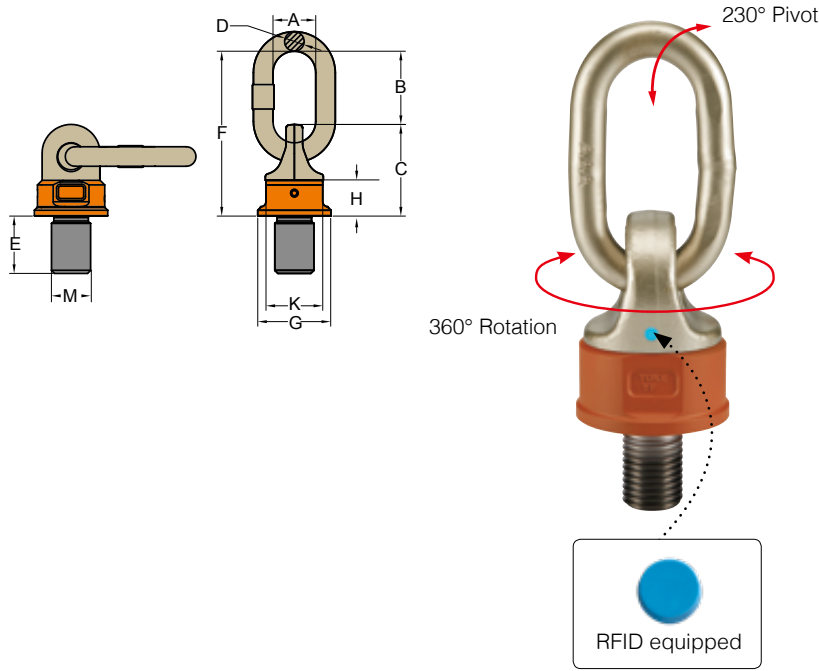

- Pivots to 230°, rotates through 360° due to its unique ball bearing design.
- Manufactured from forged alloy steel, quenched and tempered.
- Tested in accordance with EN 1677-4 y DNV GL-ST-0378.
- Load rated parts are 100% magnaflux crack detected.
- Individual forged parts and batch code links to Test Certificate sheet.
- Bolts are UNC thread.
- Proof tested to 2.5 times the WLL.
- Fatigue rated to 20,000 cycles at 1.5 times the WLL.
- All YOKE Lifting points meet or exceed all the requirements of ASME B30.26.
- Easy to attach or dismantle due to the forged hexagon shaped body of the DA Swivel Point.
- Capable of rotating under load. Do not turn continuously in 90 degree direction at full load.

-40°C

DA Swivel Point

UNC Thread (DA-272)

Item No.	Working Load Limit	Thread version			Dimensions (mm)								Torque in	N.W.
		M	E	TPI	G	C	K	H	F	D	B	A		
	tonnes	inch	inch					inch					Nm	lbs
DA-272-006	0.7	1/2	0.75	13UNC	1.57	1.77	1.42	0.71	3.74	0.39	1.97	1.38	15	0.7
DA-272-013	1.5	5/8	0.94	11UNC	1.81	2.13	1.61	0.87	4.09	0.51	1.97	1.50	45	1.2
DA-272-018	2	3/4	1.13	10UNC	1.81	2.68	1.61	0.87	4.09	0.51	1.97	1.50	45	1.2
DA-272-020	2.5	7/8	1.31	9UNC	2.44	2.68	2.17	1.14	4.80	0.51	2.13	1.50	100	2.2
DA-272-035	4	1	1.50	8UNC	3.07	3.46	2.76	1.42	6.06	0.75	2.60	1.57	190	4.8
DA-272-060	6	1 1/4	1.88	7UNC	3.54	4.72	3.15	1.89	8.11	0.87	3.39	1.97	270	9.9
DA-272-080	10	1 1/2	2.25	6UNC	3.54	4.72	3.15	1.89	8.11	0.87	3.39	1.97	270	10.0
DA-272-120	13	1 3/4	2.63	5UNC	3.86	4.80	3.31	1.97	9.25	0.98	4.33	2.56	350	12.1
DA-272-130	14	2	3.00	4.5UNC	3.86	4.80	3.31	1.97	9.25	0.98	4.33	2.56	350	13.5
DA-272-140	20	2 1/4	3.38	4.5UNC	4.72	5.91	3.70	2.36	10.63	1.26	4.72	2.76	350	23.1
DA-272-160	20	2 1/2	3.75	4UNC	4.72	5.91	3.70	2.36	10.63	1.26	4.72	2.76	350	23.5

* Design Factor 4:1



DA™
Offshore Lifting



-40°C

Kind of attachment																				
	Item No.	Thread	WLL(t)																	
DA-272-006	1/2	1.2	2.4	0.7	1.4	0.98	0.7	0.7	1.47	1.05	0.7									
DA-272-013	5/8	2.6	5.2	1.5	3	2.1	1.5	1.5	3.15	2.25	1.5									
DA-272-018	3/4	3.6	7.2	2	4	2.8	2	2	4.2	3	2									
DA-272-020	7/8	4	8	2.5	5	3.5	2.5	2.5	5.25	3.75	2.5									
DA-272-035	1	7	14	4	8	5.6	4	4	8.4	6	4									
DA-272-060	1 1/4	10	20	6	12	8.4	6	6	12.6	9	6									
DA-272-080	1 1/2	15	30	10	20	14	10	10	21	15	10									
DA-272-120	1 3/4	17	34	13	26	18.2	13	13	27.3	19.5	13									
DA-272-130	2	18	36	14	28	19.6	14	14	29.4	21	14									
DA-272-140	2 1/4	25	50	20	40	28	20	20	42	30	20									
DA-272-160	2 1/2	28	56	20	40	28	20	20	42	30	20									

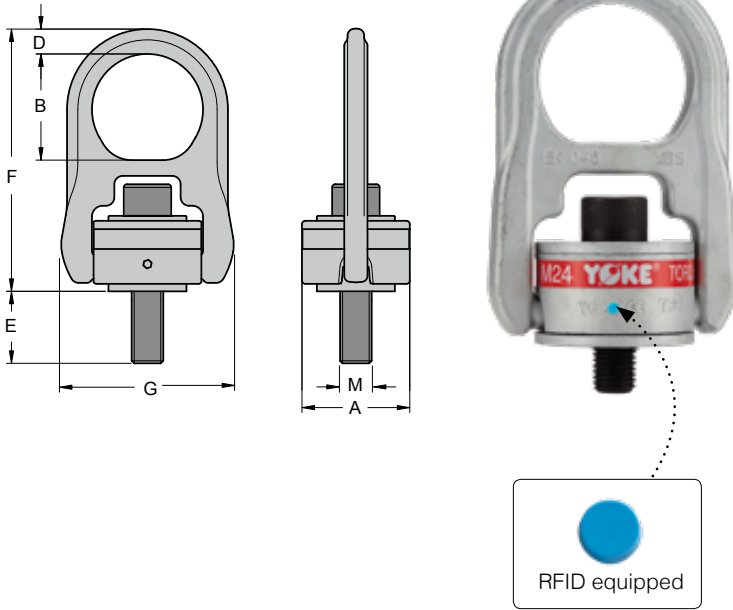

- Rotates through 360° and pivots 180°, and simultaneously allows lifting from any direction.
- Manufactured from forged alloy steel, quenched and tempered.
- Manufactured and tested in accordance with EN1677-1.
- Load rated parts are 100% magnaflux crack detected.
- Individual forged parts and cap screw are traceable to Test Certification.
- Bolts are Metric thread.
- Proof tested to 2.5 times the WLL.
- Fatigue rated to 20,000 cycles at 1.5 times the WLL.
- All YOKE Lifting points meet or exceed all the requirements of ASME B30.26.
- Quick and simple assembly, just a tapped hole is required

» Taiwan Patent
» China Patent

Hoist Ring

with Alloy Steel Washer
Metric Thread (8-203)

Item No.	Working Load Limit		Thread	Dimensions (mm)						Torque in	N.W.	
	tonnes			M	A	B	D	E	F			G
	5 : 1	4 : 1					mm					
8-203-004	0.40	0.50	M 8 x 1.25	40	41	9	17	102	65	10	0.4	
8-203-005	0.45	0.55	M10 x 1.5	40	41	9	11	102	65	16	0.5	
§ 8-203-005L	0.45	0.55	M10 x 1.5	40	41	9	26	102	65	16	0.5	
8-203-010	1.05	1.30	M12 x 1.75	65	58	15	15	158	105	38	1.7	
§ 8-203-010L	1.05	1.30	M12 x 1.75	65	58	15	30	158	105	38	1.7	
8-203-019	1.90	2.40	M16 x 2	65	58	15	20	158	105	81	1.8	
§ 8-203-019L	1.90	2.40	M16 x 2	65	58	15	35	158	105	81	1.8	
8-203-021	2.15	2.70	M20 x 2.5	65	58	15	25	158	105	136	1.8	
§ 8-203-021L	2.15	2.70	M20 x 2.5	65	58	15	45	158	105	136	1.9	
8-203-030	3.00	3.75	M20 x 2.5	85	73	22	25	204	134	136	4.0	
§ 8-203-030L	3.00	3.75	M20 x 2.5	85	73	22	45	204	134	136	5.2	
8-203-042	4.20	5.25	M24 x 3	85	73	22	26	204	134	312	4.2	
§ 8-203-042L	4.20	5.25	M24 x 3	85	73	22	56	204	134	312	4.3	
8-203-070	7.00	8.75	M30 x 3.5	100	80	25	81	218	160	637	6.6	
8-203-110	11.00	13.75	M36 x 4	120	106	36	76	308	220	1005	15.0	
8-203-125	12.50	15.60	M42 x 4.5	120	106	36	95	308	220	1005	16.0	
8-203-135	13.50	16.90	M48 x 5	120	106	36	105	308	220	1350	16.0	
8-203-155	15.50	19.40	M56 x 5.5	138	109	34	94	308	241	1350	19.1	
8-203-223	22.30	27.90	M64 x 6	138	95	38	98	312	241	2847	23.0	

* Design Factor 4:1

§ Long Bolts are designed for soft metal work piece.
Surface Treatment: The Dacromet original silver color.

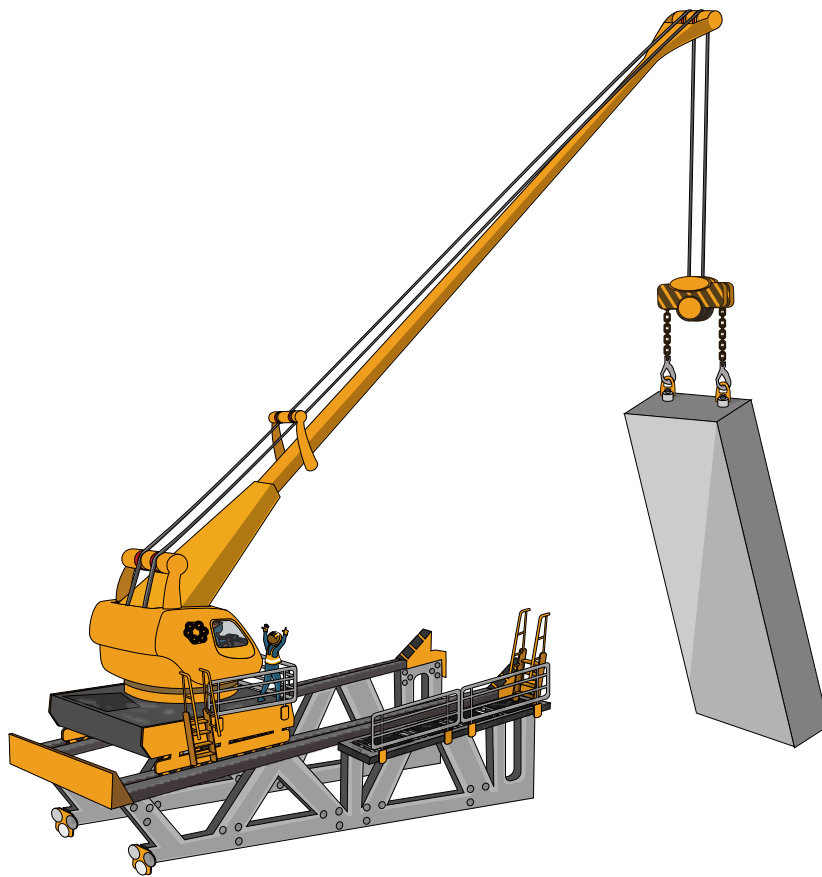

Kind of attachment																
	Number of legs	Load direction	1	2	1	2	2	2	2	2	3-4	3-4	3-4	3-4	3-4	3-4
Item No.	Thread	WLL(t)														
8-203-004	M 8	0.5	1	0.5	1	0.7	0.5	0.5	0.5	1.05	0.75	0.5				
8-203-005	M10	0.55	1.1	0.55	1.1	0.77	0.55	0.55	0.55	1.16	0.83	0.55				
8-203-010	M12	1.3	2.6	1.3	2.6	1.82	1.3	1.3	1.3	2.73	1.95	1.3				
8-203-019	M16	2.4	4.8	2.4	4.8	3.36	2.4	2.4	2.4	5.04	3.6	2.4				
8-203-021	M20	2.7	5.4	2.7	5.4	3.78	2.7	2.7	2.7	5.67	4.05	2.7				
8-203-030	M20	3.75	7.5	3.75	7.5	5.25	3.75	3.75	3.75	7.88	5.63	3.75				
8-203-042	M24	5.25	10.5	5.25	10.5	7.35	5.25	5.25	5.25	11.03	7.88	5.25				
8-203-070	M30	8.75	17.5	8.75	17.5	12.25	8.75	8.75	8.75	18.38	13.13	8.75				
8-203-110	M36	13.75	27.5	13.75	27.5	19.25	13.75	13.75	13.75	28.88	20.63	13.75				
8-203-125	M42	15.6	31.2	15.6	31.2	21.84	15.6	15.6	15.6	32.76	23.4	15.6				
8-203-135	M48	16.9	33.8	16.9	33.5	23.66	16.9	16.9	16.9	35.49	25.35	16.9				
8-203-155	M56	19.4	38.8	19.4	38.8	27.16	19.4	19.4	19.4	40.74	29.1	19.4				
8-203-223	M64	27.9	55.8	27.9	55.8	39.06	27.9	27.9	27.9	58.59	41.85	27.9				

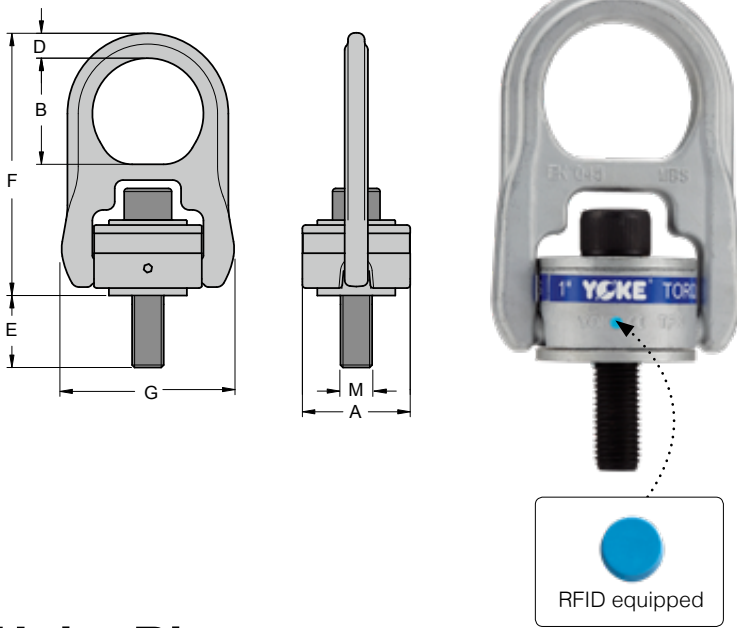

- Rotates through 360° and pivots 180°, and simultaneously allows lifting from any direction.
- Manufactured from forged alloy steel, quenched and tempered.
- Manufactured and tested in accordance with EN1677-1.
- Load rated parts are 100% magnaflux crack detected.
- Individual forged parts and cap screw are traceable to Test Certification.
- Bolts are UNC thread.
- Proof tested to 2.5 times the WLL.
- Fatigue rated to 20,000 cycles at 1.5 times the WLL.
- All YOKE Lifting points meet or exceed all the requirements of ASME B30.26.
- Quick and simple assembly, just a tapped hole is required.

» Taiwan Patent
» China Patent

Hoist Ring

with Alloy Steel Washer

UNC Thread (8-204)

Item No.	Working Load Limit	Thread	Dimensions (inch)						Torque in	N.W.
	lbs		TPI	A	B	D	E	F	G	
8-204-004	800	5/16 - 18UNC	1.57	1.61	0.35	0.71	4.02	2.56	7	0.9
8-204-005	1000	3/8 - 16UNC	1.57	1.61	0.35	0.71	4.02	2.56	12	0.9
8-204-010	2500	1/2 - 13UNC	2.56	2.32	0.59	0.75	6.26	4.13	28	3.7
8-204-010L	2500	1/2 - 13UNC	2.56	2.32	0.59	1.26	6.26	4.13	28	3.7
8-204-019	4000	5/8 - 11UNC	2.56	2.32	0.59	0.74	6.26	4.13	60	4.0
8-204-019L	4000	5/8 - 11UNC	2.56	2.32	0.59	1.75	6.26	4.13	60	4.0
8-204-021	5000	3/4 - 10UNC	2.56	2.87	0.59	1.24	6.26	4.13	100	4.0
8-204-021L	5000	3/4 - 10UNC	2.56	2.87	0.59	1.73	6.26	4.13	100	4.2
8-204-030	7000	3/4 - 10UNC	3.35	2.87	0.59	0.87	6.26	5.28	100	8.8
8-204-030L	7000	3/4 - 10UNC	3.35	2.87	0.87	1.87	8.03	5.28	100	9.5
8-204-042	8000	7/8 - 9UNC	3.35	2.87	0.87	1.43	8.03	5.28	160	9.3
8-204-042L	8000	7/8 - 9UNC	3.35	2.87	0.87	2.37	8.03	5.28	160	9.7
8-204-045	10000	1 - 8UNC	3.35	2.87	0.87	1.36	8.03	5.28	230	9.5
8-204-045L	10000	1 - 8UNC	3.35	2.87	0.87	2.36	8.03	5.28	230	10.1
8-204-070	15000	1 1/4 - 7UNC	3.95	3.15	1.00	2.25	8.58	6.30	470	14.5
8-204-125	24000	1 1/2 - 6UNC	4.72	4.29	1.38	2.17	12.09	8.66	800	35.2
8-204-135	30000	2 - 4.5UNC	4.72	4.29	1.38	3.01	12.09	8.66	1100	35.2

* Design Factor 5:1
Surface Treatment: The Dacromet original silver color.

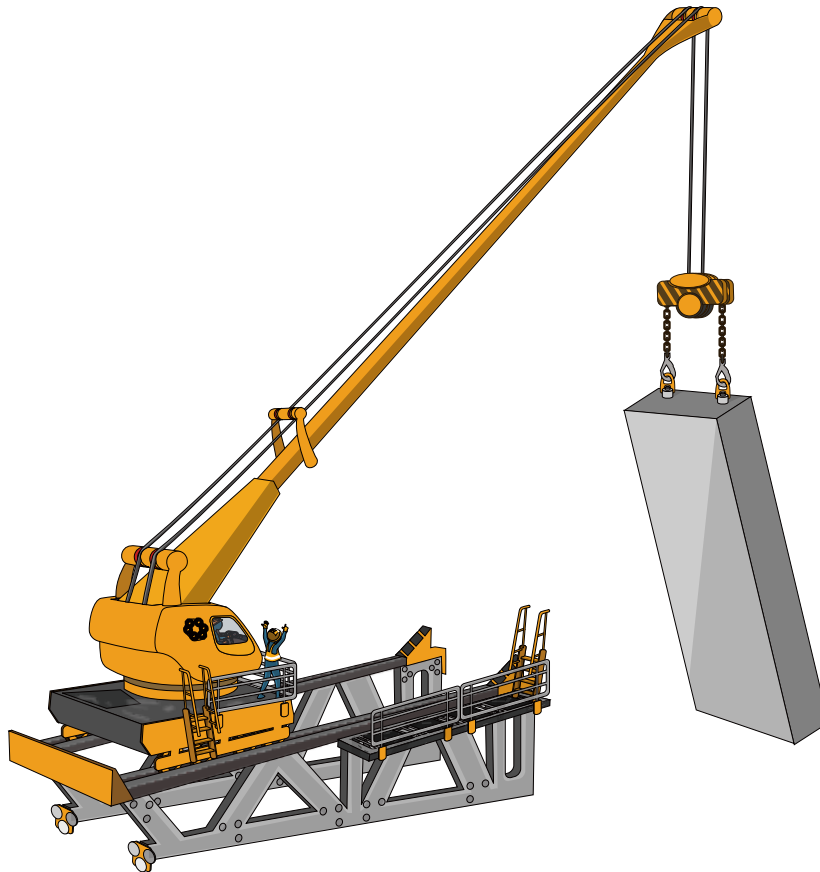

Kind of attachment											
Number of legs		1	2	1	2	2	2	2	3-4	3-4	3-4
Load direction		0°	0°	90°	90°	0-45°	45° - 60°	unsymm.	0 - 45°	45° - 60°	unsymm.
Item No.	Thread	WLL(t)									
8-204-004	5/16	0.36	0.72	0.36	0.72	0.50	0.36	0.36	0.76	0.54	0.36
8-204-005	3/8	0.45	0.9	0.45	0.9	0.63	0.45	0.45	0.95	0.68	0.45
8-204-010	1/2	1.1	2.2	1.1	2.2	1.54	1.1	1.1	2.31	1.65	1.1
8-204-019	5/8	1.8	3.6	1.8	3.6	2.52	1.8	1.8	3.78	2.7	1.8
8-204-021	3/4	2.2	4.4	2.2	4.4	3.08	2.2	2.2	4.62	3.3	2.2
8-204-030	3/4	3.1	6.2	3.1	6.2	4.34	3.1	3.1	6.51	4.65	3.1
8-204-042	7/8	3.6	7.2	3.6	7.2	5.04	3.6	3.6	7.56	5.4	3.6
8-204-045	1	4.5	9	4.5	9	6.3	4.5	4.5	9.45	6.75	4.5
8-204-070	1 1/4	6.8	13.6	6.8	13.6	9.52	6.8	6.8	14.28	10.2	6.8
8-204-125	1 1/2	10.9	21.8	10.9	21.8	15.26	10.9	10.9	22.89	16.35	10.9
8-204-135	2	13.6	27.2	13.6	27.2	19.04	13.6	13.6	28.56	20.4	13.6



Y PSA

Anchor Point for Personal Protective Equipment



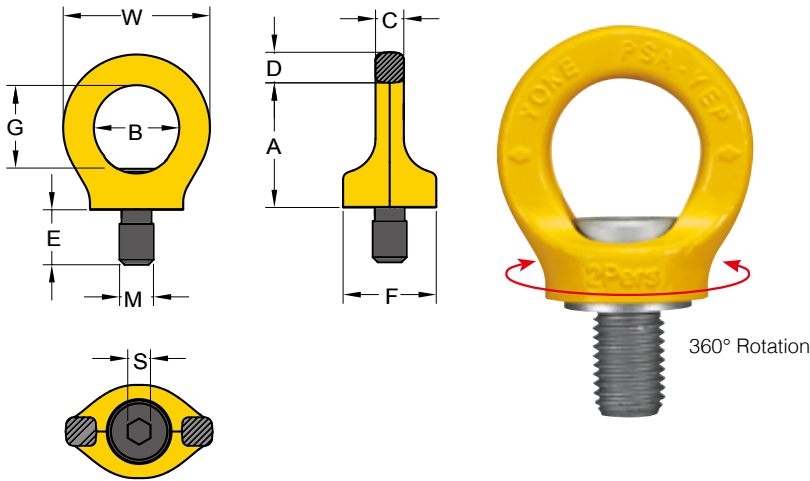

- Rotates through 360° adjustable in the direction of the load.
 - Manufactured from forged alloy steel, quenched and tempered.
 - Manufactured and tested in accordance with EN795.
 - Certified by PSA of DGUV.
 - Load rated parts are 100% magnaflux crack detected.
 - Individual forged parts and cap screw are traceable to Test Certification.
 - Passed 22.2 KN/person Load testing.
 - Passed 150 kg dynamic fall testing (EU standard is 100 kg).
 - Meets all requirements of the German BG BAU (Employer ´s insurance association of the building industry).
 - Meets all requirements of DIN EN795, DIN EN50308, OSHA1926.502.
 - Acc. to DIN EN 365 including statement for the number of load bearing persons is 1-2 persons.
 - Correspond to the European Directive for "personnel protection equipment" (89/686/ EWG).
 - YOKE yellow powder coating for high visibility.
 - PSA - Lifting point to be as an anchor point for personal protective equipment.
- » Taiwan Patent » Australian Patent
 » China Patent » Mexican Patent
 » French Patent » Japanese Patent



Anchor Point for Personal Protective Equipment

PSA-YEP

Metric (8-281)

Item No.	Working Load Limit	Thread version	Dimensions(mm)									Torque in		N.W.
			M	A	B	C	D	E	F	G	S	W	Nm	
8-281-007	1 Pers	M12 x 1.75	45	30	10	11	18	33	29	8	52	10	0.2	
8-281-015	2 Pers	M16 x 2	52	35	14	13	24	35	34	10	61	30	0.3	
8-281-023	2 Pers	M20 x 2.5	60	40	16	15	30	44	37	12	70	70	0.6	

PSA-YEP

Imperial (8-281)

Item No.	Working Load Limit	Thread version	Dimensions(inch)									Torque in		N.W.
			M	A	B	C	D	E	F	G	S	W	ft. lbs	
8-281-007	1 Pers	M12 x 1.75	1.8	1.2	0.4	0.4	0.7	1.3	1.14	0.3	2.0	7.4	0.4	
8-281-015	2 Pers	M16 x 2	2.0	1.4	0.6	0.5	0.9	1.4	1.34	0.4	2.4	22.1	0.7	
8-281-023	2 Pers	M20 x 2.5	2.4	1.6	0.6	0.6	1.2	1.7	1.46	0.5	2.8	51.7	1.3	

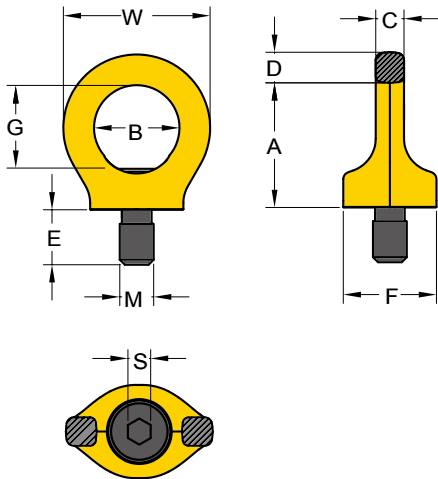

- Rotates through 360° adjustable in the direction of the load.
- Manufactured from forged stainless steel.
- Manufactured and tested in accordance with EN795.
- Load rated parts are 100% magnaflux crack detected.
- Individual forged parts and cap screw are traceable to Test Certification.
- Passed 22.2KN/person load testing.
- Passed 150 kg dynamic fall testing (EU standard is 100 kg).
- Meets all requirements of the German BG BAU (Employer’s insurance association of the building industry).
- Meets all requirements of DIN EN795, DIN EN50308, OSHA1926.502.
- Acc. to DIN EN 365 including statement for the number of load bearing persons is 1-2 persons.
- Corresponds to the European Directive for “personnel protection equipment” (89/686/ EWG).
- YOKE yellow powder coating for high visibility.
- Suitable for permanently outdoor application.
- PSA-INOX Lifting point to be as an anchor point for personal protective equipment.



Anchor Point for Personal Protective Equipment

- » Taiwan Patent
- » China Patent
- » French Patent
- » Australian Patent
- » Mexican Patent
- » Japanese Patent

PSA-INOX-YEP

Metric (8-285) stainless steel

Item No.	Working Load Limit	Thread version	Dimensions(mm)									Torque in		N.W.
			M	A	B	C	D	E	F	G	S	W	Nm	
8-285-007	1 Pers	M12 x 1.75	45	30	10	11	19	33	29	8	52	10	0.2	
8-285-015	2 Pers	M16 x 2	52	35	14	13	24	35	34	10	61	30	0.3	
8-285-023	2 Pers	M20 x 2.5	60	40	16	15	30	44	37	12	70	70	0.6	

PSA-INOX-YEP

Imperial (8-285) stainless steel

Item No.	Working Load Limit	Thread version	Dimensions(inch)									Torque in		N.W.
			M	A	B	C	D	E	F	G	S	W	ft. lbs	
8-285-007	1 Pers	M12x1.75	1.8	1.2	0.4	0.4	0.7	1.3	1.14	0.3	2.0	7.4	0.4	
8-285-015	2 Pers	M16x2	2.0	1.4	0.6	0.5	0.9	1.4	1.34	0.4	2.4	22.1	0.7	
8-285-023	2 Pers	M20x2.5	2.4	1.6	0.6	0.6	1.2	1.7	1.46	0.5	2.8	51.7	1.3	

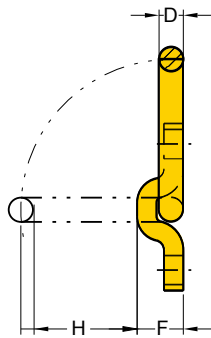
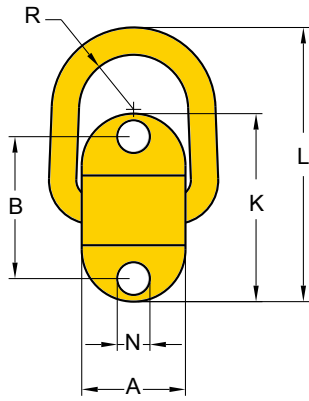

- Pivots 180° and allows side load lifting.
- Manufactured from forged alloy steel, quenched and tempered.
- Manufactured and tested in accordance with EN1677-1.
- Load rated parts are 100% magnaflux crack detected.
- Individual forged parts are traceable to Test Certification.
- Supplied without bolts; usage of Grade 10.9 or Grade 12.9 bolts is recommended.
- Proof tested to 2.5 times the WLL.
- Fatigue rated to 20,000 cycles at 1.5 times the WLL.
- All YOKE Lifting points meet or exceed all the requirements of ASME B30.26.

Bolt-on Tie Down.

Designed with spring, stop at any angle supplied without bolt (8-058)

Item No.	Working Load Limit tonnes	Dimensions (mm)									Bolt size Thread	N.W. kg
		A	B	D	F	H	K	L	N	R		
8-058-1T	1.0	50	72	14	27	55	98	139	14	24	M12	0.7
8-058-3T	3.0	58	84	17	33	53	114	144	18	29	M16	1.1
8-058-5T	5.0	64	116	22	43	74	160	203	23	33	M20/M22	2.5

* Design factor 5:1

Bolt-on Tie Down.

Designed with spring, stop at any angle supplied without bolt (Imperial 8-058)

Item No.	Working Load Limit tonnes	Dimensions (inch)									N.W. lbs
		A	B	D	F	H	K	L	N	R	
8-058-1T	1.0	1.97	2.83	0.55	1.06	2.17	3.86	5.47	0.55	0.94	1.5
8-058-3T	3.0	2.28	3.31	0.67	1.30	2.09	4.49	5.67	0.71	1.14	2.4
8-058-5T	5.0	2.52	4.57	0.87	1.69	2.91	6.30	7.99	0.91	1.30	5.5

* Design factor 5:1



Weld-on Lifting Points





Weld-on Point **Classic Weld-on Point** **Weld-on Ring** **Weld-on Hook** **Excavator Hook** **Super Weld-on Point**
8-057 **8-0573** **8-082** **8-081** **8-083** **8-0575**

Kind of attachment																																																																																																																																																																																																																																																																																																																																																																				
	Number of legs	Load direction	Number of legs	Load direction	Number of legs	Load direction	Number of legs	Load direction	Number of legs	Load direction	Number of legs	Load direction	Number of legs	Load direction	Number of legs	Load direction	Number of legs	Load direction	Number of legs	Load direction																																																																																																																																																																																																																																																																																																																																																
Item No.	WLL(t)																																																																																																																																																																																																																																																																																																																																																																			
	8-0573-01	1	2	1	2	1.4	1	1	2.1	1.5	1	8-0573-03	3	6	3	6	4.2	3	3	6.3	4.5	3	8-0573-05	5	10	5	10	7	5	5	10.5	7.5	5	8-0573-08	8	16	8	16	11.2	8	8	16.8	12	8	8-0573-10	10	20	10	20	14	10	10	21	15	10	8-0573-20	20	40	20	40	28	20	20	42	30	20	8-0573-30	30	60	30	60	42	30	30	63	45	30		8-057-1T	1	2	1	2	1.4	1	1	2.1	1.5	1	8-057-3T	3	6	3	6	4.2	3	3	6.3	4.5	3	8-057-5T	5	10	5	10	7	5	5	10.5	7.5	5	8-057-8T	8	16	8	16	11.2	8	8	16.8	12	8	8-057-10T	10	20	10	20	14	10	10	21	15	10		8-082-04	4	8	4	8	5.6	4	4	8.4	6	4	8-082-06	6.7	13.4	6.7	13.4	9.4	6.7	6.7	14.1	10.1	6.7	8-082-10	10	20	10	20	14	10	10	21	15	10	8-082-16	16	32	16	32	22.4	16	16	33.6	24	16	8-082-30	31.5	63	31.5	63	44.1	31.5	31.5	66.2	47.3	31.5		8-081-01/8-083-01	0.8	1.5	0.8	1.5	1.1	0.8	0.8	1.6	1.1	0.8	8-081-01/8-083-01	1	2	1	2	1.4	1	1	2.1	1.5	1	8-081-02/8-083-02	2	4	2	4	2.8	2	2	4.2	3	2	8-081-03/8-083-03	3	6	3	6	4.2	3	3	6.3	4.5	3	8-081-04/8-083-04	4	8	4	8	5.6	4	4	8.4	6	4	8-081-05/8-083-05	5	10	5	10	7	5	5	10.5	7.5	5	8-081-08/8-083-08	8	16	8	16	11.2	8	8	16.8	12	8	8-081-10/8-083-10	10	20	10	20	14	10	10	21	15	10	8-081-15/8-083-15	15	30	15	30	21	15	15	31.5	22.5	15		8-0575-015	1.5	3	1.5	3	2.1	1.5	1.5	3.2	2.3	1.5	8-0575-025	2.5	5	2.5	5	3.5	2.5	2.5	5.3	3.8	2.5	8-0575-040	4	8	4	8	5.6	4	4	8.4	6	4	8-0575-067	6.7	13.4	6.7	13.4	9.4	6.7	6.7	14.1	10.1	6.7	8-0575-100	10	20	10	20	14	10	10	21	15	10	8-0575-160	16	32	16	32	22.4	16	16	33.6	24	16
	8-057-1T	1	2	1	2	1.4	1	1	2.1	1.5	1	8-057-3T	3	6	3	6	4.2	3	3	6.3	4.5	3	8-057-5T	5	10	5	10	7	5	5	10.5	7.5	5	8-057-8T	8	16	8	16	11.2	8	8	16.8	12	8	8-057-10T	10	20	10	20	14	10	10	21	15	10		8-082-04	4	8	4	8	5.6	4	4	8.4	6	4	8-082-06	6.7	13.4	6.7	13.4	9.4	6.7	6.7	14.1	10.1	6.7	8-082-10	10	20	10	20	14	10	10	21	15	10	8-082-16	16	32	16	32	22.4	16	16	33.6	24	16	8-082-30	31.5	63	31.5	63	44.1	31.5	31.5	66.2	47.3	31.5		8-081-01/8-083-01	0.8	1.5	0.8	1.5	1.1	0.8	0.8	1.6	1.1	0.8	8-081-01/8-083-01	1	2	1	2	1.4	1	1	2.1	1.5	1	8-081-02/8-083-02	2	4	2	4	2.8	2	2	4.2	3	2	8-081-03/8-083-03	3	6	3	6	4.2	3	3	6.3	4.5	3	8-081-04/8-083-04	4	8	4	8	5.6	4	4	8.4	6	4	8-081-05/8-083-05	5	10	5	10	7	5	5	10.5	7.5	5	8-081-08/8-083-08	8	16	8	16	11.2	8	8	16.8	12	8	8-081-10/8-083-10	10	20	10	20	14	10	10	21	15	10	8-081-15/8-083-15	15	30	15	30	21	15	15	31.5	22.5	15		8-0575-015	1.5	3	1.5	3	2.1	1.5	1.5	3.2	2.3	1.5	8-0575-025	2.5	5	2.5	5	3.5	2.5	2.5	5.3	3.8	2.5	8-0575-040	4	8	4	8	5.6	4	4	8.4	6	4	8-0575-067	6.7	13.4	6.7	13.4	9.4	6.7	6.7	14.1	10.1	6.7	8-0575-100	10	20	10	20	14	10	10	21	15	10	8-0575-160	16	32	16	32	22.4	16	16	33.6	24	16																																																																														
	8-082-04	4	8	4	8	5.6	4	4	8.4	6	4	8-082-06	6.7	13.4	6.7	13.4	9.4	6.7	6.7	14.1	10.1	6.7	8-082-10	10	20	10	20	14	10	10	21	15	10	8-082-16	16	32	16	32	22.4	16	16	33.6	24	16	8-082-30	31.5	63	31.5	63	44.1	31.5	31.5	66.2	47.3	31.5		8-081-01/8-083-01	0.8	1.5	0.8	1.5	1.1	0.8	0.8	1.6	1.1	0.8	8-081-01/8-083-01	1	2	1	2	1.4	1	1	2.1	1.5	1	8-081-02/8-083-02	2	4	2	4	2.8	2	2	4.2	3	2	8-081-03/8-083-03	3	6	3	6	4.2	3	3	6.3	4.5	3	8-081-04/8-083-04	4	8	4	8	5.6	4	4	8.4	6	4	8-081-05/8-083-05	5	10	5	10	7	5	5	10.5	7.5	5	8-081-08/8-083-08	8	16	8	16	11.2	8	8	16.8	12	8	8-081-10/8-083-10	10	20	10	20	14	10	10	21	15	10	8-081-15/8-083-15	15	30	15	30	21	15	15	31.5	22.5	15		8-0575-015	1.5	3	1.5	3	2.1	1.5	1.5	3.2	2.3	1.5	8-0575-025	2.5	5	2.5	5	3.5	2.5	2.5	5.3	3.8	2.5	8-0575-040	4	8	4	8	5.6	4	4	8.4	6	4	8-0575-067	6.7	13.4	6.7	13.4	9.4	6.7	6.7	14.1	10.1	6.7	8-0575-100	10	20	10	20	14	10	10	21	15	10	8-0575-160	16	32	16	32	22.4	16	16	33.6	24	16																																																																																																																																						
	8-081-01/8-083-01	0.8	1.5	0.8	1.5	1.1	0.8	0.8	1.6	1.1	0.8	8-081-01/8-083-01	1	2	1	2	1.4	1	1	2.1	1.5	1	8-081-02/8-083-02	2	4	2	4	2.8	2	2	4.2	3	2	8-081-03/8-083-03	3	6	3	6	4.2	3	3	6.3	4.5	3	8-081-04/8-083-04	4	8	4	8	5.6	4	4	8.4	6	4	8-081-05/8-083-05	5	10	5	10	7	5	5	10.5	7.5	5	8-081-08/8-083-08	8	16	8	16	11.2	8	8	16.8	12	8	8-081-10/8-083-10	10	20	10	20	14	10	10	21	15	10	8-081-15/8-083-15	15	30	15	30	21	15	15	31.5	22.5	15		8-0575-015	1.5	3	1.5	3	2.1	1.5	1.5	3.2	2.3	1.5	8-0575-025	2.5	5	2.5	5	3.5	2.5	2.5	5.3	3.8	2.5	8-0575-040	4	8	4	8	5.6	4	4	8.4	6	4	8-0575-067	6.7	13.4	6.7	13.4	9.4	6.7	6.7	14.1	10.1	6.7	8-0575-100	10	20	10	20	14	10	10	21	15	10	8-0575-160	16	32	16	32	22.4	16	16	33.6	24	16																																																																																																																																																																																														
	8-0575-015	1.5	3	1.5	3	2.1	1.5	1.5	3.2	2.3	1.5	8-0575-025	2.5	5	2.5	5	3.5	2.5	2.5	5.3	3.8	2.5	8-0575-040	4	8	4	8	5.6	4	4	8.4	6	4	8-0575-067	6.7	13.4	6.7	13.4	9.4	6.7	6.7	14.1	10.1	6.7	8-0575-100	10	20	10	20	14	10	10	21	15	10	8-0575-160	16	32	16	32	22.4	16	16	33.6	24	16																																																																																																																																																																																																																																																																																																		



WELDING INSTRUCTIONS

The welding should only be carried out by qualified welder according to Standards, e.g. EN 287 or AWS.

Support material

- Material of the welding block is S355J2+N (1.0577+N, St 52-3N, B.S. 4360.50D, AISI 1019 etc.).
- Prior to welding, the contact areas must be free from impurities, oil, paint, rust, scale, etc., for example by grinding. If the surface is at all corroded, all rust must be completely removed from the weld area. Painted surface must be prepared in the same way.
- The steel support member must have a carbon content of no more than 0.40%.
- In ambient temperature of 10°C and below, pre-heating of the weld area prior to welding must be carried out.

Seam welding

- The welds must be sufficiently strong to take the required loads.
- Before starting the final weld pass, clean well the root pass to avoid inclusions.
- The complete welding operation must be carried out continuously so that the parts do not have time to cool.
- Effects of temperature
 - The complete construction can be annealed stress release at <600°C without reduction of WLL.
 - Do not rapidly cool the weld.
- A thorough inspection of the weld should be performed. No cracks, pitting, inclusions, notches or undercuts are allowed. If doubt exists, use a suitable NDT method, such as magnetic particle or liquid penetrant to verify.
- If repair is required, grind out the defect and re-weld using the original qualified procedure.

Welding materials

- Weld materials must have a minimum tensile strength of 70,000 PSI (such as AWS A5.1 E-7018), following the electrode manufacturer's recommendations. Reference information as below:

MIG arc welding:

- Wire diameter 0.8 - 1.2 as per DIN 8559-SG 3, AWS A 5.18.
- Important: do not weld in the open air during bad weather

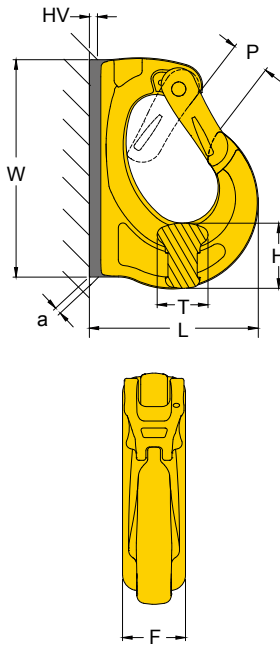

- Manufactured from forged alloy steel, quenched and tempered.
- Manufactured and tested in accordance with EN1677-1.
- Certified by DGUV GS-OA-15-03.
- Load rated parts are 100% magnaflux crack detected.
- Individual forged parts are traceable to Test Certification.
- Proof tested to 2.5 times the WLL.
- Fatigue rated to 20,000 cycles at 1.5 times the WLL.
- All YOKE Lifting points meet or exceed all the requirements of ASME B30.26.
- WLL forged onto each product for quick and easy identification.
- Lugs designed to assist the welding process.

Excavator Hook

Metric (8-083)

Item No.	Working Load Limit tonnes	Dimensions (mm)								N.W. kg
		F	H	L	P	T	W	HV	a	
8-083-0075	0.75	19	20	56	19	13	81.5	5	3	0.3
8-083-01	1.0	25	27	72	27	17	95	6	4	0.6
8-083-02	2.0	30	30	86	33	20	114	8	5	0.9
8-083-03	3.0	35	32	105	30	23	132	10	6	1.4
8-083-04	4.0	42	38	114	30	29	140	11	7	1.9
8-083-05	5.0	45	47	131	32	30	165	12	8	2.9
8-083-08	8.0	50	51	133	34	40	172	13	9	3.5
8-083-10	10.0	55	61	170	51	43	220	14	9	6.3
8-083-15	15.0	60	67	184	53	50	240	15	12	8.8

* Design factor 5:1

YOKE recommends that the working load limit should be reduced to meet any appropriate legislative requirements, if welding on to an excavator. Please contact your YOKE distributors for further information.

Excavator Hook

Imperial (8-083)

Item No.	Working Load Limit tonnes	Dimensions (inch)								N.W. lbs
		F	H	L	P	T	W	HV	a	
8-083-0075	0.75	0.75	0.79	2.20	0.75	0.51	3.21	0.20	0.12	0.6
8-083-01	1.0	0.98	1.06	2.83	1.06	0.67	3.74	0.24	0.16	1.2
8-083-02	2.0	1.18	1.18	3.39	1.30	0.79	4.49	0.31	0.20	2.0
8-083-03	3.0	1.38	1.26	4.13	1.18	0.91	5.20	0.39	0.24	3.1
8-083-04	4.0	1.65	1.50	4.49	1.18	1.14	5.51	0.43	0.28	4.3
8-083-05	5.0	1.77	1.85	5.16	1.26	1.18	6.50	0.47	0.31	6.3
8-083-08	8.0	1.97	2.01	5.24	1.34	1.57	6.77	0.51	0.35	7.7
8-083-10	10.0	2.17	2.40	6.69	2.01	1.69	8.66	0.55	0.35	14.0
8-083-15	15.0	2.36	2.64	7.40	2.09	1.97	9.45	0.59	0.47	19.3



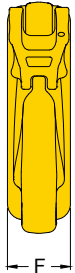
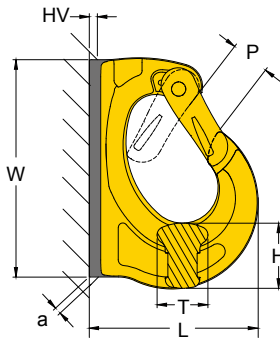

- Manufactured from forged alloy steel, quenched and tempered.
- Manufactured and tested in accordance with EN1677-1.
- Certified by DGUV GS-OA-15-03.
- Load rated parts are 100% magnaflux crack detected.
- Individual forged parts are traceable to Test Certification.
- Proof tested to 2.5 times the WLL.
- Fatigue rated to 20,000 cycles at 1.5 times the WLL.
- All YOKE Lifting points meet or exceed all the requirements of ASME B30.26.
- WLL forged onto each product for quick and easy identification.
- Lugs designed to assist the welding process.

Weld-on Hook

Metric (8-081)

Item No.	Working Load Limit	Dimensions (mm)								N.W.
		tonnes	F	H	L	P	T	W	HV	
8-081-01	1.0	25	27	70	18	18	95	7	4	0.6
8-081-02	2.0	30	30	85	25	20	115	8	5	1.0
8-081-03	3.0	35	30	107	28	23	133	9	6	1.4
8-081-04	4.0	42	38	114	28	30	142	10	7	2.2
8-081-05	5.0	44	47	135	30	31	167	12	7	3.0
8-081-08	8.0	50	52	137	32	39	176	12	8	3.7
8-081-10	10.0	56	56	170	44	42	222	13	8	6.2
8-081-15	15.0	61	67	184	54	45	242	14	10	7.9

* Design factor 5:1

YOKE recommends that the working load limit should be reduced to meet any appropriate legislative requirements, if welding on to an excavator. Please contact your YOKE distributors for further information.

Weld-on Hook

Imperial (8-081)

Item No.	Working Load Limit	Dimensions (inch)								N.W.
		tonnes	F	H	L	P	T	W	HV	
8-081-01	1.0	0.98	1.06	2.83	0.71	0.67	3.74	0.28	0.24	1.3
8-081-02	2.0	1.18	1.22	3.46	0.98	0.79	4.53	0.31	0.31	2.2
8-081-03	3.0	1.38	1.18	4.21	1.1	0.91	5.24	0.35	0.39	3.1
8-081-04	4.0	1.65	1.5	4.41	1.1	1.18	5.55	0.39	0.43	4.4
8-081-05	5.0	1.73	1.81	5.24	1.18	1.22	6.57	0.47	0.51	6.6
8-081-08	8.0	1.97	2.13	5.39	1.26	1.54	6.89	0.47	0.55	8.4
8-081-10	10.0	2.2	2.2	6.61	1.73	1.65	8.74	0.51	0.63	13.9
8-081-15	15.0	2.4	2.64	7.24	2.13	1.77	9.49	0.55	0.67	17.4

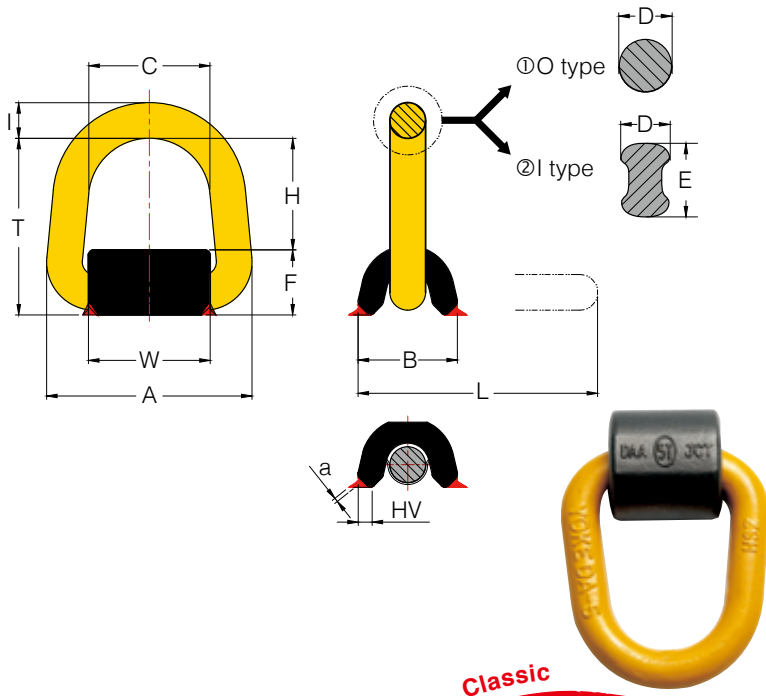

- Pivots through 180°.
- Manufactured from forged alloy steel, quenched and tempered.
- Manufactured and tested in accordance with EN1677-1.
- Load rated parts are 100% magnaflux crack detected.
- Individual forged parts are traceable to Test Certification.
- Proof tested to 2.5 times the WLL.
- Fatigue rated to 20,000 cycles at 1.5 times the WLL.
- All YOKE Lifting points meet or exceed all the requirements of ASME B30.26.
- WLL forged onto each product for quick and easy identification.
- Lugs designed to assist the welding process.
- Never apply load except in the same direction with the pivot direction.

Classic Weld-on Point

without Spring Designed

Metric (8-0573)& Imperial (8-0573)

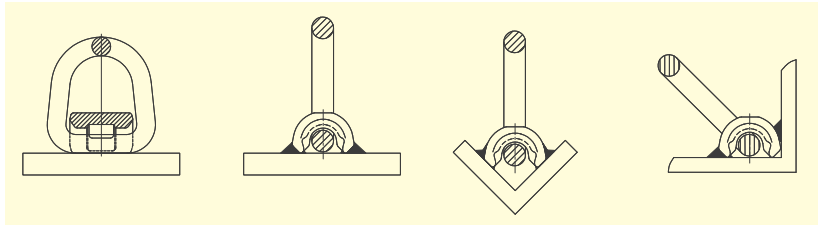

	Item No.	Working Load Limit tonnes*	Dimensions (mm)											N.W. kg		
			A	B	C	D	E	F	G	H	I	L	W		HV	a
①	8-0573-01	1.0	83	37	48	14	14	75	26	49	--	105	48	5	3	0.5
	8-0573-03	3.0	98	48	58	17	17	85	31	54	--	112	54	6	3	0.9
	8-0573-05	5.0	120	56	66	22	22	92	37	55	--	154	56	7	3	1.3
	8-0573-08	8.0	121	68	68	26	26	122	47	75	--	169	55	10	4	2.4
②	8-0573-10	10.0**	146	68	82	20	30	125	47	78	30	191	70	10	4	2.8
	8-0573-20	20.0**	186.5	93	100	25	37	180	70	110	37	234	91	20	4	6.5
	8-0573-30	30.0**	254.5	130	140	35	45	225	98	127	45	328	127	20	4	17.2

* Design factor 5:1

**Design factor 4:1

	Item No.	Working Load Limit tonnes*	Dimensions (inch)											N.W. lbs		
			A	B	C	D	E	F	G	H	I	L	W		HV	a
①	8-0573-01	1.0	3.27	1.46	1.89	0.55	0.55	2.95	1.02	1.93	--	4.13	1.89	0.2	0.12	1.1
	8-0573-03	3.0	3.86	1.89	2.28	0.67	0.67	3.35	1.22	2.13	--	4.41	2.13	0.24	0.12	2.0
	8-0573-05	5.0	4.72	2.20	2.60	0.87	0.87	3.62	1.46	2.17	--	6.06	2.20	0.25	0.12	2.9
	8-0573-08	8.0	4.76	2.68	2.68	1.02	1.02	4.80	1.85	2.95	--	6.65	2.17	0.39	0.16	5.3
②	8-0573-10	10.0**	5.75	2.68	3.23	0.79	1.18	4.92	1.85	3.07	1.18	7.52	2.76	0.39	0.16	6.2
	8-0573-20	20.0**	7.34	3.66	3.94	0.98	1.46	7.09	2.76	4.33	1.46	9.21	3.58	0.78	0.16	14.3
	8-0573-30	30.0**	10.02	5.12	5.51	1.38	1.77	8.86	3.86	5.00	1.77	12.91	5.00	0.78	0.16	37.8

* Design factor 5:1

**Design factor 4:1



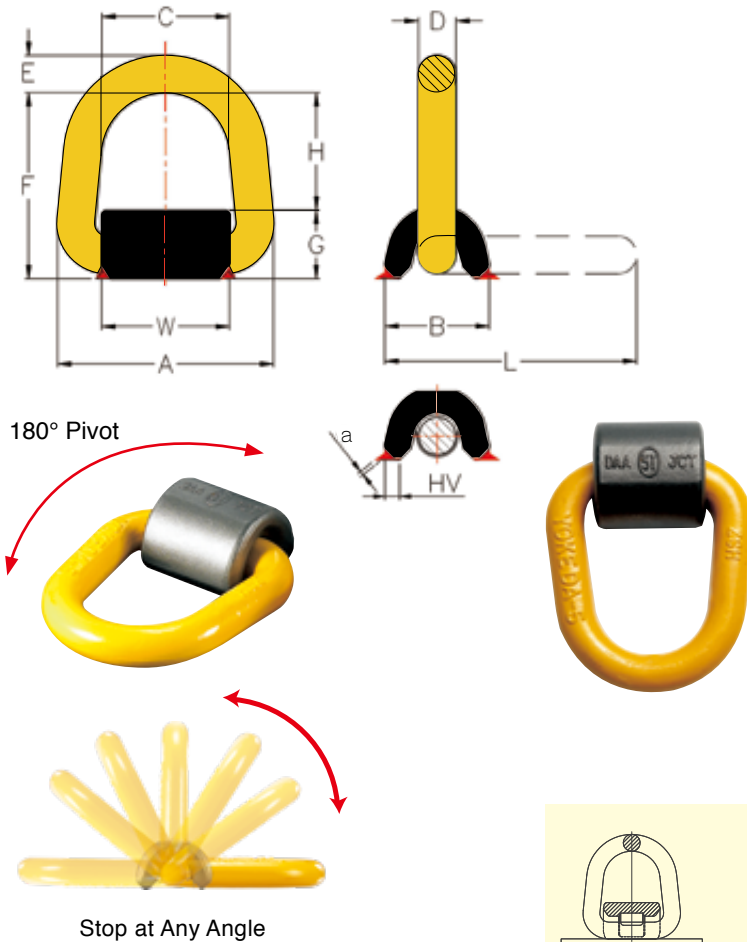

- Pivots through 180°.
- Manufactured from forged alloy steel, quenched and tempered.
- Manufactured and tested in accordance with EN1677-1.
- Load rated parts are 100% magnaflux crack detected.
- Individual forged parts are traceable to Test Certification.
- Proof tested to 2.5 times the WLL.
- Fatigue rated to 20,000 cycles at 1.5 times the WLL.
- All YOKE Lifting points meet or exceed all the requirements of ASME B30.26.
- WLL forged onto each product for quick and easy identification.
- Lugs designed to assist the welding process.
- A protected spring keeps the load ring in a required position. The parts are connected in such a way that they remain captive. The spring also reduces noise caused by vibrations.
- Never apply load except in the same direction with the pivot direction.

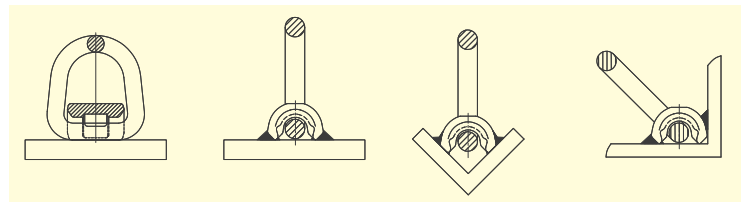

Weld-on Point

Designed with spring, stop at any angle
Metric (8-057)& Imperial (8-057)

Item No.	Working Load Limit	Dimensions (mm)												N.W.
		tonnes	A	B	C	D	E	F	G	H	L	W	HV	
8-057-1T	1.0	83	37	48	14	14	75	26	49	105	48	5	3	0.5
8-057-3T	3.0	98	48	58	17	17	85	31	54	112	54	6	3	0.9
8-057-5T	5.0	120	56	66	22	22	92	37	55	154	56	7	3	1.3
8-057-8T	8.0	121	68	68	26	26	122	47	75	169	55	10	4	2.6
8-057-10T	10.0	146	68	82	20	30	125	47	78	191	70	10	4	2.8

* Design factor 5:1

Item No.	Working Load Limit	Dimensions (inch)												N.W.
		tonnes	A	B	C	D	E	F	G	H	L	W	HV	
8-057-1T	1.0	3.27	1.46	1.89	0.55	0.55	2.95	1.02	1.93	4.13	1.89	0.2	0.12	1.1
8-057-3T	3.0	3.86	1.89	2.28	0.67	0.67	3.35	1.22	2.13	4.41	2.13	0.24	0.12	2.0
8-057-5T	5.0	4.72	2.20	2.60	0.87	0.87	3.62	1.46	2.17	6.06	2.20	0.25	0.12	2.9
8-057-8T	8.0	4.76	2.68	2.68	1.02	1.02	4.80	1.85	2.95	6.65	2.17	0.39	0.16	5.7
8-057-10T	10.0	5.75	2.68	3.23	0.79	1.18	4.92	1.85	3.07	7.52	2.76	0.39	0.16	6.2

* Design factor 5:1

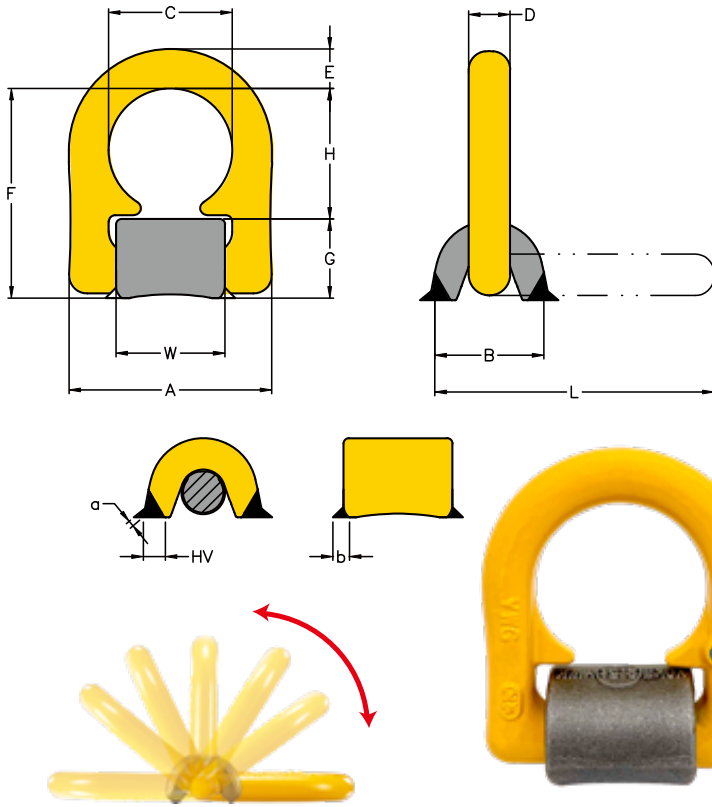

- Load ring pivots 180°.
- Full Loading Capacity in all directions.
- Manufactured from forged alloy steel, quenched and tempered.
- Tested in accordance with EN1677-1.
- 100% magnaflux crack detected.
- Parts individually forged with batch code to ensure full traceability.
- The permitted WLL forged onto each product for quick and easy identification.
- Lugs designed to assist the welding process.
- A protected spring keeps the loading ring in the required position. The parts are connected in such a way that they remain captive. The spring also reduces noise caused by vibrations.

Super Weld-on Point

Metric (8-0575)

Item No.	Working Load Limit tonnes*	Dimensions (mm)										N.W.			
		A	B	C	D	E	F	G	H	L	W	HV	a	b	kg
8-0575-015	1.5	64	31	38	13	13	63	24	39	84	32	5	3	3	0.32
8-0575-025	2.5	74	39	45	16	15	75	28	47	98	39	8	3	3	0.49
8-0575-040	4.0	84	40	51	16	17	81	29	52	108	45	9	3	3	0.67
8-0575-067	6.7	110	60	67	23	22	115	43	72	152	59	12	4	4	1.71
8-0575-100	10.0	122	72	67	27	22	124	51	73	165	59	17	5	7	2.45
8-0575-160	16.0	180	91	100	26	32	172	64	108	229	89	25	6	8	6.33

*Design factor 4:1

Super Weld-on Point

Imperial (8-0575)

Item No.	Working Load Limit lbs*	Dimensions (inch)										N.W.			
		A	B	C	D	E	F	G	H	L	W	HV	a	b	lbs
8-0575-015	3300	2.52	1.22	1.50	0.51	0.51	2.48	0.95	1.54	3.31	1.26	0.20	0.12	0.12	0.70
8-0575-025	5500	2.91	1.54	1.77	0.63	0.59	2.95	1.10	1.85	3.86	1.54	0.32	0.12	0.12	1.08
8-0575-040	8800	3.31	1.58	2.01	0.63	0.67	3.19	1.14	2.05	4.25	1.77	0.35	0.12	0.12	1.47
8-0575-067	14750	4.33	2.36	2.64	0.91	0.87	4.53	1.69	2.84	5.99	2.32	0.47	0.16	0.16	3.76
8-0575-100	22000	4.80	2.84	2.64	1.06	0.87	4.88	2.01	2.87	6.50	2.32	0.67	0.20	0.28	5.39
8-0575-160	35200	7.09	3.58	3.94	1.02	1.26	6.77	2.52	4.25	9.02	3.50	0.98	0.24	0.32	13.93

*Design factor 4:1



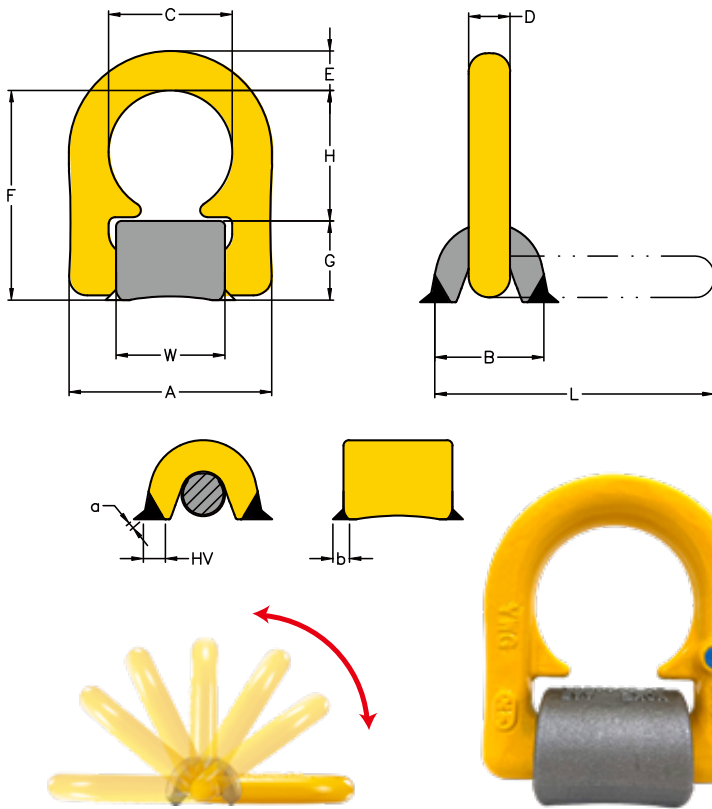

- Lashing ring pivots 180°
- Full Lashing Capacity in all directions.
- Manufactured from forged alloy steel, quenched and tempered.
- Tested in accordance with EN1677-1.
- 100% magnaflux crack detected.
- Parts individually forged with batch code to ensure full traceability.
- The permitted lashing capacity "LC" in daN forged onto each product for quick and easy identification.
- Lugs designed to assist the welding process.
- A protected spring keeps the lashing ring in the required position. The parts are connected in such a way that they remain captive. The spring also reduces noise caused by vibrations.

Lashing Weld-on Point

Metric (8-0576)

Item No.	Lashing Capacity	Dimensions (mm)										N.W.			
		daN	A	B	C	D	E	F	G	H	L	W	HV	a	b
8-0576-030	3000	64	31	38	13	13	63	24	39	84	32	5	3	3	0.32
8-0576-050	5000	74	39	45	16	15	75	28	47	98	39	8	3	3	0.49
8-0576-080	8000	84	40	51	16	17	81	29	52	108	45	9	3	3	0.67
8-0576-134	13400	110	60	67	23	22	115	43	72	152	59	12	4	4	1.71
8-0576-200	20000	122	72	67	27	22	124	51	73	165	59	17	5	7	2.45
8-0576-320	32000	180	91	100	26	32	172	64	108	229	89	25	6	8	6.33

*Design factor 2:1

Lashing Weld-on Point

Imperial (8-0576)

Item No.	Lashing Capacity	Dimensions (inch)										N.W.			
		lbs	A	B	C	D	E	F	G	H	L	W	HV	a	b
8-0576-030	6600	2.52	1.22	1.50	0.51	0.51	2.48	0.95	1.54	3.31	1.26	0.20	0.12	0.12	0.70
8-0576-050	11000	2.91	1.54	1.77	0.63	0.59	2.95	1.10	1.85	3.86	1.54	0.32	0.12	0.12	1.08
8-0576-080	17600	3.31	1.58	2.01	0.63	0.67	3.19	1.14	2.05	4.25	1.77	0.35	0.12	0.12	1.47
8-0576-134	29500	4.33	2.36	2.64	0.91	0.87	4.53	1.69	2.84	5.99	2.32	0.47	0.16	0.16	3.76
8-0576-200	44000	4.80	2.84	2.64	1.06	0.87	4.88	2.01	2.87	6.50	2.32	0.67	0.20	0.28	5.39
8-0576-320	70400	7.09	3.58	3.94	1.02	1.26	6.77	2.52	4.25	9.02	3.50	0.98	0.24	0.32	13.93

*Design factor 2:1

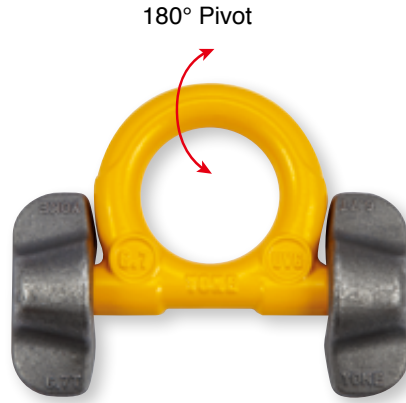
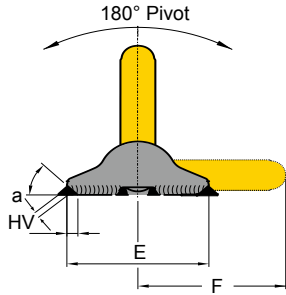
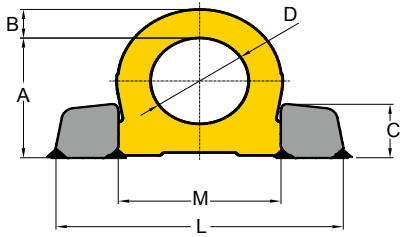

- Pivots 180°, designed minimizes head room.
- Manufactured from forged alloy steel, quenched and tempered.
- Manufactured and tested in accordance with EN1677-1.
- Certified by DGUV GS-OA-15-04.
- Load rated parts are 100% magnaflux crack detected.
- Individual forged parts are traceable to Test Certification.
- Proof tested to 2.5 times the WLL.
- Fatigue rated to 20,000 cycles at 1.5 times the WLL.
- The two points of attachment facilitate an even and optimal force distribution into the work piece and thus, usage of thinner base plates is possible.
- The welding block is forged out of material with excellent welding properties.
- Low profile design with high strength.
- The ring is stowable thus avoiding the hazards of tripping and snagging.



Weld-on Ring

Metric (8-082)

Item No.	Working Load Limit tonnes	Dimensions (mm)										N.W. kg
		A	B	C	D	E	F	L	M	HV	a	
8-082-04	4	66	14	30	48	65	70	135	76	5	3	0.6
8-082-06	6.7	85	20	39	60	89	91	171	98	5	3	1.5
8-082-10	10	95	21	46	65	100	100	196	106	7	4	2.4
8-082-16	16	127	30	57	90	130	136	263	149	8	4	5.5
8-082-30	31.5	178	42	78	130	160	160	375	213	15	4	15.8

* Design factor 4:1

Weld-on Ring

Imperial (8-082)

Item No.	Working Load Limit tonnes	Dimensions (inch)										N.W. lbs
		A	B	C	D	E	F	L	M	HV	a	
8-082-04	4	2.6	0.55	1.18	1.89	2.56	2.76	5.31	2.99	0.2	0.1	1.3
8-082-06	6.7	3.35	0.79	1.54	2.36	3.5	3.58	6.73	3.86	0.2	0.1	3.3
8-082-10	10	3.74	0.83	1.81	2.56	3.94	3.94	7.72	4.17	0.28	0.2	5.3
8-082-16	16	5	1.18	2.24	3.54	5.12	5.35	10.35	5.87	0.31	0.2	12.1
8-082-30	31.5	7.01	1.65	3.07	5.12	6.3	7.68	14.76	8.39	0.59	0.2	34.8

* Design factor 4:1

INDEX

By Item. Number		
Item No.		Page
8-057	Weld-on Point	61
8-0573	Classic Weld-on Point	60
8-0575	Super Weld-on Point	62
8-0576	Lashing Weld-on Point	63
8-058	Bolt-on Tie Down	54
8-081	Weld-on Hook	59
8-082	Weld-on Ring	64
8-083	Excavator Hook	58
8-203	Hoist Ring	46
8-204	Hoist Ring	48
8-211	Lifting Point	12
8-211	Lifting Point Long Bolt	16
8-212	Lifting Point	14
8-231	Anchor Point	18
8-231	Anchor Point Long Bolt	22
8-232	Anchor Point	20
8-251	Super Point	34
8-252	Super Point	36
8-271	Swivel Point	38
8-272	Swivel Point	40
8-281	PSA-YEP	52
8-285	PSA-INOX-YEP	53
8-291K	Key Eye Point	24
8-292K	Key Eye Point	26
8-S291	Stainless Steel Eye Point	28
8-S292	Stainless Steel Eye Point	30
DA-271	DA Swivel Point	42
DA-272	DA Swivel Point	44
8-2511	Hook Point	42
8-2521	Hook Point	44

By Product Name		
Product No.		Page
Anchor Point		18
Anchor Point		20
Anchor Point Long Bolt		22
Bolt-on Tie Down		54
DA Swivel Point		42
DA Swivel Point		44
Excavator Hook		58
Hoist Ring		46
Hoist Ring		48
Hook Point		42
Hook Point		44
Key Eye Point		24
Key Eye Point		26
Lifting Point		12
Lifting Point		14
Lifting Point Long Bolt		16
PSA-INOX-YEP		53
PSA-YEP		52
Stainless Steel Eye Point		28
Stainless Steel Eye Point		30
Super Point		34
Super Point		36
Swivel Point		38
Swivel Point		40
Weld-on Hook		59
Classic Weld-on Point		60
Weld-on Point		61
Super Weld-on Point		62
Lashing Weld-on Point		63
Weld-on Ring		64



Safety is our first priority™

An ISO 9001 Registered Company



YOKE INDUSTRIAL CORP.

#39, 33rd Road,

Taichung Industrial Park,

Taichung 407,

TAIWAN

Tel:+886-4-2350-8088

Fax:+886-4-2350-1001

E-mail: info@mail.yoke.net

www.yoke.net